

EXHIBIT "A"

LEGAL DESCRIPTION

ESCROW NO.: 040800100

Lot 15, in Block A, as set forth on the Official plat of DRY CREEK ESTATES PUD #99-10, filed in the Office of the Douglas County Recorder on October 19, 2001, in Book 1001, Page 6820, as Document No. 525771, Official Records.

APN 1221-19-001-026

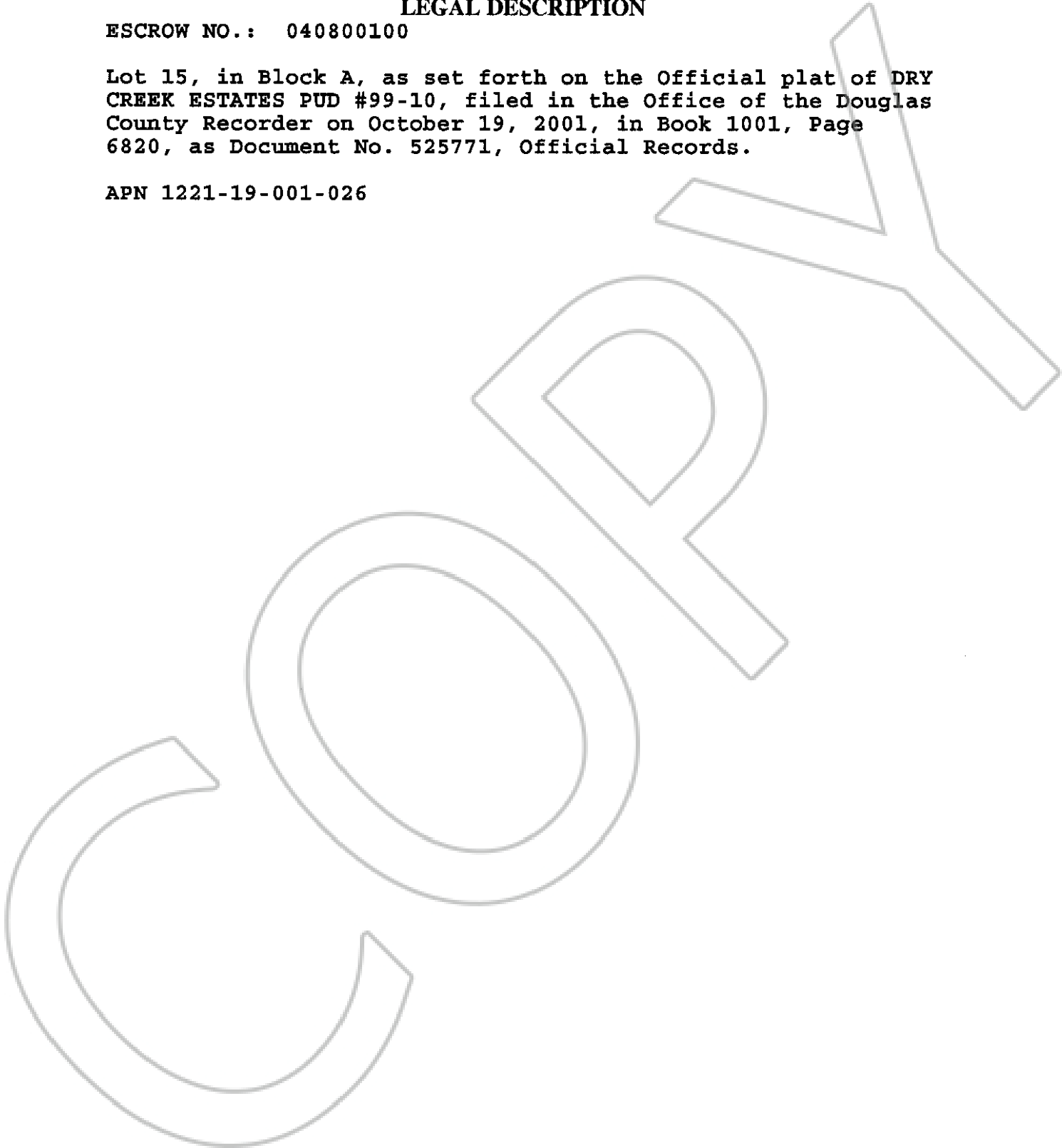

0606058

BK0304PG00534