

A.P.N. # 1320-33-816-063

R.P.T.T. \$ 1,197.30

ESCROW NO. 030303331

RECORDING REQUESTED BY:
STEWART TITLE COMPANY
MAIL TAX STATEMENTS TO:
SAME AS BELOW

WHEN RECORDED MAIL TO:
MR. & MRS. VOORHEES
3735 LINCOLNWOOD DRIVE
SANTA BARBARA, CA 93110-2504

REQUESTED BY
Stewart Title of Douglas County
IN OFFICIAL RECORDS OF
DOUGLAS CO., NEVADA

2004 MAR -5 PM 3:34

WERNER CHRISTEN
RECORDER

\$ 15⁰⁰ PAID BC DEPUTY

(Space above for Recorder's Use Only)

**CORPORATION
GRANT, BARGAIN, SALE DEED**

THIS INDENTURE WITNESSETH: That
WEST RIDGE HOMES, INC., a Nevada corporation

in consideration of \$10.00, the receipt of which is hereby acknowledged, does hereby Grant, Bargain Sell and Convey to
ROBERT G. VOORHEES, JR. and DIANNE B. VOORHEES, trustees of the VOORHEES FAMILY TRUST, dated January 18, 1999
and to the heirs and assigns of such Grantee forever, all that real property situated in the
County of **DOUGLAS** State of Nevada,
bounded and described as follows:

SEE EXHIBIT "A" ATTACHED HERETO AND MADE A PART HEREOF

Together with all and singular the tenements, hereditaments and appurtenances thereunto belonging or in anywise appertaining, and any reversions, remainders, rents, issues or profits thereof.

DATE: **February 18, 2004**

**WEST RIDGE HOMES, INC.
A NEVADA CORPORATION**

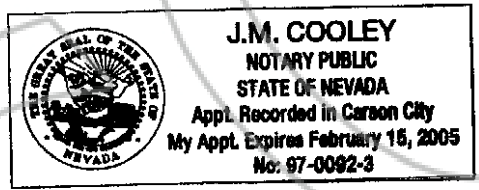

BY: *Peter M. Beekhof, Jr.*
**PETER M. BEEKHOF, JR.
PRESIDENT**

BY: _____

STATE OF Nevada }
COUNTY OF DOUGLAS } ss.

This instrument was acknowledged before me on 3-2-04
by PETER M. BEEKHOF, JR.

Signature *J.M. Cooley*
Notary Public (One Inch Margin on all sides of Document for Recorder's Use Only)

0606527
BK 0304 PG 03023

EXHIBIT "A"

LEGAL DESCRIPTION

ESCROW NO.: 030303331

Lot 20, Block B, as set forth on FINAL SUBDIVISION MAP No. 1006-11 for CHICHESTER ESTATES, PHASE 11, filed in the office of the County Recorder of Douglas County, Nevada and recorded December 27, 2002 in Book 1202, Page 12732, as Document No. 562225, and by Certificate of Amendment recorded March 27, 2003 in Book 0303, Page 13037, as Document No. 0571430.

Assessors Parcel Number 1320-33-816-063

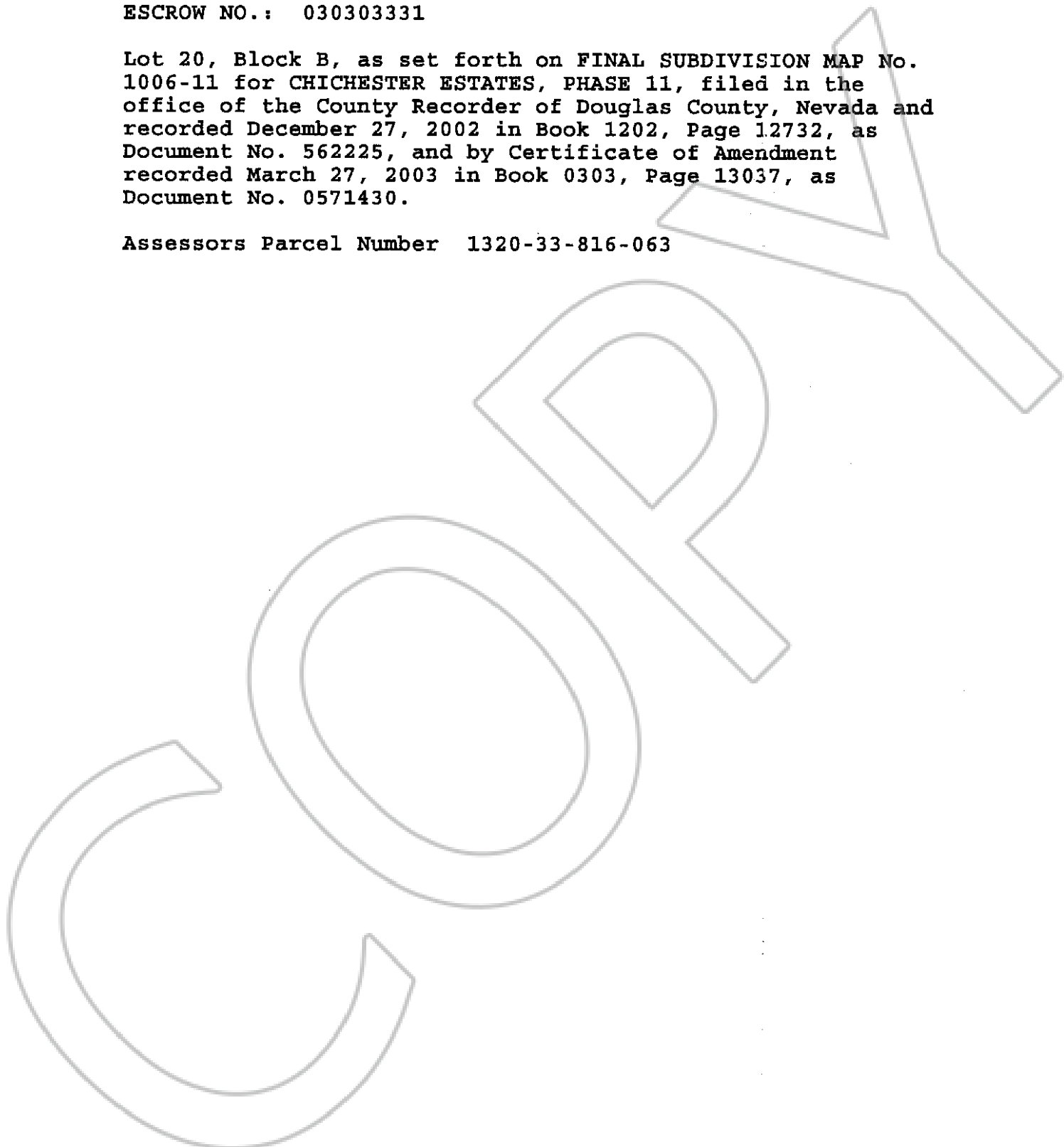

0606527

BK0304PG03024