

18 -

APN# 1220-16-210-166

**Recording Requested By:**  
WHEN RECORDED MAIL TO:

✓ **Name** First American Title  
**Address:** 3355 Michelson Way, Suite 250  
**City/State/Zip** Irvine, Ca 92612  
**ATTN:** JOANNE BUI  
**ORDER#** 1825019

REQUESTED BY  
1st American Title  
IN OFFICIAL RECORDS OF  
DOUGLAS CO., NEVADA

2004 MAR -9 AM 11:42

WERNER CHRISTEN  
RECORDER

18<sup>00</sup> PAID K2 DEPUTY

ASSIGNMENT OF DEED OF TRUST

(Title of Document)



**This page added to provide additional information required by NRS 111.312 Sections 1-2.  
(Additional recording fee applies)**

**This cover page must be typed or printed.**

0606756

BK 0304 PG 04203

PREPARED BY  
LITTON LOAN SERVICING LP  
4828 LOOP CENTRAL DRIVE  
HOUSTON, TX 77081-2226

8733131

Mail Tax Statements To:  
NEW CENTURY MORTGAGE CORPORATION  
18400 VON KARMAN, SUITE 1000  
IRVINE, CA 92612

When Recorded Mail to:  
First American Title Insurance  
3355 Michelson Way, Suite 250  
Irvine, CA 92612  
Attn: Carmelina Lara

TAX ID # 1220-16-210-166

1825019

Recording Requested By/Return To: NEW CENTURY MORTGAGE CORPORATION  
18400 VON KARMAN, SUITE 1000  
IRVINE, CALIFORNIA 92612

2003-CB4

### ASSIGNMENT OF DEED OF TRUST

For Value Received, the undersigned holder of a Deed of Trust (herein "Assignor") whose address is  
18400 VON KARMAN, SUITE 1000, IRVINE, CA 92612

does hereby grant, sell, assign, transfer and convey, unto

**JPMorgan Chase Bank, as Trustee**

a corporation organized and existing under the laws of  
whose address is **450 West 33rd Street, New York, NY 10001**

(herein "Assignee"),

all beneficial interest under a certain Deed of Trust, dated **April 24, 2003**, made and executed by  
**ERIC C HANSEN AND SAUNDRA HANSEN, HUSBAND AND WIFE, AS JOINT TENANTS**

prop. add: 1244 Monarch Lane  
GARDNERVILLE, NV. 89460

to **FIRST CENTENNIAL TITLE**

Trustee, and given  
to secure payment of **One Hundred Fifty-Six Thousand, Four Hundred and No/100 ---**  
(\$ **156,400.00** )

**RECORDED: 4/30/03** (Include the Original Principal Amount)  
which Deed of Trust is of record in Book, Volume, or Liber No. **0403**, at page **15413**  
(or as No. **0575096** ) of the **DOUGLAS** Records of **DOUGLAS**  
County, State of Nevada, together with the note(s) and obligations therein described, the money due and to  
become due thereon with interest, and all rights accrued or to accrue under such Deed of Trust.

TO HAVE AND TO HOLD, the same unto Assignee, its successor and assigns, forever, subject only to  
the terms and conditions of the above-described Deed of Trust.

**"Legal Description Attached"**

**Nevada Assignment of Deed of Trust with Acknowledgment**

Page 1 of 2

 -995W(NV) (0106)

VMP MORTGAGE FORMS - (800)521-7291

6/01

Assignee: JPMorgan Chase Bank, as trustee under the pooling and  
servicing agreement dated as of August 1, 2003, among Credit-Based  
Asset Servicing and Securitization LLC, Asset Backed Funding Corporation, Lika  
Loan Servicing LP and JPMorgan Chase Bank, C-BASS Mortgage Loan  
Asset-Backed Certificates, Series 2003-CB4, without recourse



0606756

BK0304 PG04204

IN WITNESS WHEREOF, the undersigned Assignor has executed this Assignment of Deed of Trust on

5.5.03

Manuel Villarreal  
Witness Manuel Villarreal

NEW CENTURY MORTGAGE CORPORATION  
(Assignor)

Witness

By: [Signature]  
(Signature)

A.V.P. \Shipping Manager  
Magda Villanueva

Attest

Seal:

**SEAL**

This Instrument Prepared By: **NEW CENTURY MORTGAGE CORPORATION** Address: **18400 VON KARMAN, SUITE 1000, IRVINE, CA 92612**, tel. no.: **1(800)967-7623**

State of **CALIFORNIA**  
County of **ORANGE**

This instrument was acknowledged before me on **May 5, 2003**  
by **Magda Villanueva**

as **A.V.P. \Shipping Manager**

of

Marisa G Carrasco

 -995W(NV) (0108)

Page 2 of 2

0606756

BK0304PG04205

**CALIFORNIA ALL-PURPOSE  
ACKNOWLEDGEMENT**

STATE OF CALIFORNIA  
COUNTY OF ORANGE

On **May 5, 2003** before me the undersigned **Marisa G. Carrasco**,  
A Notary Public in and for Orange County and the State of California,  
personally appeared **Magda Villanueva, A.V.P./ Shipping Manager of  
New Century Mortgage Corporation**, who proved to me on the basis of  
satisfactory evidence to be the persons whose names are subscribed to the  
within instrument and acknowledged to me that their authorized capacities,  
and that by their signatures on the instrument the persons, or the entity upon  
behalf of which the persons acted, executed the instrument.

Witness my hand and official seal

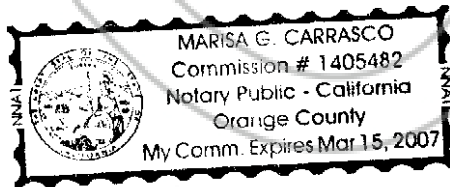

*Marisa G. Carrasco*  
**Marisa G. Carrasco**  
Signature of Notary Public

**Marisa G. Carrasco**  
**COMMISSION # 1405482**  
**COMMISSION EXPIRES:**  
**March 15, 2007**

0606756

BK0304PG04206

**EXHIBIT "A"**  
**Legal Description**

All that certain real property situate in the City of Gardnerville, County of Douglas, State of NEVADA, described as follows:

Lot 3, in Block F, of the AMENDED MAP OF RANCHOS ESTATES, according to the map thereof, filed in the office of the County Recorder of Douglas County, Nevada, on October 30, 1972 in Book 1072, page 642, as Document No. 62493.

APN: 1220-16-210-166

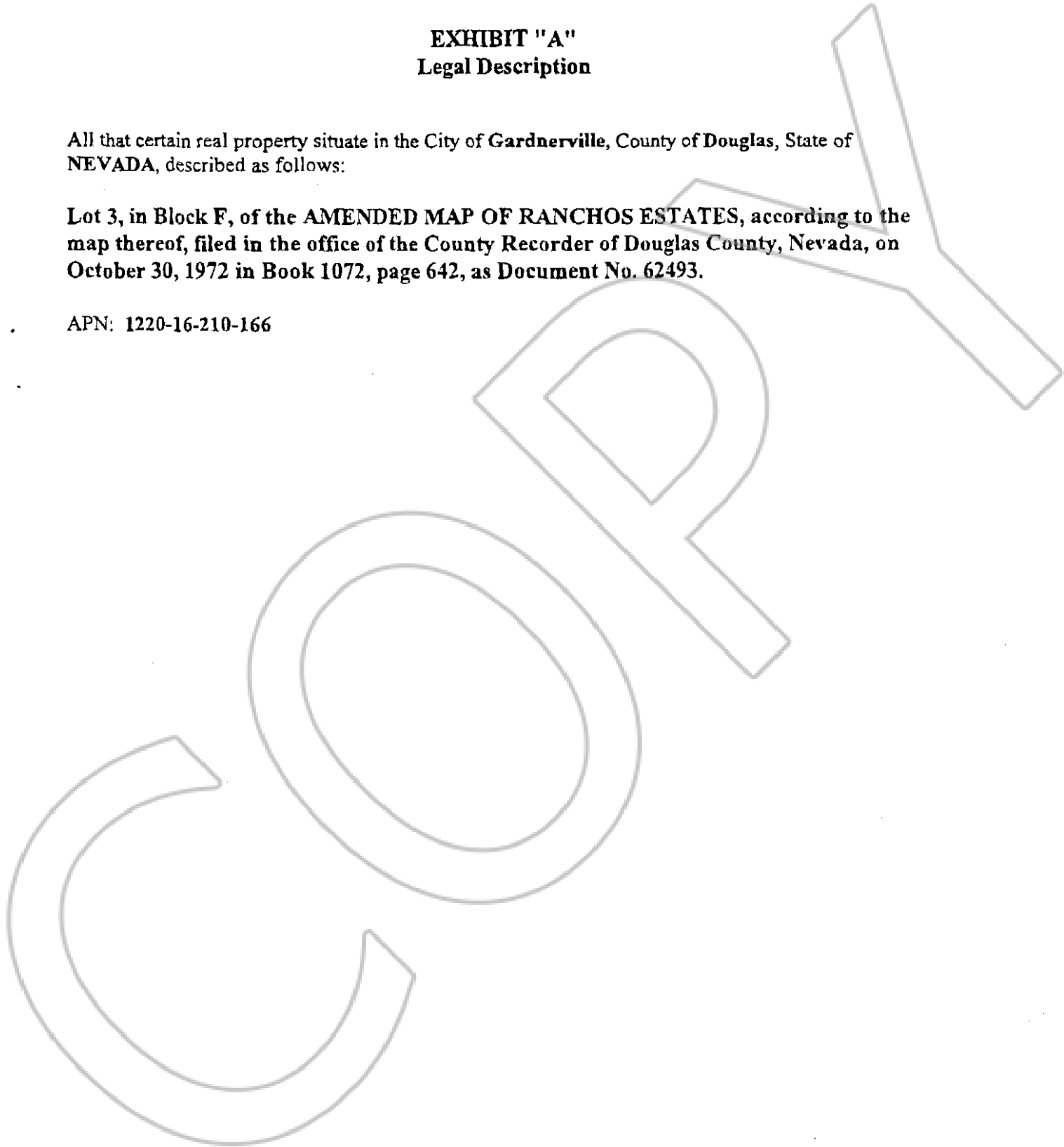

0606756  
BK0304PG04207