

A.P.N. # 1320-29-211-006

R.P.T.T. \$ 0 #5
ESCROW NO. 040800494

RECORDING REQUESTED BY:
STEWART TITLE COMPANY
MAIL TAX STATEMENTS TO:
SAME AS BELOW

WHEN RECORDED MAIL TO:
VAN WINKLE
P.O. BOX 2917
MINDEN, NV 89423

REQUESTED BY
Stewart Title of Douglas County
IN OFFICIAL RECORDS OF
DOUGLAS CO. NEVADA

2004 MAR -9 PM 4: 02

WERNER CHRISTEN
RECORDER

\$ 15.00 PAID BY BK DEPUTY

(Space Above for Recorder's Use Only)

GRANT, BARGAIN, SALE DEED

THIS INDENTURE WITNESSETH: That **RAYMOND W. VAN WINKLE, JR.**

in consideration of \$10.00, the receipt of which is hereby acknowledged, does hereby Grant, Bargain Sell and Convey to **RAYMOND W. VAN WINKLE JR and TONI VAN WINKLE,**
Husband and Wife as Joint Tenants

and to the heirs and assigns of such Grantee forever, all that real property situated in the
County of **DOUGLAS** State of Nevada, bounded and described as :

SEE EXHIBIT "A" ATTACHED HERETO AND MADE A PART HEREOF

IT IS THE EXPRESS INTENT OF THE GRANTOR, BEING THE SPOUSE OF THE GRANTEE, TO CONVEY ALL RIGHT, TITLE AND INTEREST OF THE GRANTOR, COMMUNITY OR OTHERWISE, IN AND TO THE HEREIN DESCRIBED PROPERTY TO THE GRANTEE AS GRANTEE'S SOLE AND SEPARATE PROPERTY.

Together with all and singular the tenements, hereditaments and appurtenances thereunto belonging or in anyway appertaining, and any reversions, remainders, rents, issues or profits thereof.

DATE: **March 03, 2004**

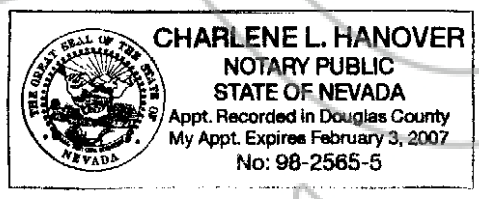

Raymond W. Van Winkle, Jr.
RAYMOND W. VAN WINKLE, JR

STATE OF Nevada }
 } ss.
COUNTY OF DOUGLAS }

This instrument was acknowledged before me on 3/5/2004
by, RAYMOND W. VAN WINKLE, JR

Signature Charlene L. Hanover
Notary Public (One Inch Margin on all sides of Document for Recorder's Use Only)

0606794

BK0304PG04401

EXHIBIT "A"

LEGAL DESCRIPTION

ESCROW NO.: 040800494

**The land referred to herein is situated in the
State of Nevada, County of DOUGLAS
City of MINDEN described as follows:**

**Lot 240 as shown on the official plat of WINHAVEN, UNIT NO.
6, filed for record in the office of the County Recorder of
Douglas County, Nevada on August 4, 1994, in Book 894 of
Official Records at page 692, as Document No. 343273.**

Assessor's Parcel No. 1320-29-211-006

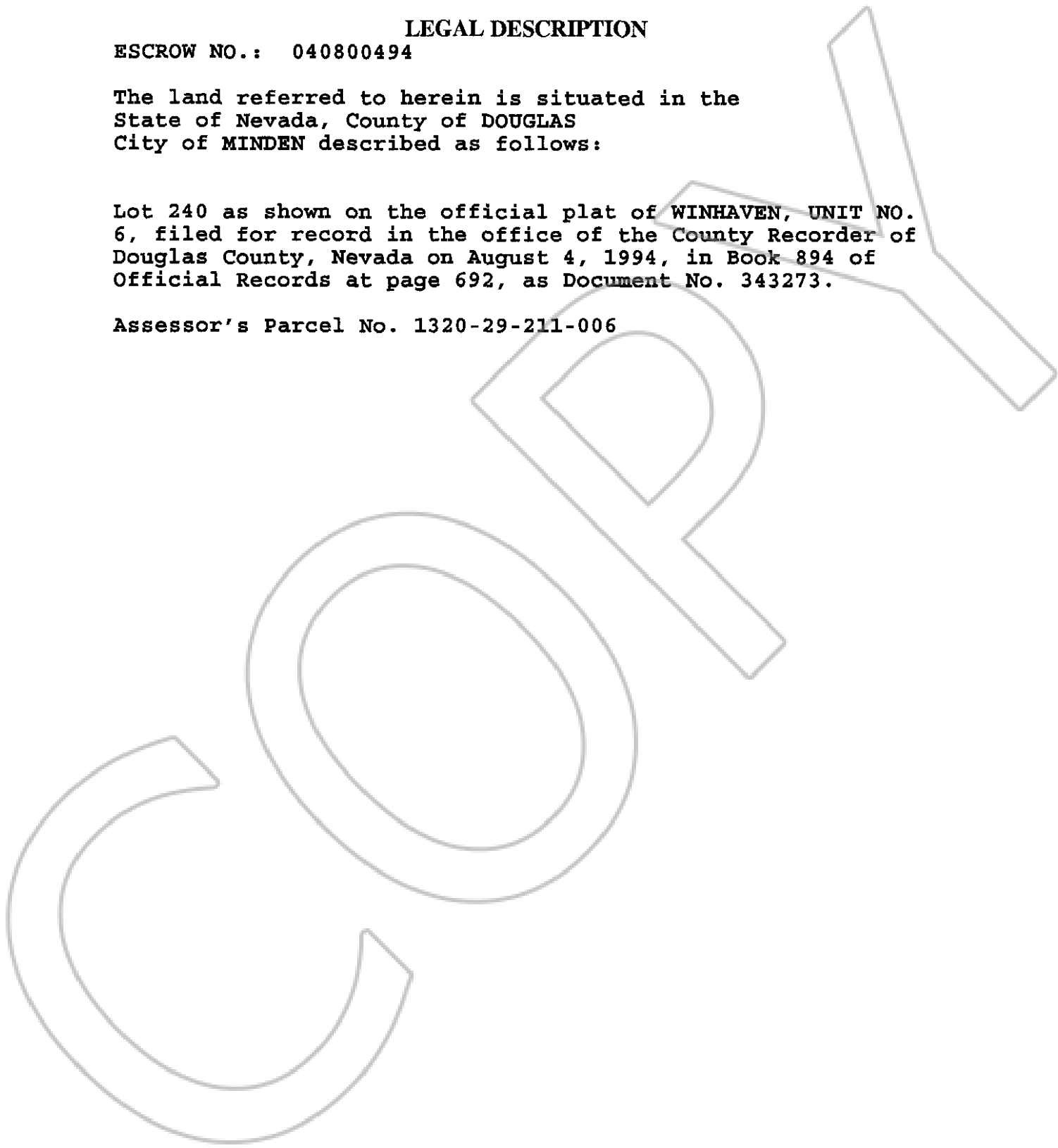

0606794

BK0304PG04402