

A.P.N. # 1022-10-002-038

R.P.T.T. \$ 273.00

ESCROW NO. 040100376

RECORDING REQUESTED BY:  
**STEWART TITLE COMPANY**  
MAIL TAX STATEMENTS TO:  
**SAME AS BELOW**

WHEN RECORDED MAIL TO:  
**GRANTEE**  
**1512 N. HWY 395, SUITE 6**  
**GARDNERVILLE, NV 89410**

REQUESTED BY  
**Stewart Title of Douglas County**

IN OFFICIAL RECORDS OF  
DOUGLAS CO. NEVADA

2004 MAR 11 PM 3:57

WERNER CHRISTEN  
RECORDER

\$ 15<sup>00</sup> PAID PC DEPUTY

(Space Above for Recorder's Use Only)

### GRANT, BARGAIN, SALE DEED

THIS INDENTURE WITNESSETH: That **E. ANN MARIAN<sup>2</sup>**, Surviving joint tenant

in consideration of \$10.00, the receipt of which is hereby acknowledged, does hereby Grant, Bargain Sell and Convey to **LESTER D. WALKLEY, an unmarried man and SHERYL L. RADCLIFF-NEGRETE, an unmarried woman, as joint tenants**

and to the heirs and assigns of such Grantee forever, all that real property situated in the County of **Douglas** State of Nevada, bounded and described as:

**SEE EXHIBIT "A" ATTACHED HERETO AND MADE A PART HEREOF**

Together with all and singular the tenements, hereditaments and appurtenances thereunto belonging or in anywise appertaining, and any reversions, remainders, rents, issues or profits thereof.

DATE: **March 02, 2004**

*E Ann Marian*  
**E. ANN MARIAN**

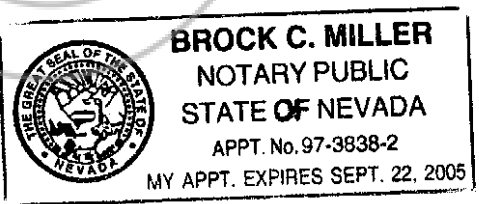

STATE OF Nevada }  
  } ss.  
COUNTY OF Washoe }

This instrument was acknowledged before me on March 9, 2004  
by **E. ANN MARIAN**

Signature *BC*

Notary Public (One inch margin on all sides of document for Recorder's Use Only)

0607004

BK0304PG05530

**EXHIBIT "A"**

**LEGAL DESCRIPTION**

ESCROW NO.: 040100376

The land referred to herein is situated in the  
State of Nevada, County of Douglas  
City of WELLINGTON described as follows:

Lot 112, as shown on the map of TOPAZ RANCH ESTATES UNIT  
NO. 2, filed in the Office of the County Recorder of  
Douglas County, Nevada, on February 20, 1967, as Document  
No. 35464.

Assessor's Parcel No. 1022-10-002-038

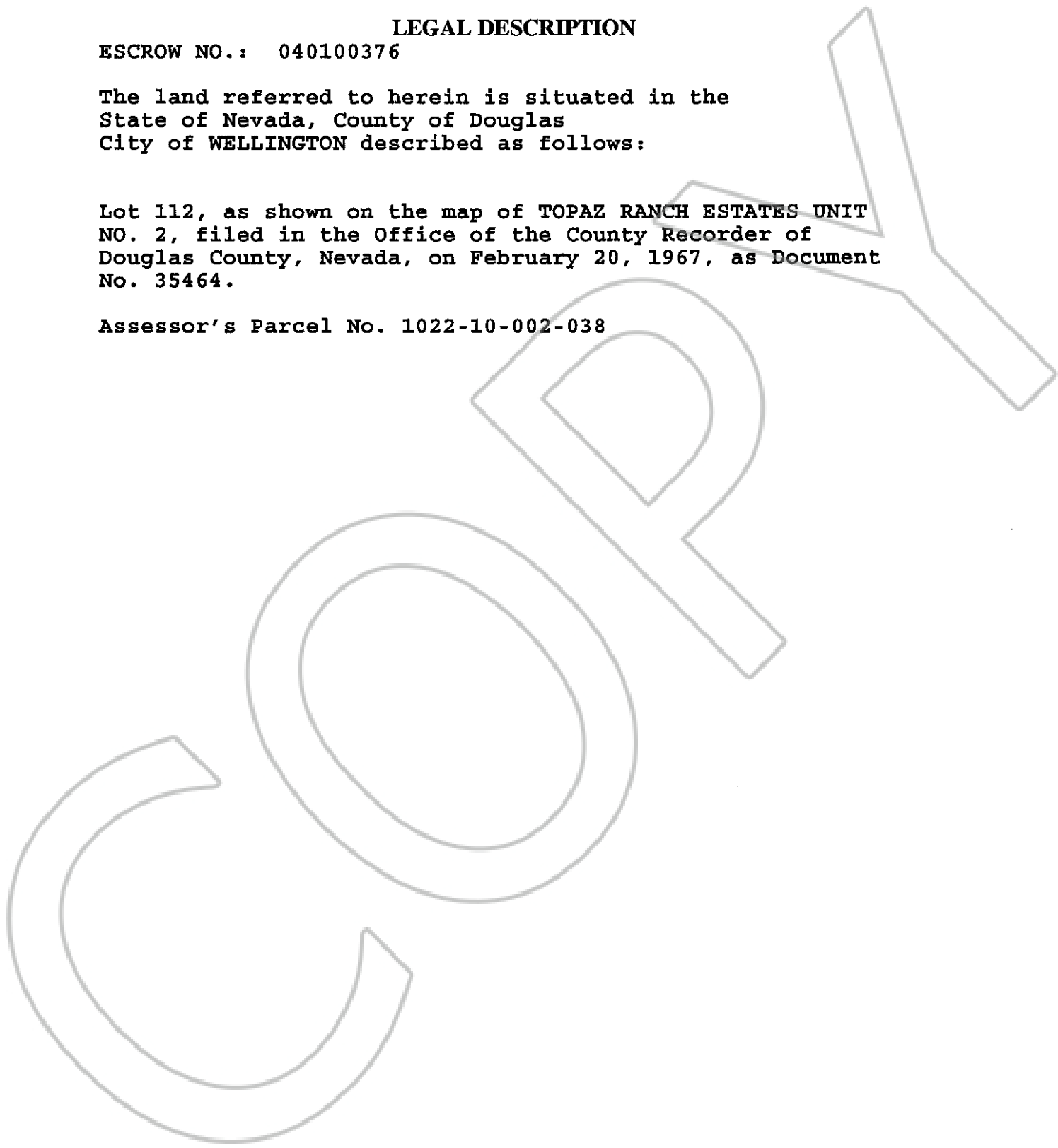

0607004

BK0304 PG05531