

A.P.N. # 1320-33-716-012

R.P.T.T. \$ 682.50
ESCROW NO. ACCM1705

RECORDING REQUESTED BY:
STEWART TITLE COMPANY
MAIL TAX STATEMENTS TO:
SAME AS BELOW

WHEN RECORDED MAIL TO:
LEO A. HANLY
2221 MERIDIAN BLVD., STE. A
MINDEN, NV 89423

REQUESTED BY
Stewart Title of Douglas County

IN OFFICIAL RECORDS OF
DOUGLAS CO., NEVADA

2004 MAR 12 PM 3:28

WERNER CHRISTEN
RECORDER

\$15 PAID KJ DEPUTY

(Space above for Recorder's Use Only)

CORPORATION
GRANT, BARGAIN, SALE DEED

THIS INDENTURE WITNESSETH: That
SYNCON HOMES, A NEVADA CORPORATION

in consideration of \$10.00, the receipt of which is hereby acknowledged, does hereby Grant, Bargain Sell
and Convey to
LEO A. HANLY, a married man as his sole and separate
property

and to the heirs and assigns of such Grantee forever, all that real property situated in the
County of **DOUGLAS** State of Nevada,
bounded and described as follows:

SEE EXHIBIT "A" ATTACHED HERETO AND MADE A PART HEREOF

Together with all and singular the tenements, hereditaments and appurtenances thereunto belonging or in
anywise appertaining, and any reversions, remainders, rents, issues or profits thereof.

DATE: **March 04, 2004**

SYNCON HOMES
A NEVADA CORPORATION

BY: *Andrew W. Mitchell Pres*
ANDREW W. MITCHELL
PRESIDENT

BY: _____

STATE OF Nevada }
 } ss.
COUNTY OF DOUGLAS }

This instrument was acknowledged before me on 3/4/04
by ANDREW W. MITCHELL

Signature *Judith A Lyons*
Notary Public (One Inch Margin on all sides of Document for Recorder's Use Only)

0607102
BK 0304 PG 05947

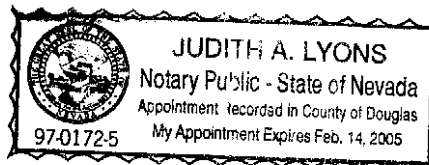

EXHIBIT "A"

LEGAL DESCRIPTION

ESCROW NO.: ACCM1705

**The land referred to herein is situated in the
State of Nevada, County of DOUGLAS
City of GARDNERVILLE described as follows:**

**Lot 12, Block A, as set forth on FINAL SUBDIVISION MAP No.
1006-8 for CHICHESTER ESTATES, PHASE 8, filed in the office of
the County Recorder of Douglas County, Nevada and recorded June
12, 2001 in Book 0601, Page 2589, as Document No. 516199.**

Assessors Parcel No. 1320-33-716-012

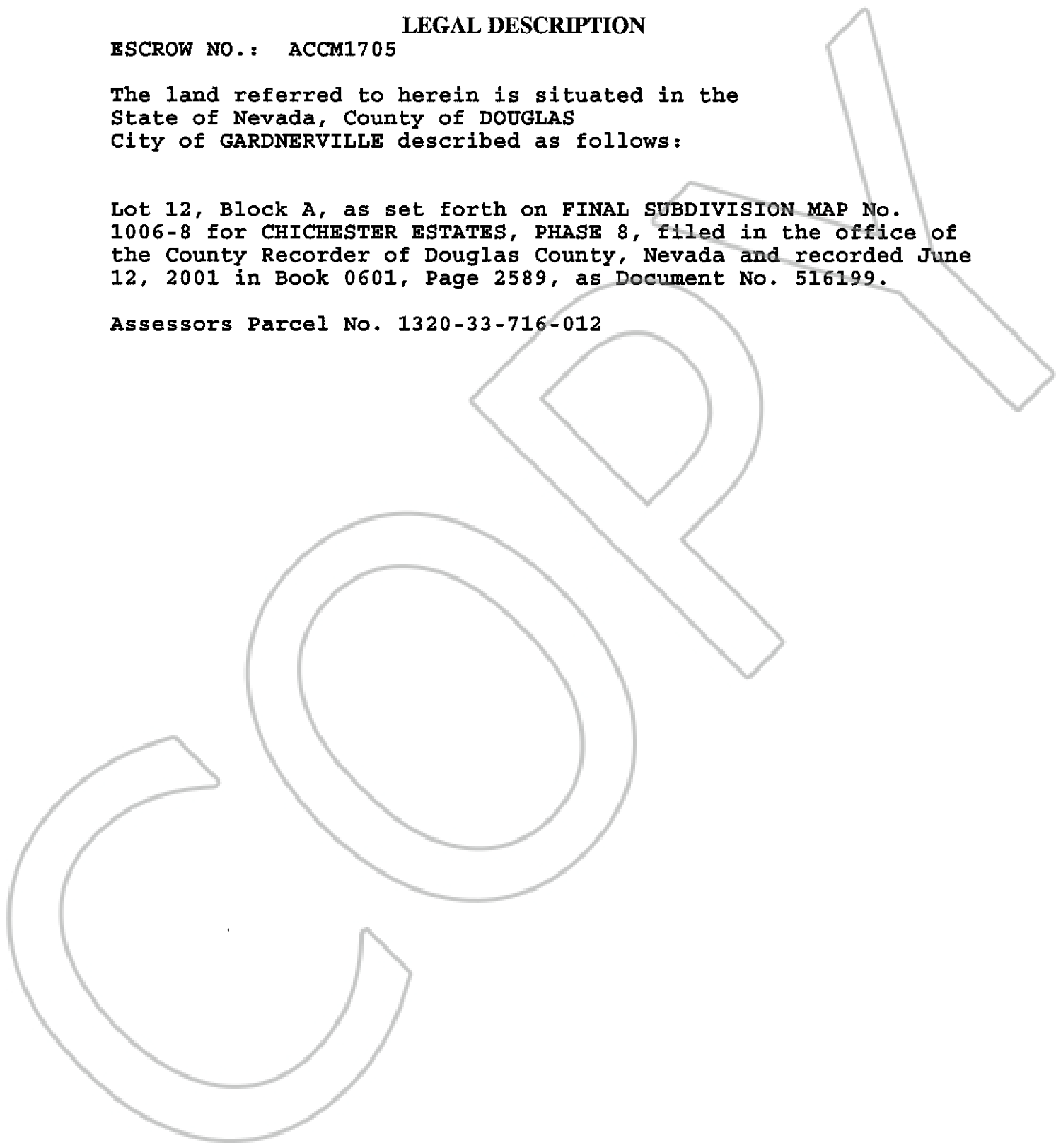

0607102

BK0304PG05948