

APN: 1320-33-816-021

2004 MAR 17 PM 3: 29

RECORDING REQUESTED BY:  
Western Title Company, Inc.

WERNER CHRISTEN  
RECORDER

WHEN RECORDED MAIL TO:

SLG PAID. *KJ* DEPUTY

Name CLASSIC HOMES LLC  
Street 1508 EUREKA BLVD #130  
Address  
City, State ROSEVILLE, CA 95661  
Zip

Order No. 00088963-201- SLG

(SPACE ABOVE THIS LINE FOR RECORDERS USE)

### NOTICE OF COMPLETION

TO WHOM IT MAY CONCERN:

NOTICE IS HEREBY GIVEN:

1. That work has been completed in all respects on the following property:

See Exhibit A attached hereto and made a part hereof.

2. That said work was started on or about 9/2/03 and was fully and actually completed on 3/9/04 .

3. That the contractor commencing and completing said work was DARR CONSTRUCTION.

4. That CLASSIC HOMES LLC is the owner of said property, located at 1415 SOUTH MARION RUSSEL COURT, GARDNERVILLE, NV 89410.

That said property is owned in fee simple title, and that no other person or persons whomsoever is the owner of, or interested therein.

This Notice of Completion is given in compliance with the provisions of Section 108.228 of Nevada Revised Statutes, and the above facts are true and correct.

0607443

BK0304 PG07977



Exhibit A

All that real property situate in the County of Douglas, State of Nevada, described as follows:

Lot 62, in Block C, as shown on the Final Subdivision Map # 1006-6-11 of **CHICHESTER ESTATES PHASE 11**, filed for record in the office of the County Recorder of Douglas County, State of Nevada, on December 27, 2002, in Book 1202, Page 12732, as Document No. 562225, and amended by Certificate of Amendment, recorded March 27, 2003, in Book 0303, Page 13037, as Document No. 0571430, Official Records of Douglas County, State of Nevada.

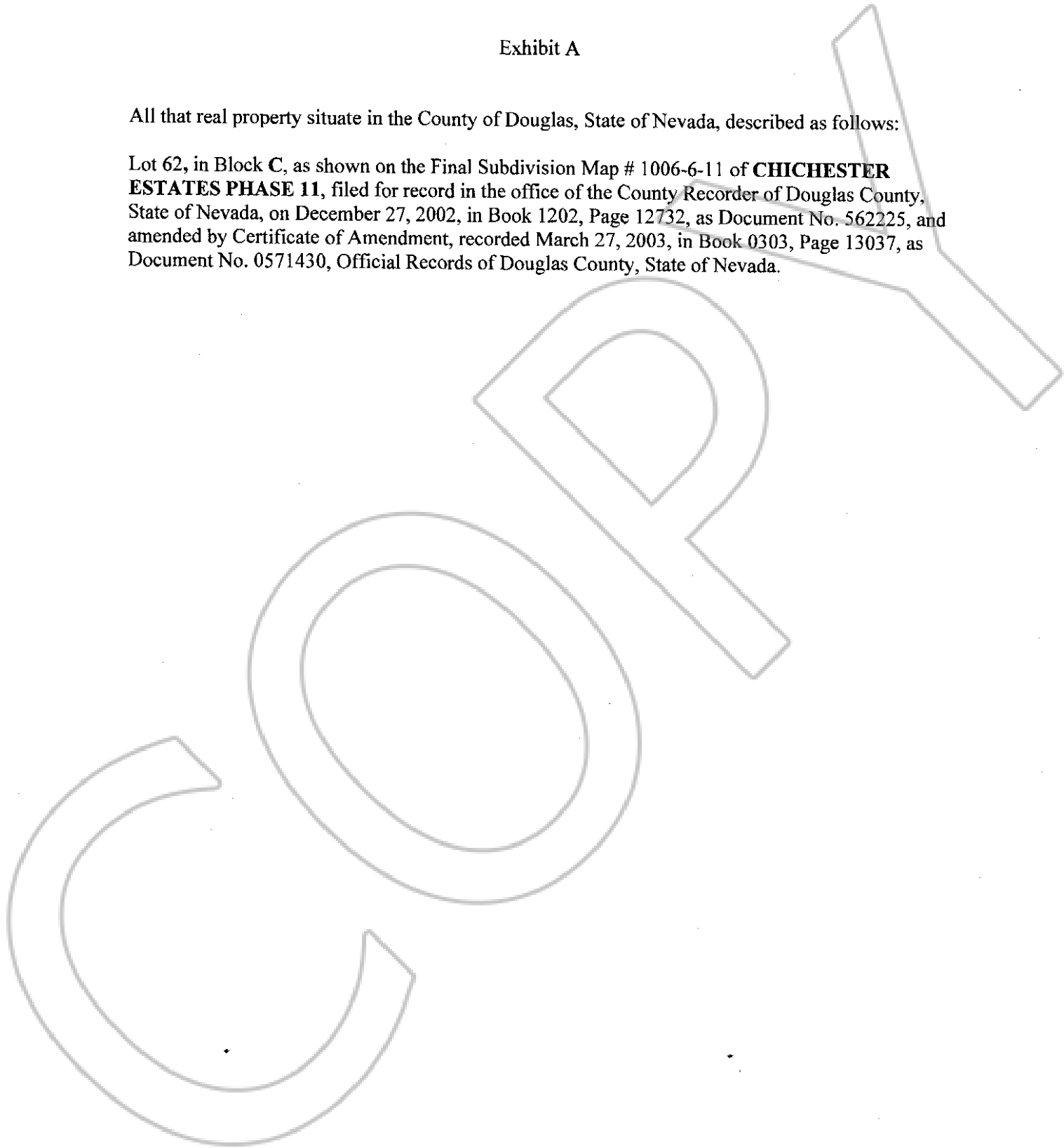

0607443

BK0304PG07979