

A.P.N. # 1420-33-312-049

R.P.T.T. \$ 1267.50

ESCROW NO. 040700537

RECORDING REQUESTED BY:

STEWART TITLE COMPANY

MAIL TAX STATEMENTS TO:

SAME AS BELOW

WHEN RECORDED MAIL TO:

GRANTEE

1272 WRANGLER CIRCLE

MINDEN, NEVADA

REQUESTED BY  
Stewart Title of Douglas County  
IN OFFICIAL RECORDS OF  
DOUGLAS CO., NEVADA

2004 MAR 18 PM 3:35

WERNER CHRISTEN  
RECORDER

\$15.00 PAID KJ DEPUTY

(Space Above for Recorder's Use Only)

### GRANT, BARGAIN, SALE DEED

THIS INDENTURE WITNESSETH: That **HANS C. VANDERPOEL and ROCHELLE VANDERPOEL, husband and wife**

in consideration of \$10.00, the receipt of which is hereby acknowledged, does hereby Grant, Bargain Sell and Convey to **ROGER BUTTON and STEPHENNY BUTTON, husband and wife, as Joint Tenants**

and to the heirs and assigns of such Grantee forever, all that real property situated in the County of **Douglas** State of Nevada, bounded and described as:

**SEE EXHIBIT "A" ATTACHED HERETO AND MADE A PART HEREOF**

Together with all and singular the tenements, hereditaments and appurtenances thereunto belonging or in anywise appertaining, and any reversions, remainders, rents, issues or profits thereof.

DATE: **March 04, 2004**

*[Signature]*  
**HANS C. VANDERPOEL**

*[Signature]*  
**ROCHELLE VANDERPOEL**

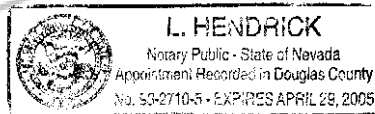

STATE OF Nevada } ss.

COUNTY OF Douglas }

This instrument was acknowledged before me on 3-11-04  
by **HANS C. VANDERPOEL and ROCHELLE VANDERPOEL**

Signature

*[Signature]*  
Notary Public (One inch margin on all sides of document for Recorder's Use Only)

0607559

BK0304PG08532

**EXHIBIT "A"**

**LEGAL DESCRIPTION**

ESCROW NO.: 040700537

The land referred to herein is situated in the State of Nevada, County of Douglas described as follows:

Lot 204, as shown on the Final Map of WILDHORSE UNIT 6, A PLANNED UNIT DEVELOPMENT, filed for record in the office of the County Recorder of Douglas County, State of Nevada, on March 15, 1994 in Book 394, Page 2741, as Document No. 332336.

Assessors Parcel No. 1420-33-312-049

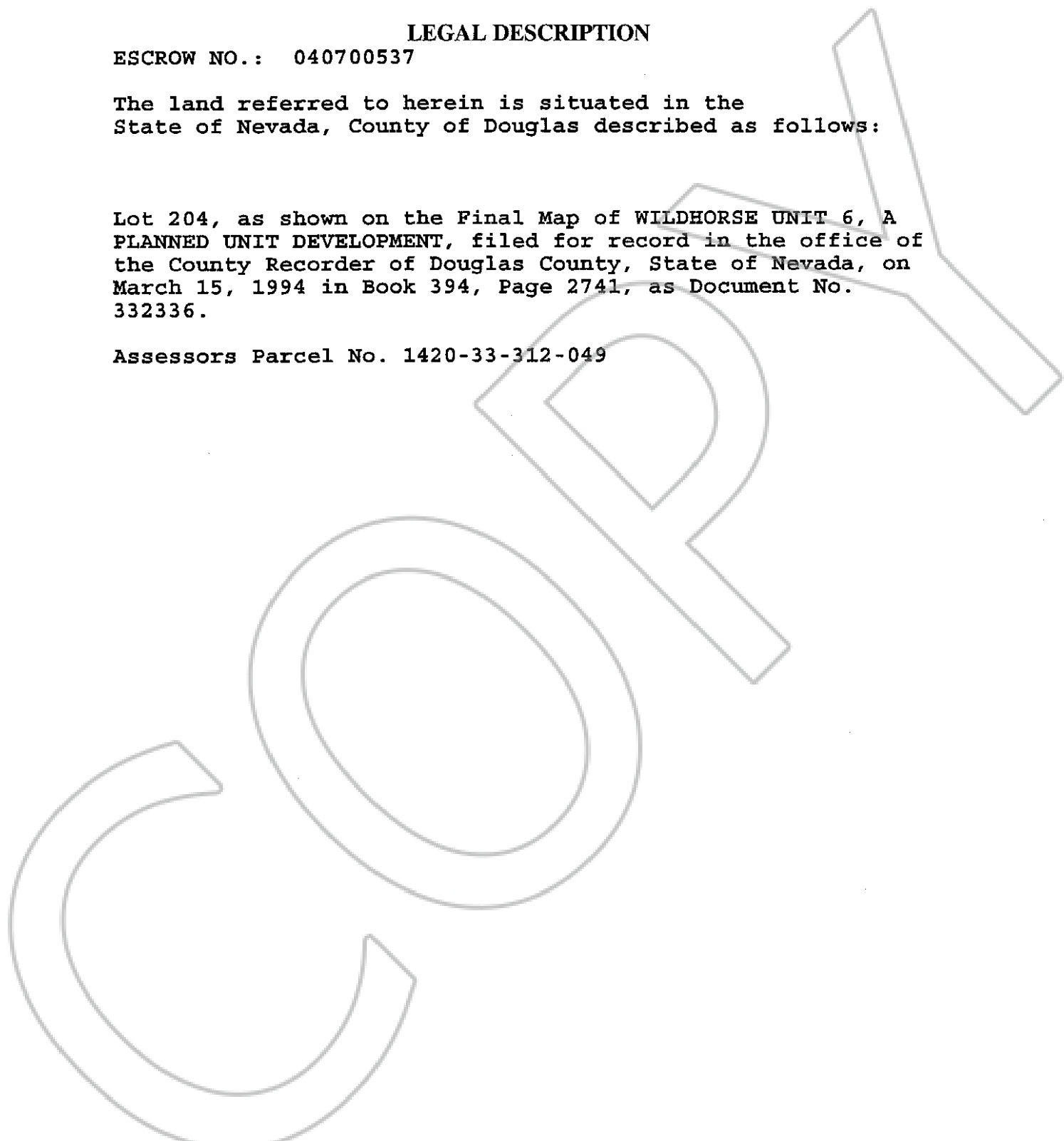

0607559

BK0304PG08533