



**EXHIBIT "A"**

**LEGAL DESCRIPTION**

ESCROW NO.: 040800079

The land referred to herein is situated in the  
State of Nevada, County of Douglas  
City of GARDNERVILLE described as follows:

Lot 161, as shown on the official map of GARDNERVILLE  
RANCHOS UNIT NO. 6, filed for record on May 29, 1973, in  
the office of the County Recorder of Douglas County, Nevada  
as Document No. 66512.

Assessors Parcel No. 1220-21-510-112

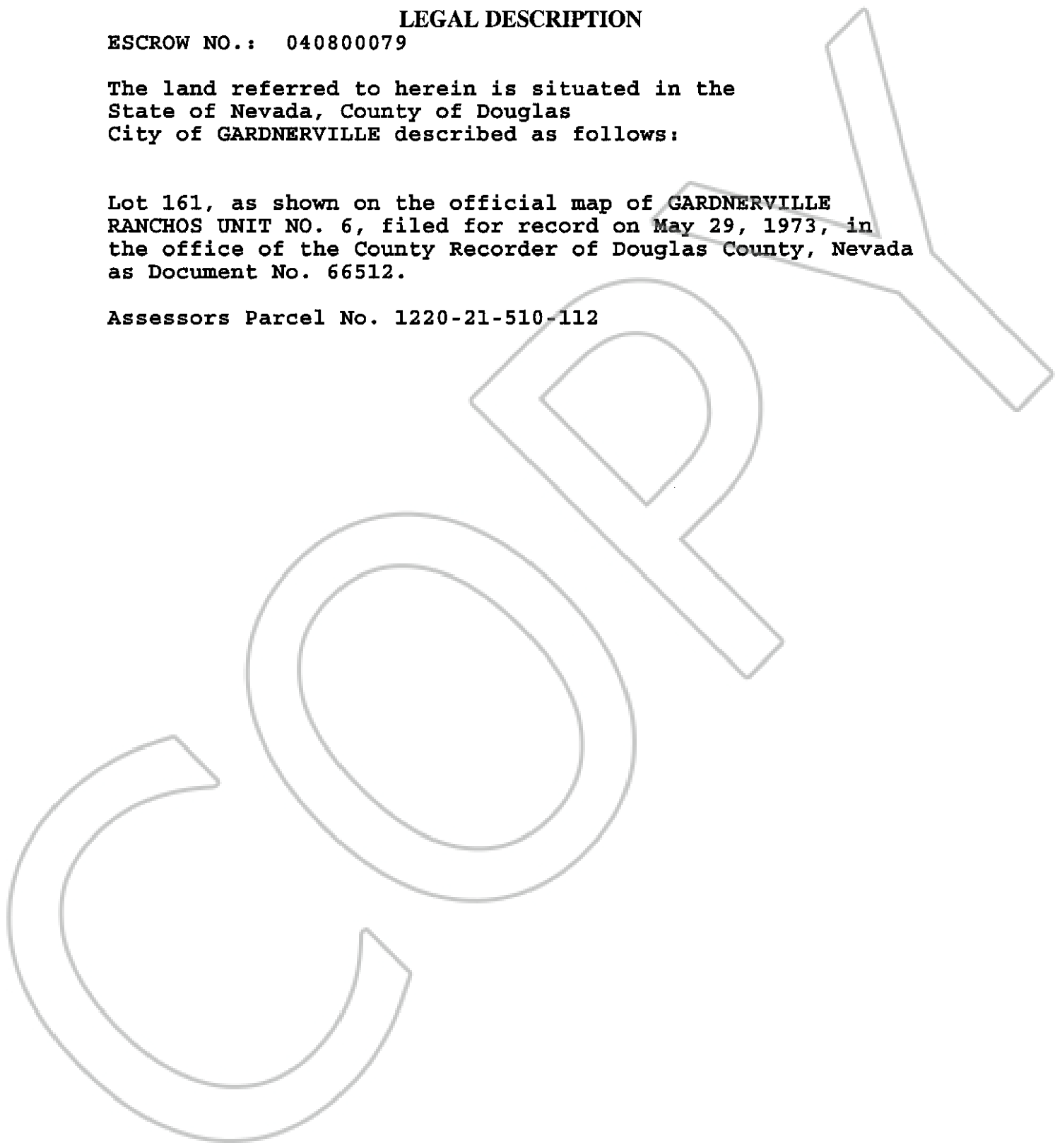

0607679

BK0304PG09109