

EXHIBIT "A"

LEGAL DESCRIPTION

ESCROW NO.: 030304330

**The land referred to herein is situated in the
State of Nevada, County of DOUGLAS
City of GARDNERVILLE described as follows:**

**Lot 692, as shown on the map of GARDNERVILLE RANCHOS UNIT
NO. 7, filed for record in the office of the County
Recorder of Douglas County, Nevada, on March 27, 1974, in
Book 374, as File No. 72456.**

Assessors Parcel No. 1220-22-310-123

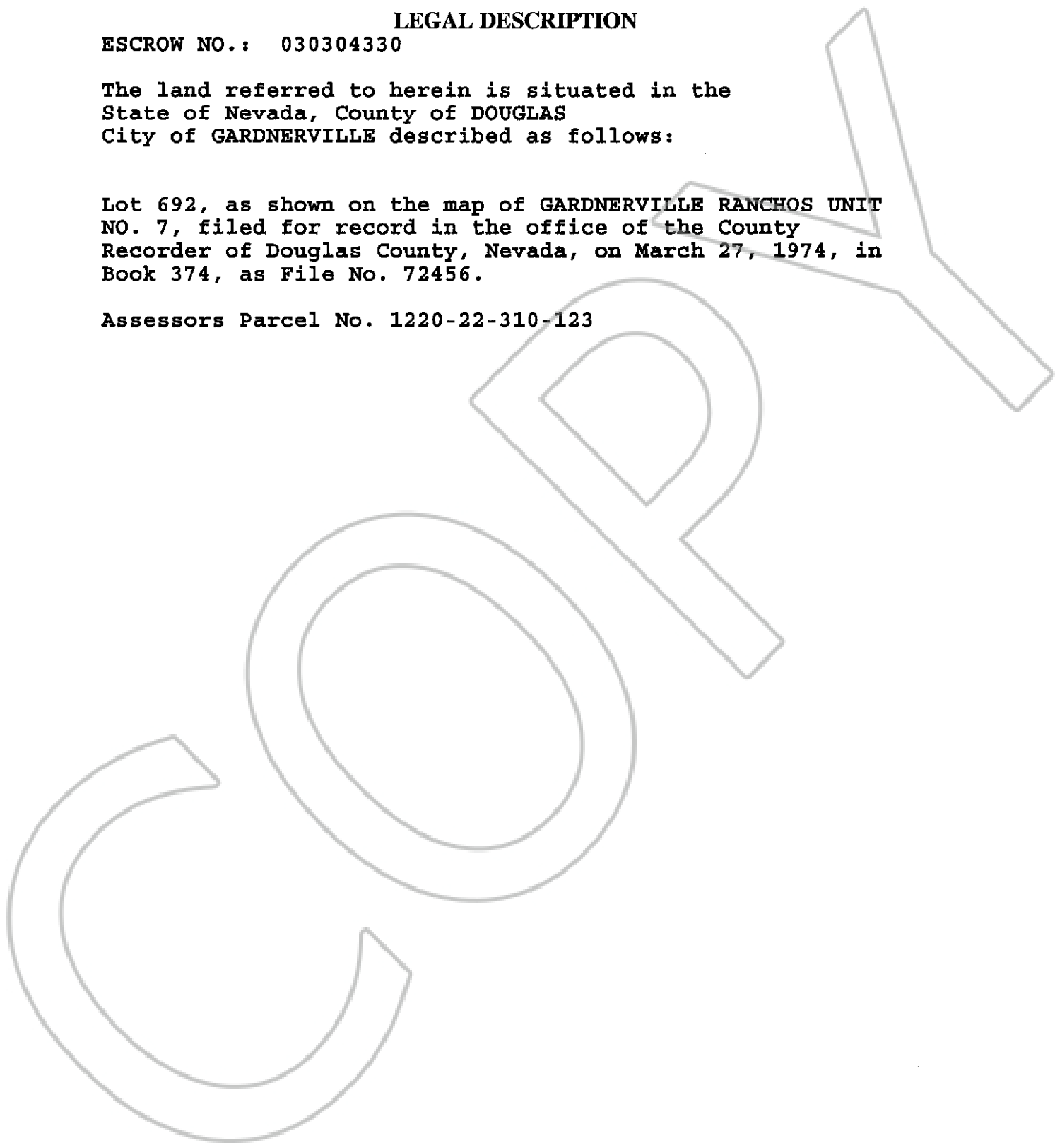

0607700

BK0304PG09289