

A.P.N. # 1320-33-311-025

R.P.T.T. \$ 1,343.55
ESCROW NO. 030303266

RECORDING REQUESTED BY:
STEWART TITLE COMPANY
MAIL TAX STATEMENTS TO:
SAME AS BELOW

WHEN RECORDED MAIL TO:
MR. & MRS. ETCHECHURY
11909 LONE OAK DRIVE
BAKERSFIELD, CA 93321

REQUESTED BY
Stewart Title of Douglas County

IN OFFICIAL RECORDS OF
DOUGLAS CO., NEVADA

2004 MAR 23 PM 3:21

WERNER CHRISTEN
RECORDER

\$15.00 PAID *KJ* DEPUTY

(Space above for Recorder's Use Only)

**CORPORATION
GRANT, BARGAIN, SALE DEED**

THIS INDENTURE WITNESSETH: That
WEST RIDGE HOMES, INC., a Nevada corporation

in consideration of \$10.00, the receipt of which is hereby acknowledged, does hereby Grant, Bargain Sell
and Convey to

**GUILLAUME ETCHECHURY and JUDITH A. ETCHECHURY, husband and
wife as joint tenants**

and to the heirs and assigns of such Grantee forever, all that real property situated in the
County of **DOUGLAS** State of Nevada,

bounded and described as follows:

SEE EXHIBIT "A" ATTACHED HERETO AND MADE A PART HEREOF

Together with all and singular the tenements, hereditaments and appurtenances thereunto belonging or in
anywise appertaining, and any reversions, remainders, rents, issues or profits thereof.

DATE: **February 23, 2004**

**WEST RIDGE HOMES, INC.
A NEVADA CORPORATION**

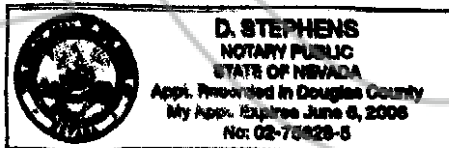

BY: *Peter M. Beekhof*
PETER M. BEEKHOF, JR.
PRESIDENT

BY: _____

STATE OF Nevada }
COUNTY OF DOUGLAS } ss.

This instrument was acknowledged before me on 3.22.04
by **PETER M. BEEKHOF, JR.**

Signature *D. Stephens*
Notary Public (One Inch Margin on all sides of Document for Recorder's Use Only)

0608176

BK0304PG11220

EXHIBIT "A"

LEGAL DESCRIPTION

ESCROW NO.: 030303266

The land referred to herein is situated in the State of Nevada, County of DOUGLAS City of GARDNERVILLE described as follows:

Lot 31, Block B, as set forth on Final Subdivision Map FSM-1006-2 for CHICHESTER ESTATES Phase 2, filed for record in the office of the County Recorder of Douglas County, State of Nevada, on December 9, 1996, in Book 1296 at Page 1286, as Document No. 402540, and by Certificate of Amendment recorded July 17, 2001, Book 0701, Page 3929, as Document No. 518479.

Assessors Parcel No. 1320-33-311-025

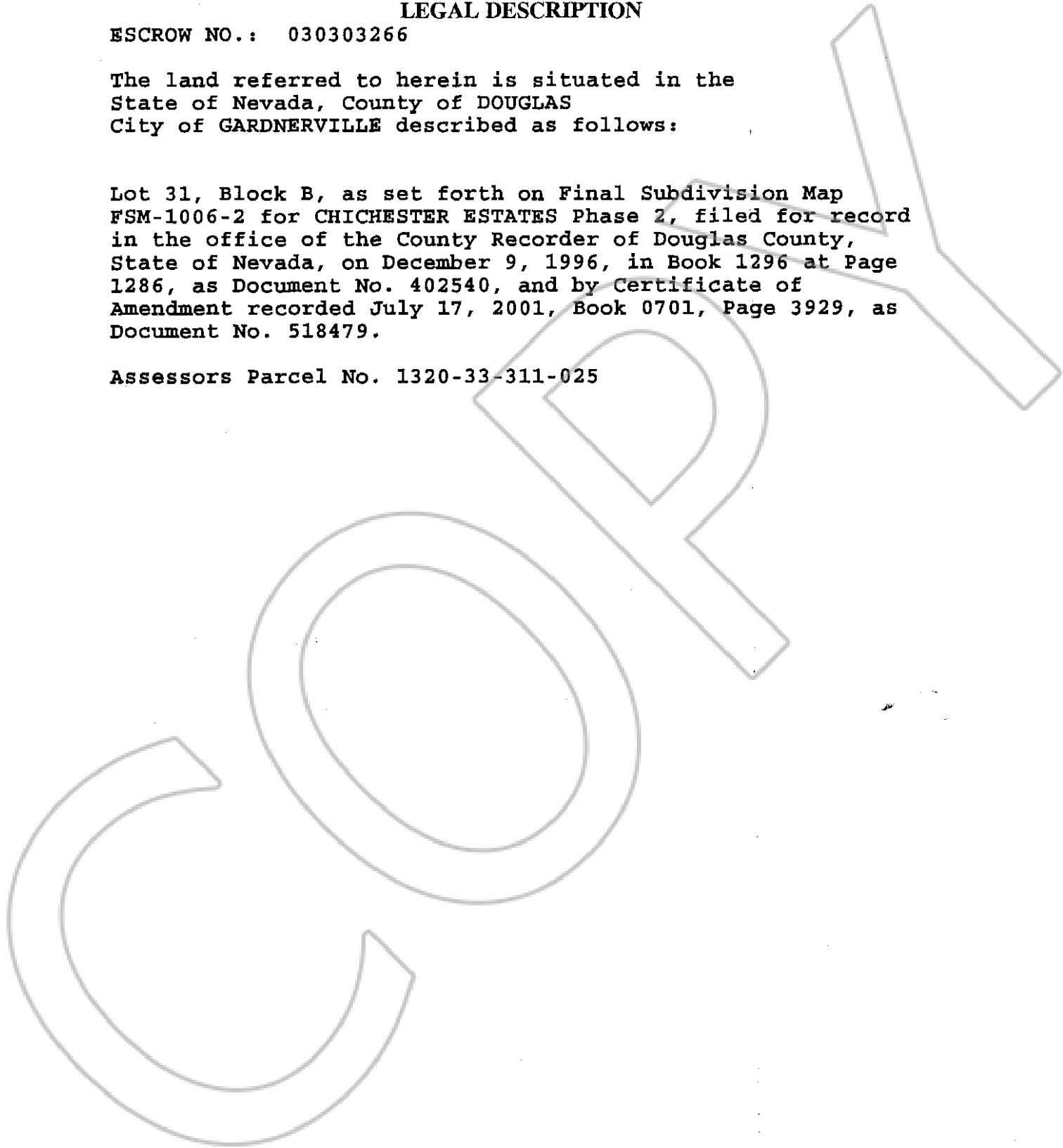

0608176

BK0304PG11221