



**EXHIBIT "A"**

**LEGAL DESCRIPTION**

ESCROW NO.: 040800464

The land referred to herein is situated in the  
State of Nevada, County of Douglas  
City of GARDNERVILLE described as follows:

Lot 55, as said lot is shown on the Official Plat of  
GARDNERVILLE RANCHOS UNIT NO. 3, filed in the office of the  
County Recorder of Douglas County, Nevada, on June 1, 1965,  
and Title Sheet amended on June 4, 1965, as Document No.  
28378.

Assessor's Parcel No. 1220-10-811-021

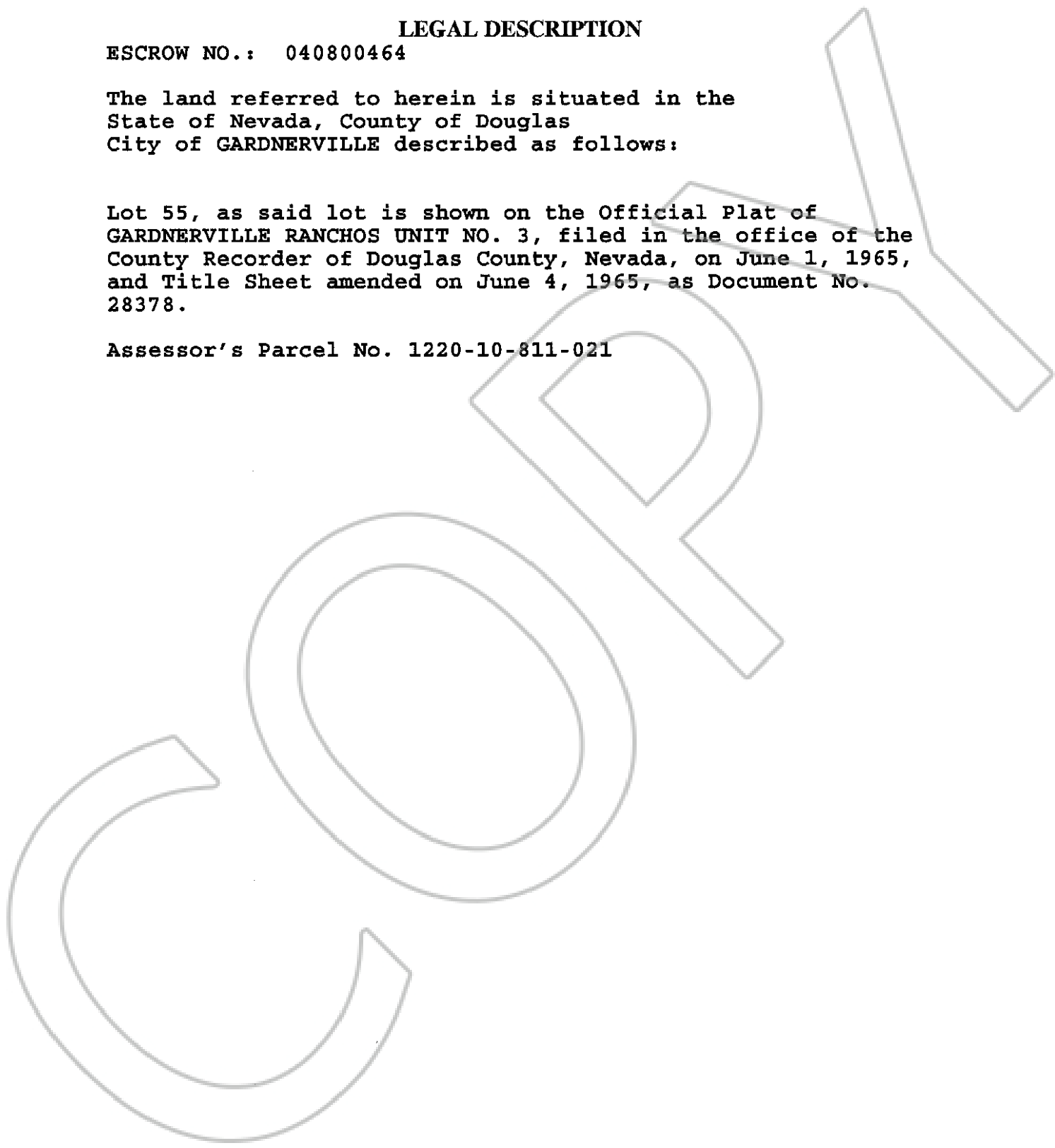

0608495

BK0304PG12999