

A.P.N. # 1219-22-001-020

R.P.T.T. \$ 7566.00

ESCROW NO. 040700526

RECORDING REQUESTED BY:  
**STEWART TITLE COMPANY**  
MAIL TAX STATEMENTS TO:  
**SAME AS BELOW**

WHEN RECORDED MAIL TO:  
**GRANTEE**  
**11 DEER CREEK LANE**  
**DANVILLE, CA 94506**

REQUESTED BY  
**Stewart Title of Douglas County**  
IN OFFICIAL RECORDS OF  
DOUGLAS CO., NEVADA

2004 MAR 26 PM 3:45

WERNER CHRISTEN  
RECORDER

\$15.00 PAID KJ DEPUTY

(Space Above for Recorder's Use Only)

### GRANT, BARGAIN, SALE DEED

THIS INDENTURE WITNESSETH: That **LONNIE D. MASON, Trustee of the**  
**LONNIE D. MASON FAMILY TRUST DATED NOVEMBER 19, 1997**

in consideration of \$10.00, the receipt of which is hereby acknowledged, does hereby Grant, Bargain Sell  
and Convey to **ROBERT M. SHIELLS and JEANNE M. SHIELLS, husband**  
**and wife** as Community Property

and to the heirs and assigns of such Grantee forever, all that real property situated in the  
County of **Douglas** State of Nevada, bounded and described as:

**SEE EXHIBIT "A" ATTACHED HERETO AND MADE A PART HEREOF**

Together with all and singular the tenements, hereditaments and appurtenances thereunto belonging or in  
anywise appertaining, and any reversions, remainders, rents, issues or profits thereof.

DATE: **March 09, 2004** **LONNIE D. MASON FAMILY TRUST**  
**DATED NOVEMBER 19, 1997**

BY: *Lonnie D. Mason*  
**LONNIE D. MASON**  
**TRUSTEE**

BY: \_\_\_\_\_

STATE OF California }  
COUNTY OF Riverside } SS.

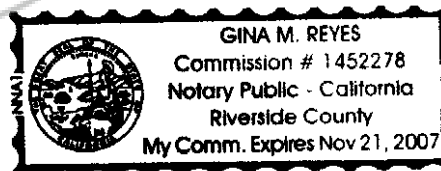

This instrument was acknowledged before me on March 16, 2004  
by LONNIE D. MASON

Signature *Gina M. Reyes*

Notary Public (One Inch Margin on all sides of Document for Recorders Use Only)

0608505

BK0304PG13096

**EXHIBIT "A"**

**LEGAL DESCRIPTION**

ESCROW NO.: 040700526

The land referred to herein is situated in the State of Nevada, County of Douglas City of GARDNERVILLE described as follows:

Lot 322 in Block C, as set forth on that certain Official Plat of JOB'S PEAK RANCH UNIT 3, filed for record in the office of the County Recorder of Douglas County, State of Nevada, on October 5, 2001 in Book 1001 of Official Records at Page 1342 as Document No. 524340.

Assessors Parcel No. 1219-22-001-020

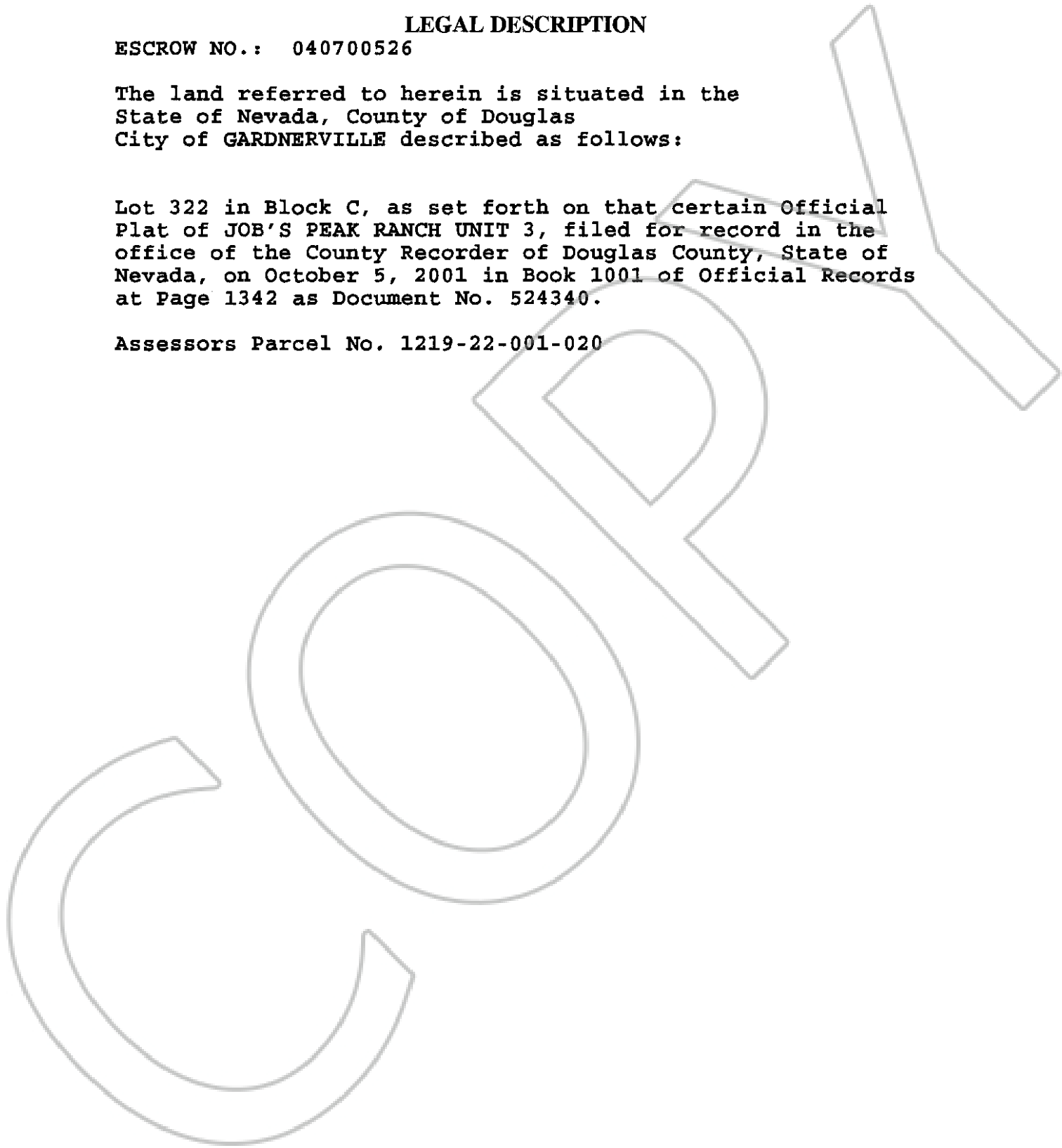

0608505

BK 0304 PG 13097