

APN: 1320-27-002-025, 026, 027, 028
-R.P.T.T. #3
-ORDER NO. 040500025
WHEN RECORDED MAIL TO:
Bently Pressurized Bearing Co.
c/o Agnes Benis
1711 Orbit Way
Minden, NV 89423

REQUESTED BY
Stewart Title of Douglas County
IN OFFICIAL RECORDS OF
DOUGLAS CO., NEVADA

2004 MAR 30 AM 10:57

WERNER CHRISTEN
RECORDER

\$26 PAID ⁵⁰ KJ DEPUTY

**BOUNDARY LINE ADJUSTMENT
GRANT, BARGAIN, SALE DEED**

THIS INDENTURE WITNESSETH: BENTLY PRESSURIZED BEARING COMPANY, a Nevada corporation, formerly known as BENTLY NEVADA CORPORATION, a Nevada corporation, in consideration of \$10.00, the receipt of which is hereby acknowledged, does hereby Grant, Bargain Sell and Convey to BENTLY PRESSURIZED BEARING COMPANY, a Nevada corporation, AND TO THE HEIRS AND ASSIGNS OF SUCH Grantee forever, all that real property situated in the County of Douglas, State of Nevada, bounded and described as follows:

SEE EXHIBIT "A" ATTACHED HERETO AND MADE A PART HEREOF

Date: 20 Jan 04

BENTLY PRESSURIZED BEARING
CO., a Nevada corporation

Donald E. Bently
By: DONALD E. BENTLY

CHIEF EXECUTIVE OFFICER

STATE OF NEVADA } ss.
COUNTY OF DOUGLAS }

This instrument was acknowledged before me on 1/28/04,
By, Donald E. Bently

Signature Kelly M. Denney
Notary Public

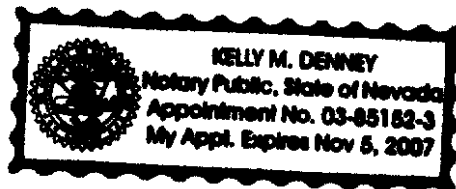

0608737

BK0304PG14471



EXHIBIT "A"
APN. 1320-27-002-024
MACTEC

APN 1320-27-002-023

Job No 48867-3
Date 12-10-03
JC/MB

BENTLY NEVADA CORPORATION
LOT D-1
AFTER ABANDONMENT OF VECTOR DRIVE
LEGAL DESCRIPTION

All of Lot D-1 as shown on the Record of Survey for Bently Nevada Corporation, Document No. 545092 of the Douglas County Recorder's Office and that portion of the West one-half of the abandoned Vector Drive as recorded in Document No. 0581702 of the Douglas County Recorder's Office, and being a portion of the South one-half of Section 27, Township 13 North, Range 20 East, M.D.M., Douglas County, Nevada and a being more particularly described as follows.

BEGINNING at the Northeasterly corner of Lot D-1, thence along the prolongation of the Southerly right-of-way line of Buckeye Road, South $89^{\circ}29'35''$ East, 49.97 feet to a point on the centerline of said abandoned Vector Drive; thence along said centerline, South $00^{\circ}25'59''$ West, 565.56 feet; thence North $89^{\circ}59'54''$ West, 30.00 feet to a point the Easterly line of said Lot D-1; thence along said Easterly line, North $00^{\circ}25'59''$ East, 545.85 feet; thence along the Easterly line of said Lot D-1, 31.39 feet and the arc of a curve to the left having a central angle of $89^{\circ}55'34''$ and a radius of 20.00 feet and having a chord of North $44^{\circ}31'48''$ West, 28.27 feet to the POINT OF BEGINNING.

Containing 10.760 acres, more or less Lot D-1.
0.392 acres, more or less abandoned portion of Vector Drive.

MACTEC Engineering and Consulting, Inc.
1572 E. College Parkway, Suite 162 Carson City, NV 89706
775-888-9992 Fax: 775-888-9994

0608737

BK0304PG14472

total 11.152 acres more or less per this legal description.

Note:

The above Legal Description does not create any new parcels. Refer this Legal Description to your title company before incorporating into any legal document.

The Basis of Bearing for this description is the centerline of Bently Parkway South as shown on said Record of Survey taken as South 46°50'22" East.

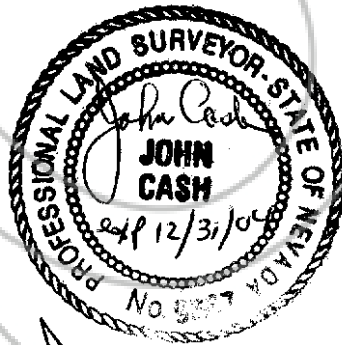

January 16, 2004

MACTEC Engineering and Consulting, Inc.
1572 E. College Parkway, Suite 162 Carson City, NV 89706
775-888-9992 Fax: 775-888-9994

0608737

BK0304 PG14473



APN 1320-27-002-027
MACTEC

APN 1320-27-002-024

Job No 48867-3
Date 12-10-03
JC/MB

**BENTLY NEVADA CORPORATION
LOT D-2
AFTER ABANDONMENT OF VECTOR DRIVE
LEGAL DESCRIPTION**

All of Lot D-2 as shown on the Record of Survey for Bently Nevada Corporation, Document No. 545092 of the Douglas County Recorder's Office and that portion of the West one-half of the abandoned Vector Drive as recorded in Document No. 0581702 of the Douglas County Recorder's Office, and being a portion of the South one-half of Section 27, Township 13 North, Range 20 East, M.D.M., Douglas County, Nevada and a being more particularly described as follows.

BEGINNING at the Northeasterly corner of Lot D-2, thence South 89°59'54" East, 30.00 feet to a point on the centerline of said abandoned Vector Drive; thence along said centerline, South 00°25'59" West, 409.41 feet; thence continuing along said centerline 49.53 feet along the arc of a curve to the right having a central angle of 28°22'26" and a radius of 100.00 feet and having a chord of South 14°37'17" West, 49.02 feet; thence North 46°50'22" West, 16.88 feet; thence South 43°09'38" West, 50.00 feet to a point on the prolongation of Northerly right-of-way line of Bently Parkway South; thence along said prolongation line, North 46°50'22" West, 30.00 feet to a point on the Southerly most portion of said Lot D-2; thence along the Easterly line of said Lot D-2, 31.42 feet and the arc of a curve to the left having a central angle of 90°00'00" and a radius of 20.00 feet and having a chord of North 88°09'38" East, 28.28 feet; thence continuing along said Easterly line, North 43°09'38" East, 5.21 feet; thence continuing along said Easterly line 52.20 feet and the arc of a curve to the left having a central angle of 42°43'39" and a radius of 70.00 feet and having a chord of North 21°47'48" East 51.00 feet; thence

MACTEC Engineering and Consulting, Inc.
1572 E. College Parkway, Suite 162 Carson City, NV 89706
775-888-9992 Fax: 775-888-9994

0608737
BK0304 PG14474

continuing along said Easterly line, North 00°25'59" East, 409.18 feet, to the POINT OF BEGINNING.

Containing 3.150 acres, more or less Lot D-2.
0.323 acres, more or less abandoned portion of Vector Drive.
total 3.473 acres more or less per this legal description.

Note:

The above Legal Description does not create any new parcels. Refer this Legal Description to your title company before incorporating into any legal document.

The Basis of Bearing for this description is the centerline of Bently Parkway South as shown on said Record of Survey taken as South 46°50'22" East.

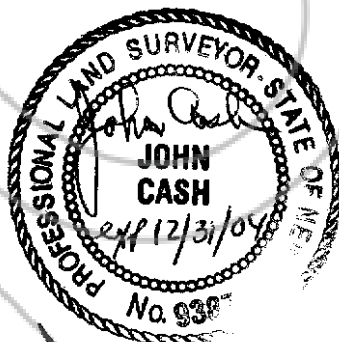

January 16, 2004

MACTEC Engineering and Consulting, Inc.
1572 E. College Parkway, Suite 162 Carson City, NV 89706
775-888-9992 Fax: 775-888-9994

0608737

BK0304PG14475

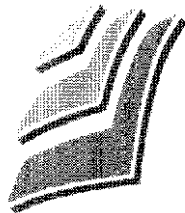

MACTEC

APN 1320-27-002-007

Job No 48867-3
Date 12-10-03
JC/MB

**BENTLY NEVADA CORPORATION
ADJUSTED BLOCK "E" (DOC NO 465621)
AFTER ABANDONMENT OF VECTOR DRIVE
LEGAL DESCRIPTION**

All of adjusted Block "E" as shown on the Record of Survey to Support a Lot Line Adjustment for Bently Nevada Corporation, Document No. 465621 of the Douglas County Recorder's Office and that portion of the East one-half of the abandoned Vector Drive as recorded in Document No. 0581702 of the Douglas County Recorder's Office, and being a portion of the South one-half of Section 27, Township 13 North, Range 20 East, M.D.M., Douglas County, Nevada and a being more particularly described as follows.

BEGINNING at the Northwesterly corner of Block "E", thence along the Westerly line of said Block "E", 30.01 feet along the arc of a curve to the left having a central angle of 85°58'20" and a radius of 20.00 feet, and having a chord of South 43°25'09" West, 27.27 feet; thence continuing along said Westerly line, South 00°25'59" West, 548.69 feet to the Southwesterly corner of said Block "E"; thence North 89°59'54" West, 30.00 feet to a point the abandoned centerline of said Vector Drive; thence along said centerline, North 00°25'59" East, 565.56 feet to a point on the prolongation of the Southerly right-of-way line of Buckeye Road; thence along said prolongation line, South 89°29'35" East, 1.73 feet; thence along a prolongation of said Buckeye Road, North 86°24'04" East, 46.98 feet to the POINT OF BEGINNING.

Containing 8.579 acres, more or less Adjusted Block "F".
0.392 acres, more or less abandoned portion of Vector Drive.

MACTEC Engineering and Consulting, Inc.
1572 E. College Parkway, Suite 162 Carson City, NV 89706
775-888-9992 Fax: 775-888-9994

0608737

BK0304PG14476

total 8.971 acres more or less per this legal description.

Note:

The above Legal Description does not create any new parcels. Refer this Legal Description to your title company before incorporating into any legal document.

The Basis of Bearing for this description is the centerline of Bently Parkway South as shown on said Record of Survey taken as South 46°50'22" East.

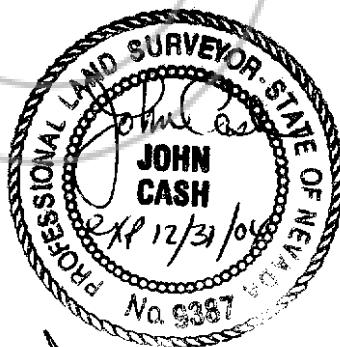

January 16 2004

MACTEC Engineering and Consulting, Inc.
1572 E. College Parkway, Suite 162 Carson City, NV 89706
775-888-9992 Fax: 775-888-9994

0608737

BK0304PG14477

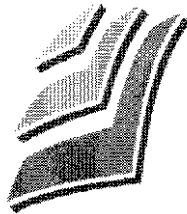

MACTEC

APN 1320-27-002-007

Job No 48867.03
Date 12/18/03
JC/MB

BENTLY NEVADA CORPORATION
NEW BLOCK "E"
LOT LINE ADJUSTMENT
LEGAL DESCRIPTION

All that portion of property being a portion of the South one-half of Section 27, Township 13 North, Range 20 East, M.D.M., and all of Block "E" and a portion of Block "F", as shown on the Record of Survey to Support a Lot-Line Adjustment for Bently Nevada Corporation, Document No. 465621 of the Douglas County Recorder's Office and that portion of the East half of abandoned Vector Drive as recorded in Document No. 0581702 of the Douglas County Recorded Office, Douglas County, Nevada, and being more particularly described as follows:

BEGINNING at an angle point on the Northerly line of said Block "E", said point bears South $88^{\circ}48'00''$ East 1478.21 feet from the centerline intersection of Buckeye Road and Bently Parkway South and being a survey well with a 5/8" rebar an aluminum cap stamped PLS 6497; thence along said Northerly line of Block "E", South $89^{\circ}29'36''$ East 395.60 feet; thence 31.07 feet along the Easterly line of said Block "E" and the arc of a curve to the right having a central angle of $88^{\circ}59'51''$ and a radius of 20.00 feet, and having a chord of South $44^{\circ}59'41''$ East 28.04 feet; thence continuing along said Easterly line of Block "E", South $00^{\circ}29'45''$ East, 414.64 feet to the Southeasterly corner of said Block "E"; thence along the Southerly line of said Block "E", North $89^{\circ}59'54''$ West, 333.12 feet; thence South $00^{\circ}02'52''$ East, 155.77 feet; thence North $89^{\circ}59'54''$ West 509.69 feet to a point on the Easterly right-of-way line of said abandoned Vector Drive; thence North $89^{\circ}59'54''$ West, 30.00 feet to the centerline of abandoned Vector Drive; thence along said centerline of Vector Drive, North $00^{\circ}25'59''$ East, 565.56 feet to a point on the Southerly right-of-way line of Buckeye Road; thence along said Southerly right-of-way line, South $89^{\circ}29'35''$ East, 1.73 feet; thence continuing along said Southerly right-of-way line, North $86^{\circ}24'04''$ East, 448.56 feet the POINT OF BEGINNING.

MACTEC Engineering and Consulting, Inc.
1572 E. College Parkway, Suite 162 Carson City, NV 89706
775-888-9992 Fax: 775-888-9994

0608737

BK0304PG14478

Containing 0.311 acres, more or less abandoned portion of Vector Drive.
Containing 1.605 acres, more or less adjusted Block "F" together with that abandoned portion of Vector Drive.
Containing 10.488 acres, more or less New Block "E".

The Basis of Bearings for this description is the centerline of Bently Parkway South as shown on said Final Map taken as South 46°50'22" East.

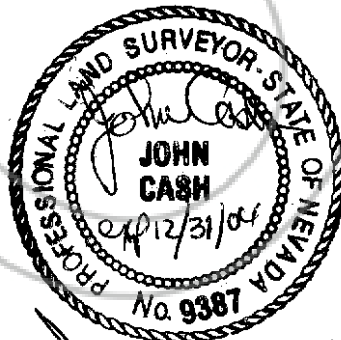

January 20, 2007

MACTEC Engineering and Consulting, Inc.
1572 E. College Parkway, Suite 162 Carson City, NV 89706
775-888-9992 Fax: 775-888-9994

0608737

BK0304PG14479



MACTEC

APN 1320-27-002-005

Job No 48867.03

Date 12/18/03

JC/MB

BENTLY NEVADA CORPORATION
ADJUSTED BLOCK "F"
LOT LINE ADJUSTMENT
LEGAL DESCRIPTION

All that portion of property being a portion of the South one-half of Section 27, Township 13 North, Range 20 East, M.D.M., and that portion of Block "F", as shown on the Record of Survey to Support a Lot Line Adjustment for Bently Nevada Corporation, Document No. 465621 of the Douglas County Recorder's Office and that portion of the East one-half of Vector Drive abandonment as recorded in Document No. 0581702 of the Douglas County Recorder's Office, Douglas County, Nevada, and being more particularly described as follows:

BEGINNING at a point on the Westerly line of Block "F" and the Easterly right-of-way line of said abandoned Vector Drive, said point bears South $64^{\circ}17'37''$ East 1170.98 feet from the centerline intersection of Buckeye Road and Bently Parkway South and being a survey well with a $5/8''$ rebar an aluminum cap stamped PLS 6497; thence along the Northerly line of said Block "F", South $89^{\circ}59'54''$ East 336.34 feet; thence continuing along said Northerly line of Block "F", North $00^{\circ}00'06''$ East 38.42 feet; thence continuing Northerly line of said Block "F", South $89^{\circ}59'54''$ East, 172.33 feet; thence, South $00^{\circ}02'52''$ East 155.77 feet; thence, North $89^{\circ}59'54''$ West 509.69 feet to a point said abandoned Easterly right-of-way line; thence North $89^{\circ}59'54''$ West, 30.00 feet to the centerline of said abandoned Vector Drive; thence along said centerline of abandoned Vector Drive, North $00^{\circ}25'59''$ East, 117.35 feet; thence South $89^{\circ}59'54''$ East, 30.00 feet to the POINT OF BEGINNING.

MACTEC Engineering and Consulting, Inc.
1572 E. College Parkway, Suite 162 Carson City, NV 89706
775-888-9992 Fax: 775-888-9994

0608737

BK0304PG14480

Job No 48867.03
Date 06/18/02
JC/MB

Containing 66,376 square feet, more or less before Vector Drive abandonment.
Containing 3,521 square feet, more or less Vector Drive abandonment portion.
Containing 69,897 square feet, more or less.

The Basis of Bearings for this description is the centerline of Bently Parkway South as shown on said Final Map taken as South $46^{\circ}50'22''$ East.

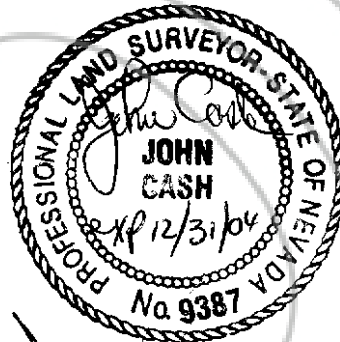

January 20, 2004



APN. 1320-27-002-005
MACTEC

APN 1320-27-002-005

Job No 48867-3
 Date 12-10-03
 JC/MB

**BENTLY NEVADA CORPORATION
 ADJUSTED BLOCK "F" (DOC NO 465621)
 AFTER ABANDONMENT OF VECTOR DRIVE
 LEGAL DESCRIPTION**

All of adjusted Block "F", as shown on the Record of Survey to Support a Lot Line Adjustment for Bently Nevada Corporation, Document No. 465621 of the Douglas County Recorder's Office and that portion of the East one-half of Vector Drive as recorded in Document No. 0581702 of the Douglas County Recorder's Office and being a portion of the South one-half of Section 27, Township 13 North, Range 20 East, M.D.M., Douglas County, Nevada, being more particularly described as follows:

BEGINNING at the Northwest corner of said Block "F"; thence along the Westerly line of said Block "F", South 00°25'59" West, 409.64 feet; thence continuing along said Westerly line, 96.95 feet along the arc of a curve to the right having a central angle of 42°43'39" and a radius of 130.00 feet, and having a chord of South 21°47'48" West, 94.71 feet; thence continuing along said Westerly line, South 43°09'38" West, 5.21 feet; thence continuing along said Westerly line, 31.42 feet along the arc of a curve to the left having a central angle of 90°00'00" and a radius of 20.00 feet, and having a chord of South 01°50'22" East, 28.28 feet to a point on the Northerly right-of-way line of Bently Parkway South; thence along a prolongation of Bently Parkway South, North 46°50'22" West, 38.00 feet; thence North 43°09'38" East, 50.00 feet; thence North 46°50'22" West, 15.12 feet to a point on the abandoned centerline of said Vector Drive; thence along said centerline of Vector Drive, 49.53 feet along the arc of a curve to the left having a central angle of 28°22'36" and a radius of 100.00 feet, and having a chord of North 14°37'17" East, 49.02 feet, thence continuing along said centerline North 00°25'59" East, 409.41 feet; thence South 89°59'54" East, 30.00 feet, to the POINT OF BEGINNING.

MACTEC Engineering and Consulting, Inc.
 1572 E. College Parkway, Suite 162 Carson City, NV 89706
 775-888-9992 Fax: 775-888-9994

0608737

BK 0304 PG 14482

Containing 24.341 acres, more or less Adjusted Block "F".
Containing 0.346 acres, more or less abandoned portion of Vector Drive.
total 24.687 acres, more or less per this legal description.

Note:

The above Legal Description does not create any new parcels. Refer this Legal Description to your title company before incorporating into any legal document.

The Basis of Bearing for this description is the centerline of Bently Parkway South as shown on said Record of Survey taken as South 46°50'22" East.

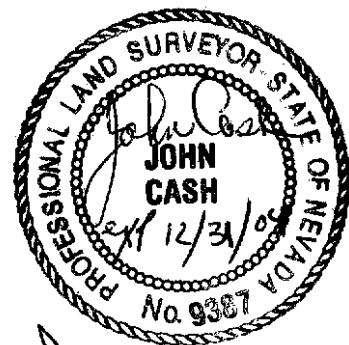
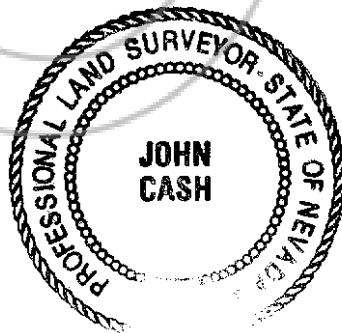

January 16, 2004

MACTEC Engineering and Consulting, Inc.
1572 E. College Parkway, Suite 162 Carson City, NV 89706
775-888-9992 Fax: 775-888-9994

0608737

BK0304PG14483