

15

REQUESTED BY
Kara Maricich
IN OFFICIAL RECORDS OF
DOUGLAS CO., NEVADA

Assessor Parcel Number: 1220-16-810-103 OR

2004 MAR 30 PM 2:55

Assessor's Manufactured Home ID number _____

WERNER CHRISTEN
RECORDER

\$15⁰⁰ PAID Be DEPUTY

Declaration of Homestead

(Check One)

- Married (filing joint declaration)
- Head of Family
- By Husband (filing for joint benefit or both)
- Single, Married or Widowed
- By Wife (filing for joint benefit or both)
- Multiple Single Persons

A. (Check One)

- Regular Home Dwelling/Manufactured Home
- Condominium Unit
- Other

Name on Title of Property _____

Do individually or severally certify and declare as follows: Frank + Kara Maricich husband + wife,
as joint tenants is/are now residing on the land, premises (or manufactured home) located in the
City of Gardnerville, County of Douglas, State of Nevada, and more particularly
described as follows:

(Set forth legal description and commonly known street address OR manufactured home description)

see exhibit A attached

B. I/We claim the land and premises hereinabove described, together with the dwelling house thereon, and its appurtenances, or the described manufactured home as a Homestead.

C. (Check One)

- (1) No former Declaration of Homestead has been made by me, or us, or either of us.
- (2) This Declaration constitutes an abandonment of the former Declaration recorded 2001.

In Witness, Whereof, I/We have hereunto set my hand/our hands this _____ day of _____, 20____.

(Signature)

(Print or type name here)

Kara J. Maricich
(Signature)
Kara J. Maricich
(Print or type name here)

STATE OF NEVADA _____)
COUNTY OF Washoe _____)

This instrument was acknowledged before me on 3/26/04
Kara Maricich
Frank Maricich
(date)

(Person(s) appearing before notary)

Elizabeth Andrews My commission expires: 6/27/05 (seal, if any)
(Signature of notarial officer)



CONSULT AN ATTORNEY IF YOU DOUBT THIS FORM'S FITNESS FOR YOUR PURPOSE

Recording Requested by and Mail to:
Name:
Address/ City/ State/ Zip:

This form provided as a courtesy to the taxpayer by: M. W. SCHOFIELD, CLARK COUNTY ASSESSOR
The Assessor's Office assumes no liability for the completion of the Homestead Declaration.

✓ 847 Russell Way
Gardnerville NV 89460

0608783
BK0304PG14629

Legal Description

All that real property situate in the County of Douglas, State of Nevada, described as follows:

Lot 2, in Block H, as said lot and block are shown on the map of GARDNERVILLE RANCHOS UNIT NO. 4, filed in the office of the County Recorder of Douglas County, State of Nevada, on April 10, 1967, in Map Book 1, Page 055, Filing No. 35914.

A.P.N. 1220-16-810-103

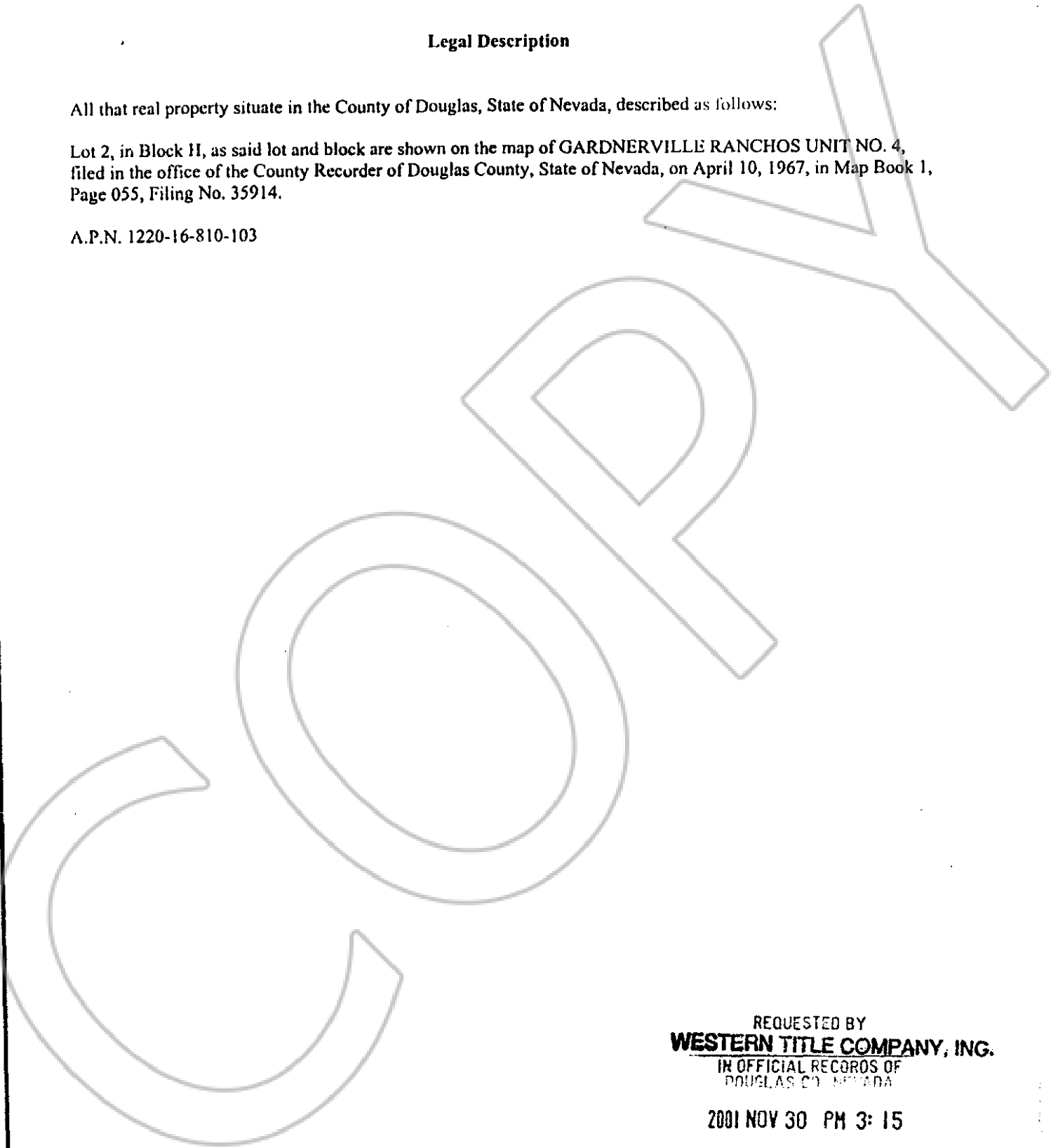

REQUESTED BY
WESTERN TITLE COMPANY, INC.
IN OFFICIAL RECORDS OF
DOUGLAS CO. NEVADA

2001 NOV 30 PM 3: 15

LINDA SENEA
RECORDER

s *LS* PAID *KJ* DEPUTY

0608783

0529003
BK 1101 PG 103

BK 0304 PG 14630