

16-

APN: 1320-33-813-001

Recording requested by and mail documents and tax statements to:

Name: Gloria Jean Anstett

Address: 1334 Chichester Drive

City/State/Zip: Gardnerville, Nevada
89410

DEC107

Nevada Legal Forms & Books, Inc. (702) 870-8977

www.legalformsrus.com

REQUESTED BY
Gloria Anstett
IN OFFICIAL RECORDS OF
DOUGLAS CO., NEVADA

2004 APR -2 PM 3:12

WERNER CHRISTEN
RECORDER

\$ 16.00 PAID Kg DEPUTY

DECLARATION OF HOMESTEAD

- CHECK ONE Head of Family Single, Married or Widowed
 Multiple single persons Married (filing joint declaration)
 By Husband (filing for benefit of both) By Wife (filing for benefit of both)

CHECK ONE HOUSE MOBILE HOME CONDOMINIUM UNIT OTHER

Name on title of property: James Ray Green Gloria Jean Anstett

do individually and severally certify and declare that the following named persons is/are residing on the land premises (or mobile home, condominium unit, townhouse) as follows: _____

located at (street address) 1334 Chichester Drive

City of Gardnerville, County of Douglas, State of Nevada,

and more particularly described as follows: **SUBDIVISION:** (set forth legal description and commonly known address)

Please see "exhibit A"

I/We claim the land and premises hereinabove described, together with the dwelling house thereon, and its appurtenances, or the described mobile home as a Homestead.

- No former Declaration of Homestead has been made by me, us, or either of us.
- This Declaration of Homestead constitutes an abandonment of the former Declaration recorded on / / .

In Witness Whereof, I/We have hereunto set my hand/our hands on April 2, 2004

Gloria Jean Anstett
Signature of Declarant

Signature of Declarant

Gloria Jean Anstett
Print or type name here

Print or type name here

STATE OF NEVADA)
COUNTY OF Douglas)

On this 2nd day of April, 2004, personally appeared before me, a Notary Public Gloria Jean Anstett personally known to me to be the person(s) whose name(e) is subscribed to the above instrument who acknowledged that She executed this instrument. Witness my hand and official seal.

[Signature]
Notary Public



My commission expires: 3/21/06

Consult an attorney if you doubt this forms fitness for your purpose.

0609252
BK0404PG01094

Exhibit "A"

Lot 8, Block A, as set forth on Final Subdivision Map #1006-5 of CHICHESTER ESTATES PHASE 5, filed in the office of the County Recorder of Douglas County, State of Nevada, on April 9, 1999, in Book 499, Page 1900, as Document No. 465394.

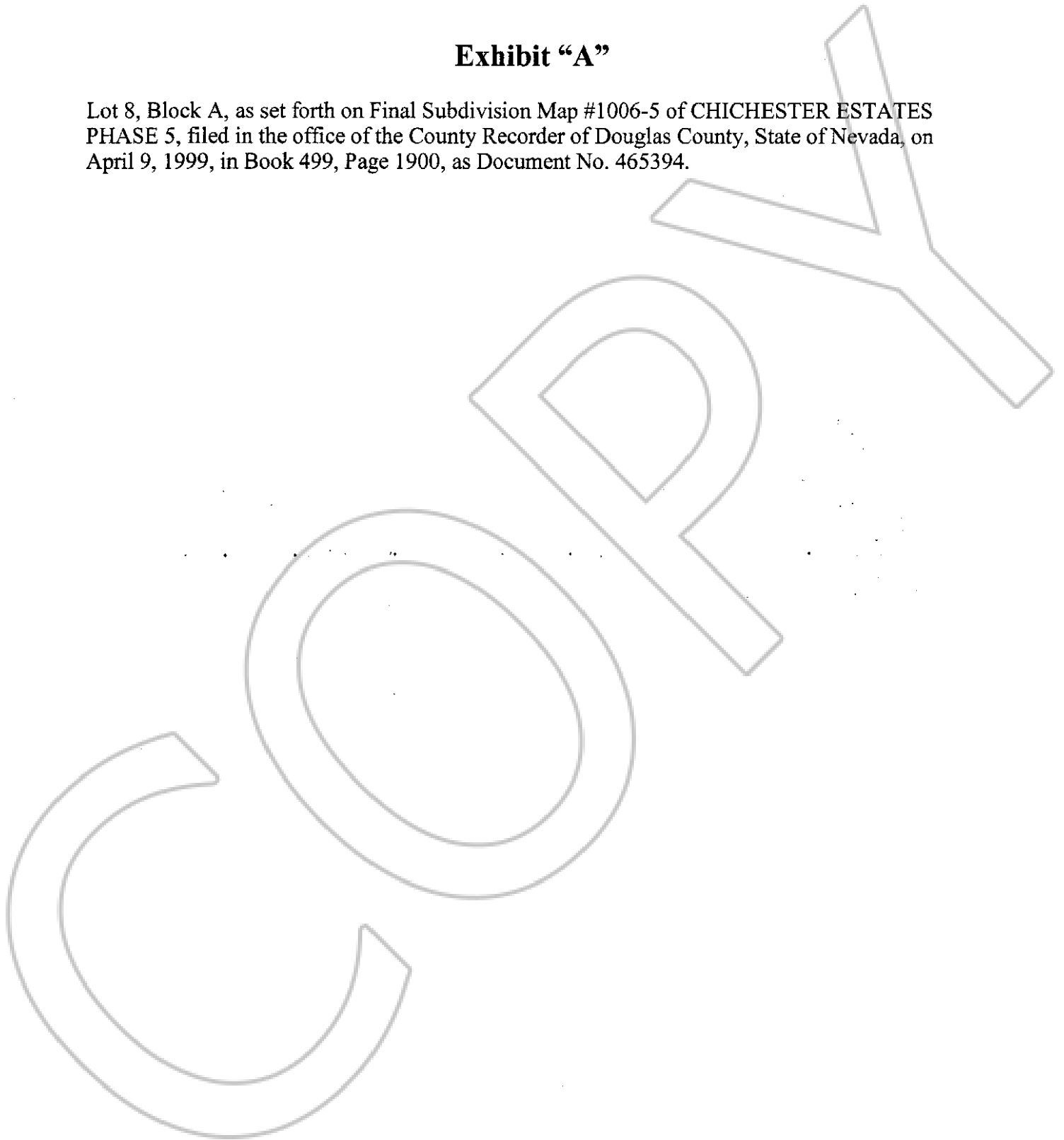

0609252
BK0404PG01095