

A.P.N. # 1420-17-111-002
R.P.T.T. \$ 45
ESCROW NO. 040300624
RECORDING REQUESTED BY:
STEWART TITLE COMPANY
MAIL TAX STATEMENTS TO:
SAME AS BELOW

WHEN RECORDED MAIL TO:
LEO A. HANLY
2221 MERIDIAN BLVD., STE. A
MINDEN, NV 89423

REQUESTED BY
Stewart Title of Douglas County
IN OFFICIAL RECORDS OF
DOUGLAS CO., NEVADA

2004 APR -2 PM 3:47

WERNER CHRISTEN
RECORDER

\$15⁰⁰ PAID KJ DEPUTY

(Space Above for Recorder's Use Only)

GRANT, BARGAIN, SALE DEED

THIS INDENTURE WITNESSETH: That **SUSAN E. HANLY, a married woman and spouse of Grantee herein**

in consideration of \$10.00, the receipt of which is hereby acknowledged, does hereby Grant, Bargain Sell and Convey to **LEO A. HANLY, a married man as his sole and separate property**

and to the heirs and assigns of such Grantee forever, all that real property situated in the County of **DOUGLAS** State of Nevada, bounded and described as :

SEE EXHIBIT "A" ATTACHED HERETO AND MADE A PART HEREOF

IT IS THE EXPRESS INTENT OF THE GRANTOR, BEING THE SPOUSE OF THE GRANTEE, TO CONVEY ALL RIGHT, TITLE AND INTEREST OF THE GRANTOR, COMMUNITY OR OTHERWISE, IN AND TO THE HEREIN DESCRIBED PROPERTY TO THE GRANTEE AS GRANTEE'S SOLE AND SEPARATE PROPERTY.

Together with all and singular the tenements, hereditaments and appurtenances thereunto belonging or in anywise appertaining, and any reversions, remainders, rents, issues or profits thereof.

DATE: **March 29, 2004**

[Signature]
SUSAN E. HANLY

STATE OF Nevada }
COUNTY OF DOUGLAS } ss.

This instrument was acknowledged before me on 3/29/04
by, SUSAN E. HANLY

Signature Donna Sue Hawkins
Notary Public (One Inch Margin on all sides of Document for Recorder's Use Only)



0609272

BK0404PG01257

EXHIBIT "A"

LEGAL DESCRIPTION

ESCROW NO.: 040300624

The land referred to herein is situated in the State of Nevada, County of DOUGLAS City of MINDEN described as follows:

Lot 2, in Block A, as set forth on that certain Final Map LDA #99-054-2 SUNRIDGE HEIGHTS III, PHASE 2, a Planned Unit Development, recorded in the office of the Douglas County Recorder on February 4, 2000 in Book 0200, Page 723, as Document No. 485729.

APN 1420-17-111-002

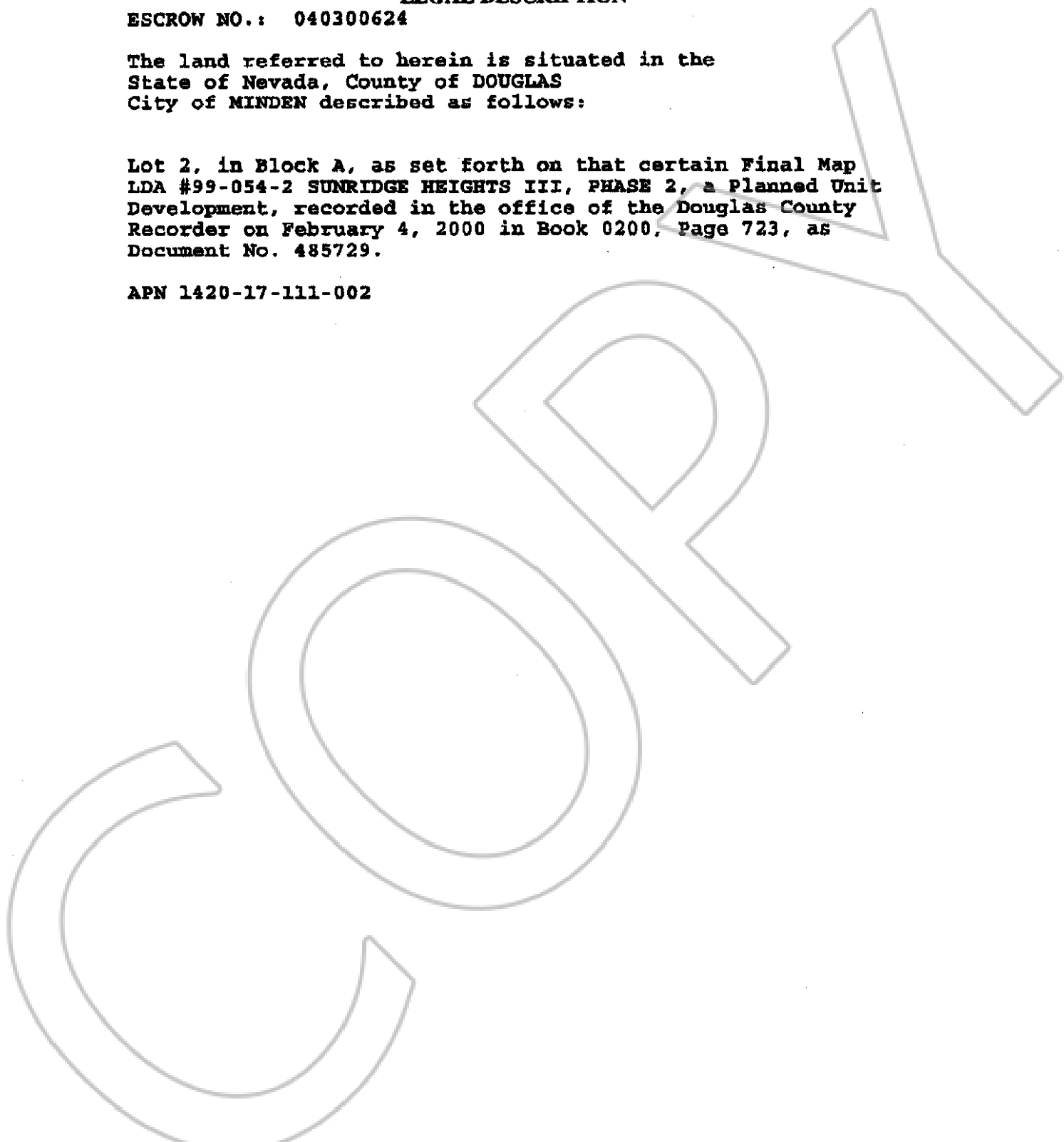

0609272

BK0404PG01258