

A.P.N. # 1320-30-210-001

R.P.T.T. \$ 0 #6  
ESCROW NO. 040100691

RECORDING REQUESTED BY:  
**STEWART TITLE COMPANY**  
MAIL TAX STATEMENTS TO:  
**SAME AS BELOW**

WHEN RECORDED MAIL TO:  
**ROWE**  
**P.O. BOX 503**  
**MINDEN, NV 89423**

REQUESTED BY  
**Stewart Title of Douglas County**  
IN OFFICIAL RECORDS OF  
DOUGLAS CO., NEVADA

2004 APR -5 AM 10:39

WERNER CHRISTEN  
RECORDER  
\$15.00 PAID *KJ* DEPUTY

(Space Above for Recorder's Use Only)

**GRANT, BARGAIN, SALE DEED**

THIS INDENTURE WITNESSETH: That **THE TRUSTEES OF THE ROWE FAMILY REVOCABLE TRUST, U.T.D. OCTOBER 17, 2000**

in consideration of \$10.00, the receipt of which is hereby acknowledged, does hereby Grant, Bargain Sell and Convey to **MICHAEL SMILEY ROWE AND SUZANNE KUES ROWE, HUSBAND AND WIFE AS JOINT TENANTS**

and to the heirs and assigns of such Grantee forever, all that real property situated in the County of **DOUGLAS** State of Nevada, bounded and described as:

**SEE EXHIBIT "A" ATTACHED HERETO AND MADE A PART HEREOF**

Together with all and singular the tenements, hereditaments and appurtenances thereunto belonging or in anywise appertaining, and any reversions, remainders, rents, issues or profits thereof.

DATE: **March 29, 2004**

THE TRUSTEES OF THE ROWE FAMILY  
REVOCABLE TRUST, U.D.T. OCTOBER  
17, 2000

*Michael Smiley Rowe, Jr*  
MICHAEL SMILEY ROWE, TRUSTEE

*Suzanne Kues Rowe trustee*  
SUZANNE KUES ROWE, TRUSTEE

STATE OF WV  
COUNTY OF Douglas } ss.

This instrument was acknowledged before me on 3/30/04  
by Michael Smiley Rowe and Suzanne Kues Rowe

Signature Suzanne Chee

Notary Public (One inch margin on all sides of document for Recorder's Use Only)



**SUZANNE CHEECHOV**  
NOTARY PUBLIC  
STATE OF NEVADA  
Appt. Recorded in Douglas County  
Appt. Expires June 25, 2007  
No. 99-38456-5

0609326

BK0404PG01517

**EXHIBIT "A"**

**LEGAL DESCRIPTION**

**ESCROW NO.: 040100691**

**The land referred to herein is situated in the  
State of Nevada, County of DOUGLAS  
City of MINDEN described as follows:**

**Lot 3, Block M, as shown on the Official Map of WESTWOOD  
VILLAGE UNIT NO. II, filed for record in the Office of the  
County Recorder of Douglas County, Nevada, on June 23,  
1988, as Document No. 180866.**

**Assessor's Parcel No. 1320-30-210-001**

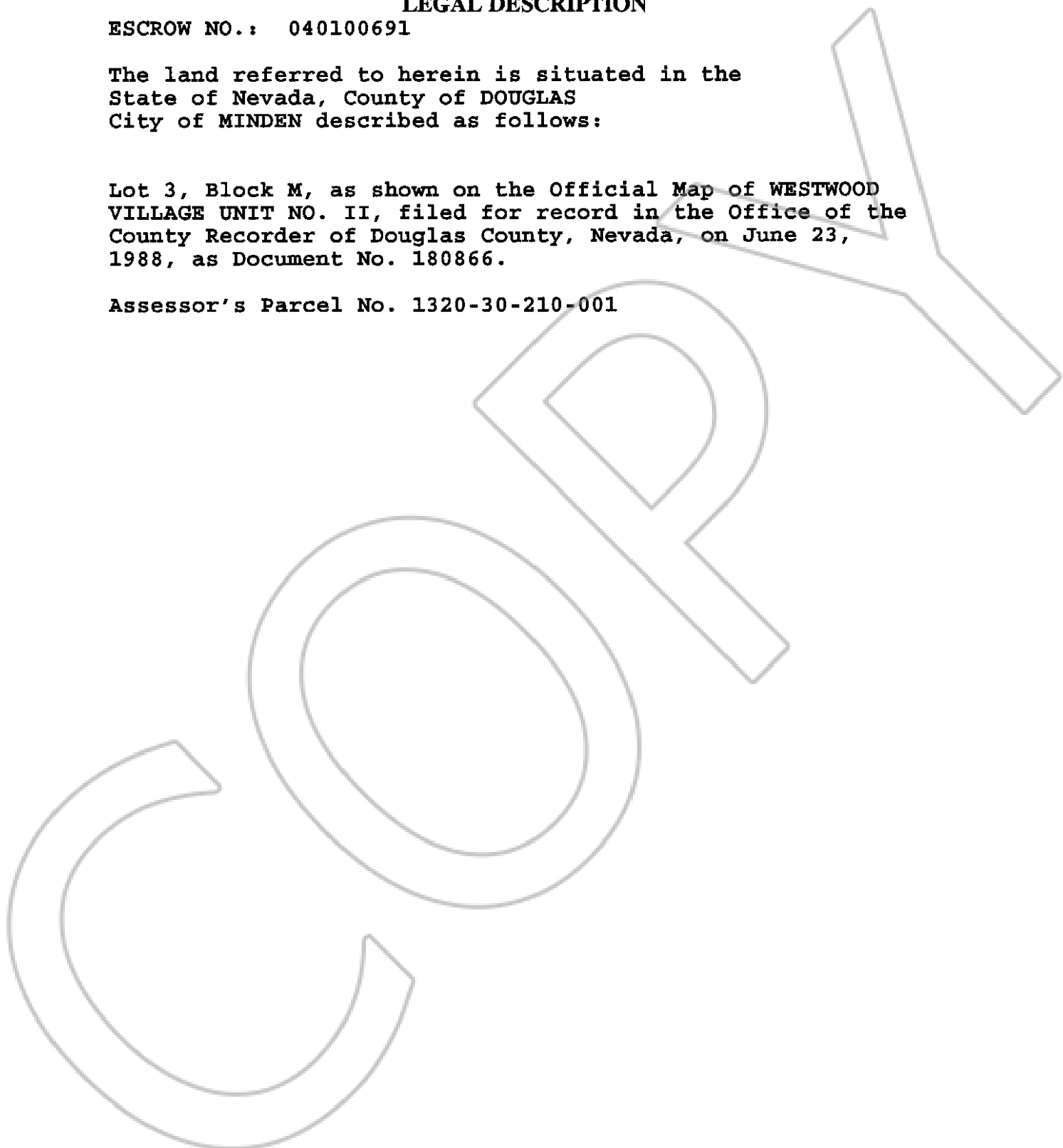

**0609326**

**BK0404PG01518**