

A.P.N. # 1220-21-710-022

R.P.T.T. \$ 943.80

ESCROW NO. 040800499

RECORDING REQUESTED BY:
STEWART TITLE COMPANY

MAIL TAX STATEMENTS TO:
SAME AS BELOW

WHEN RECORDED MAIL TO:
**GRANTEE
1322 LEONARD ROAD
GARDNERVILLE, NV**

REQUESTED BY

Stewart Title of Douglas County

IN OFFICIAL RECORDS OF
DOUGLAS CO., NEVADA

2004 APR -5 AM 10:41

WERNER CHRISTEN
RECORDER

\$ 15.00 PAID KJ DEPUTY

(Space Above for Recorder's Use Only)

GRANT, BARGAIN, SALE DEED

THIS INDENTURE WITNESSETH: That **ERNEST P. FLANAGAN, JR. and JULIE A. FLANAGAN, husband and wife**

in consideration of \$10.00, the receipt of which is hereby acknowledged, does hereby Grant, Bargain Sell and Convey to **CHRISTOPHER C. GARTON and MICHELLE A. GARTON, husband and wife, as joint tenants**

and to the heirs and assigns of such Grantee forever, all that real property situated in the County of **Douglas** State of Nevada, bounded and described as:

SEE EXHIBIT "A" ATTACHED HERETO AND MADE A PART HEREOF

Together with all and singular the tenements, hereditaments and appurtenances thereunto belonging or in anywise appertaining, and any reversions, remainders, rents, issues or profits thereof.

DATE: **March 17, 2004**

Ernest P. Flanagan Jr.
ERNEST P. FLANAGAN, JR.

Julie A. Flanagan
JULIE A. FLANAGAN

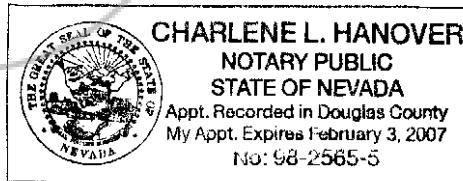

STATE OF NEVADA }
COUNTY OF DOUGLAS } ss.

This instrument was acknowledged before me on 3/30/2004,
by ERNEST P. FLANAGAN, JR. and JULIE A. FLANAGAN

Signature *Charlene L. Hanover*
Notary Public (One inch margin on all sides of document for Recorder's Use Only)

0609328

BK0404PG01534

EXHIBIT "A"

LEGAL DESCRIPTION

ESCROW NO.: 040800499

The land referred to herein is situated in the
State of Nevada, County of Douglas
City of GARDNERVILLE described as follows:

Lot 546, as shown on the map of GARDNERVILLE RANCHOS UNIT
NO. 7, filed for record in the office of the County
Recorder of Douglas County, Nevada, on March 27, 1974, as
Document No. 72456.

Assessors Parcel No. 1220-21-710-022

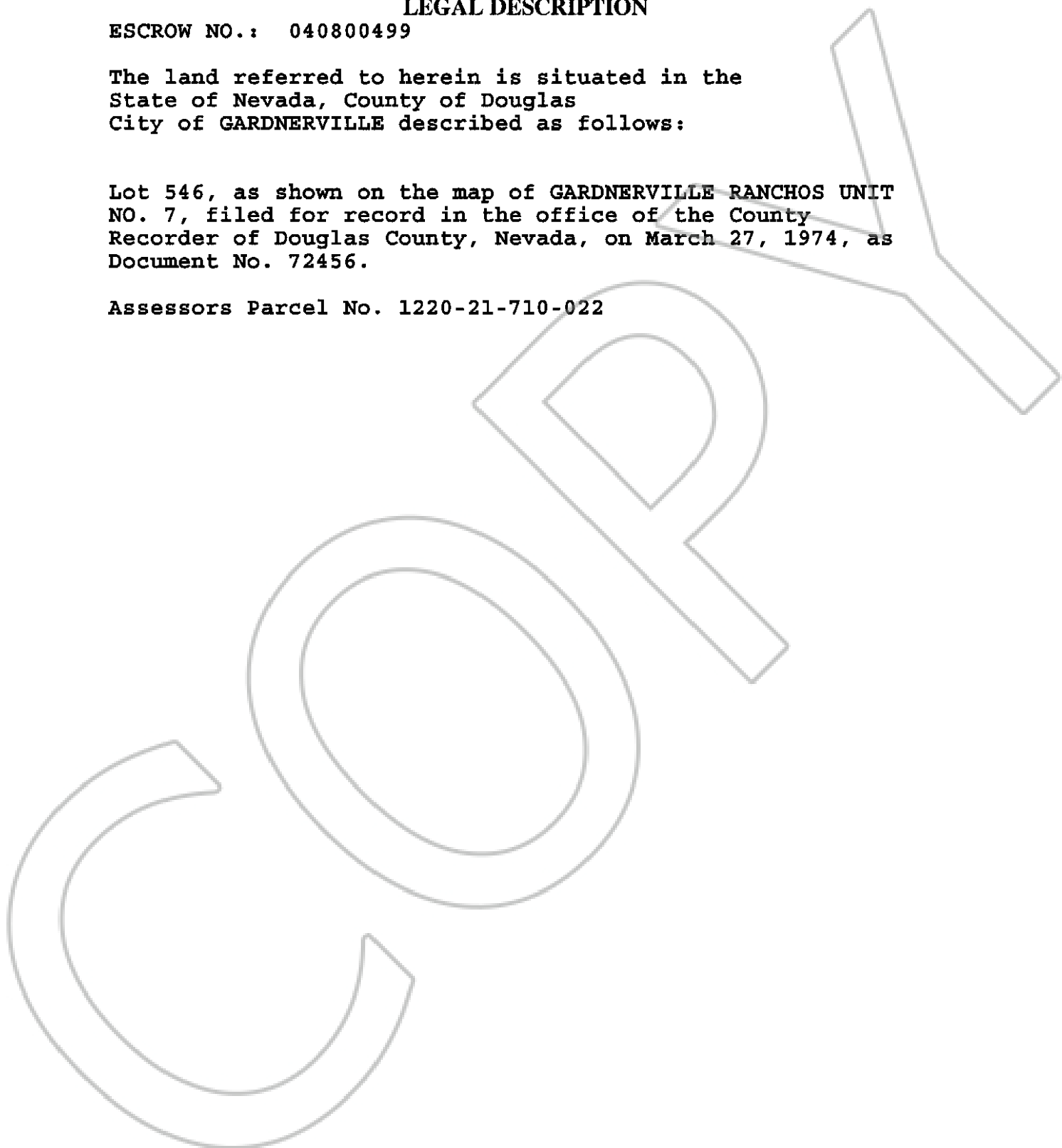

0609328

BK0404PG01535