

A.P.N. # 1220-21-810-248
R.P.T.T. \$ 838.50
ESCROW NO. 040800809
RECORDING REQUESTED BY:
STEWART TITLE COMPANY
MAIL TAX STATEMENTS TO:
SAME AS BELOW

WHEN RECORDED MAIL TO:
GRANTEE
2632 GORDON AVENUE
MINDEN, NV 89423

REQUESTED BY
Stewart Title of Douglas County

IN OFFICIAL RECORDS OF
DOUGLAS CO., NEVADA

2004 APR -5 PM 3:36

WERNER CHRISTEN
RECORDER

\$ 15.00 PAID KJ DEPUTY

(Space Above for Recorder's Use Only)

GRANT, BARGAIN, SALE DEED

THIS INDENTURE WITNESSETH: That **ROBERT STANCHFIELD and GINA M. STANCHFIELD, husband and wife**

in consideration of \$10.00, the receipt of which is hereby acknowledged, does hereby Grant, Bargain Sell and Convey to **RICK SIMONS, an unmarried man**

and to the heirs and assigns of such Grantee forever, all that real property situated in the County of **Douglas** State of Nevada, bounded and described as:
SEE EXHIBIT "A" ATTACHED HERETO AND MADE A PART HEREOF

Together with all and singular the tenements, hereditaments and appurtenances thereunto belonging or in anywise appertaining, and any reversions, remainders, rents, issues or profits thereof.

DATE: **March 23, 2004**

Robert Stanchfield
ROBERT STANCHFIELD

Gina M. Stanchfield
GINA M. STANCHFIELD

 **CHARLENE L. HANOVER**
NOTARY PUBLIC
STATE OF NEVADA
Appt. Recorded in Douglas County
My Appt. Expires February 3, 2007
No: 98-2565-5

STATE OF NEVADA }
 } ss.
COUNTY OF DOUGLAS }

This instrument was acknowledged before me on 4/2/2004,
by **ROBERT STANCHFIELD and GINA M. STANCHFIELD**

Signature Charlene L. Hanover
Notary Public (One inch margin on all sides of document for Recorder's Use Only)

0609382
BK0404PG01969

EXHIBIT "A"

LEGAL DESCRIPTION

ESCROW NO.: 040800809

**The land referred to herein is situated in the
State of Nevada, County of Douglas
City of GARDNERVILLE described as follows:**

**Lot 395, as shown on the map of GARDNERVILLE RANCHOS UNIT
NO. 7, filed for record in the office of the County
Recorder of Douglas County, Nevada, on March 27, 1974, as
Document No. 72456.**

Assessors Parcel No. 1220-21-810-248

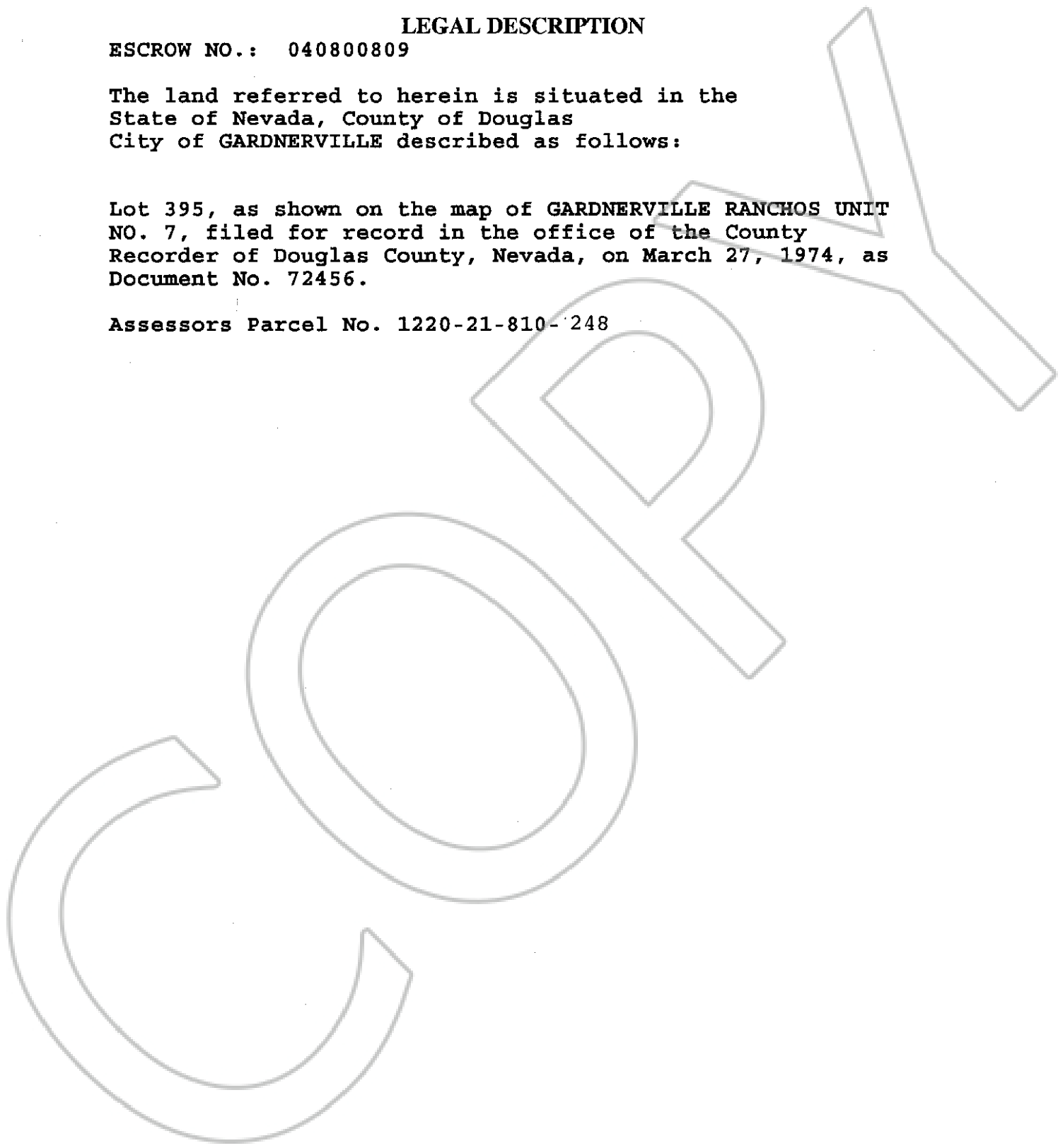

0609382

BK0404PG01970