

REQUESTED BY
FIRST CENTENNIAL TITLE CO.

IN OFFICIAL RECORDS OF
DOUGLAS CO., NEVADA

2004 APR -6 PM 3:05

WERNER CHRISTEN
RECORDER

\$15⁰⁰ PAID *KJ* DEPUTY

APN: 1220-16-412-004
Escrow No. 00127569 - KMM
RPTT \$1,131.00
When Recorded Return to:
Mr. Reese
1509 Rose Lane
Pleasanton, Ca 94566-6419

Mail Tax Statements to:

SPACE ABOVE FOR RECORDERS USE

Grant, Bargain, Sale Deed

THIS INDENTURE WITNESSETH: That CHARLOTTE SUE DEVINE SUCCESSOR TRUSTEE, of THE ATHELIN BARKSDALE SCOTT 1992 TRUST initially created July 22, 1992

In consideration of \$10.00, the receipt of which is hereby acknowledged, do(es) hereby Grant, Bargain, Sell and Convey to LAWRENCE REESE, A MARRIED MAN, AS HIS SOLE AND SEPARATE PROPERTY

all that real property situated in the County of Douglas, State of Nevada, described as follows:

See Exhibit A attached hereto and made a part hereof.

Together with all and singular the tenements, hereditaments and appurtenances thereunto belonging or in anywise appertaining.

Witness my/our hand(s) this 1st day of April, 2004

Charlotte Sue Devine Sue, TR
CHARLOTTE SUE DEVINE
SUCCESSOR TRUSTEE

STATE OF NEVADA
COUNTY OF DOUGLAS



This instrument was acknowledged before me on April 1, 2004,
by Charlotte Sue Devine

Kathy Macellari

SPACE BELOW FOR RECORDER

0609502

BK0404PG02626

Exhibit A

Lot 15, Block A, of the Final Map of RABBITBRUSH CORNERS, according to the map thereof, filed in the Office of the County Recorder of Douglas County, Nevada, on March 2, 1992, in Book 392, Page 01, as Document No. 272299.

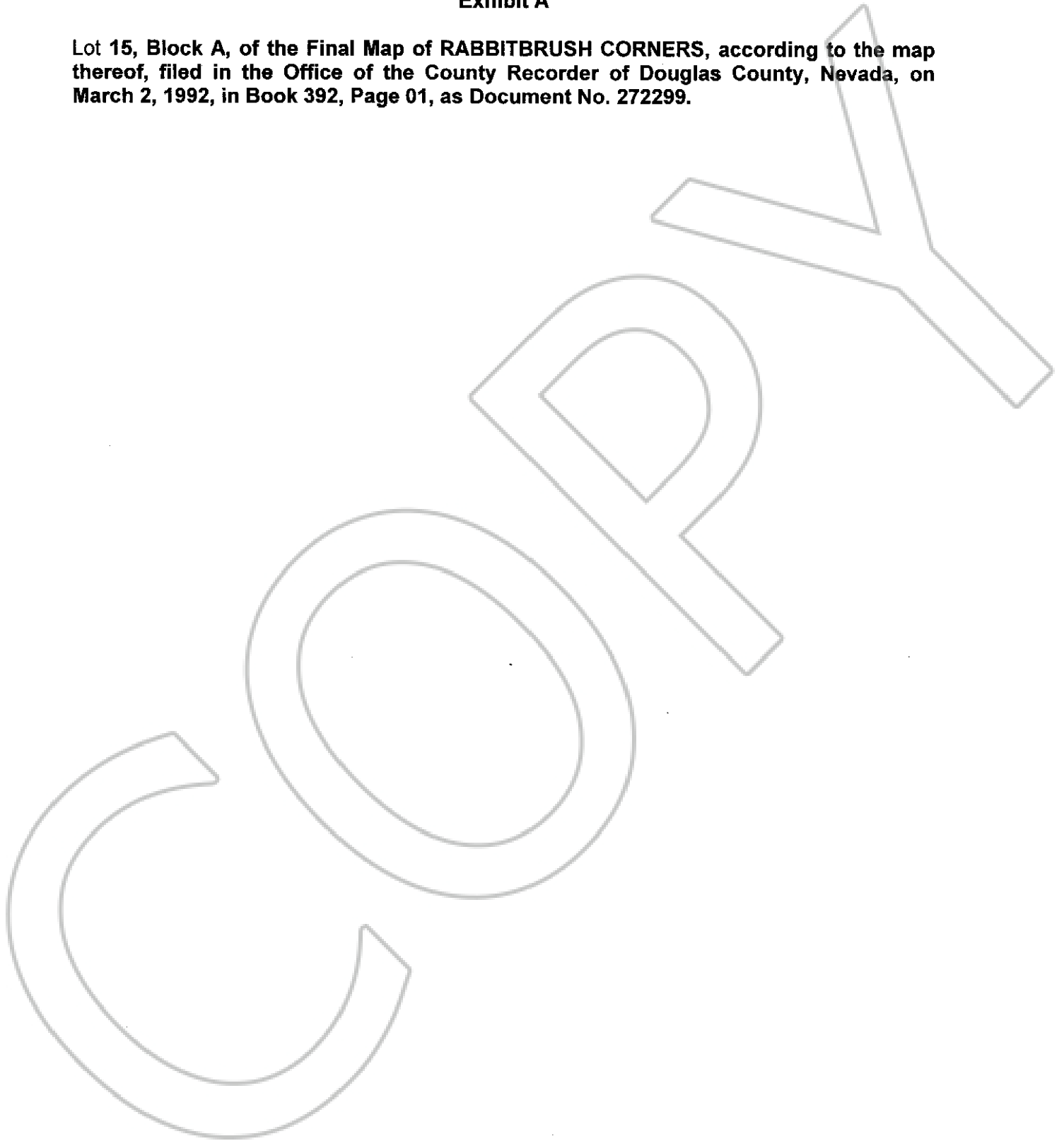

SPACE BELOW FOR RECORDER

0609502
BK0404PG02627