



**EXHIBIT "A"**

**LEGAL DESCRIPTION**

**ESCROW NO.: 040800460**

The land referred to herein is situated in the State of Nevada, County of Douglas City of GARDNERVILLE described as follows:

Lot 559, as shown on the official map of GARDNERVILLE RANCHOS UNIT NO. 6, filed for record on May 29, 1973, in the office of the County Recorder of Douglas County, Nevada as Document No. 66512.

Assessors Parcel No. 1220-21-610-114

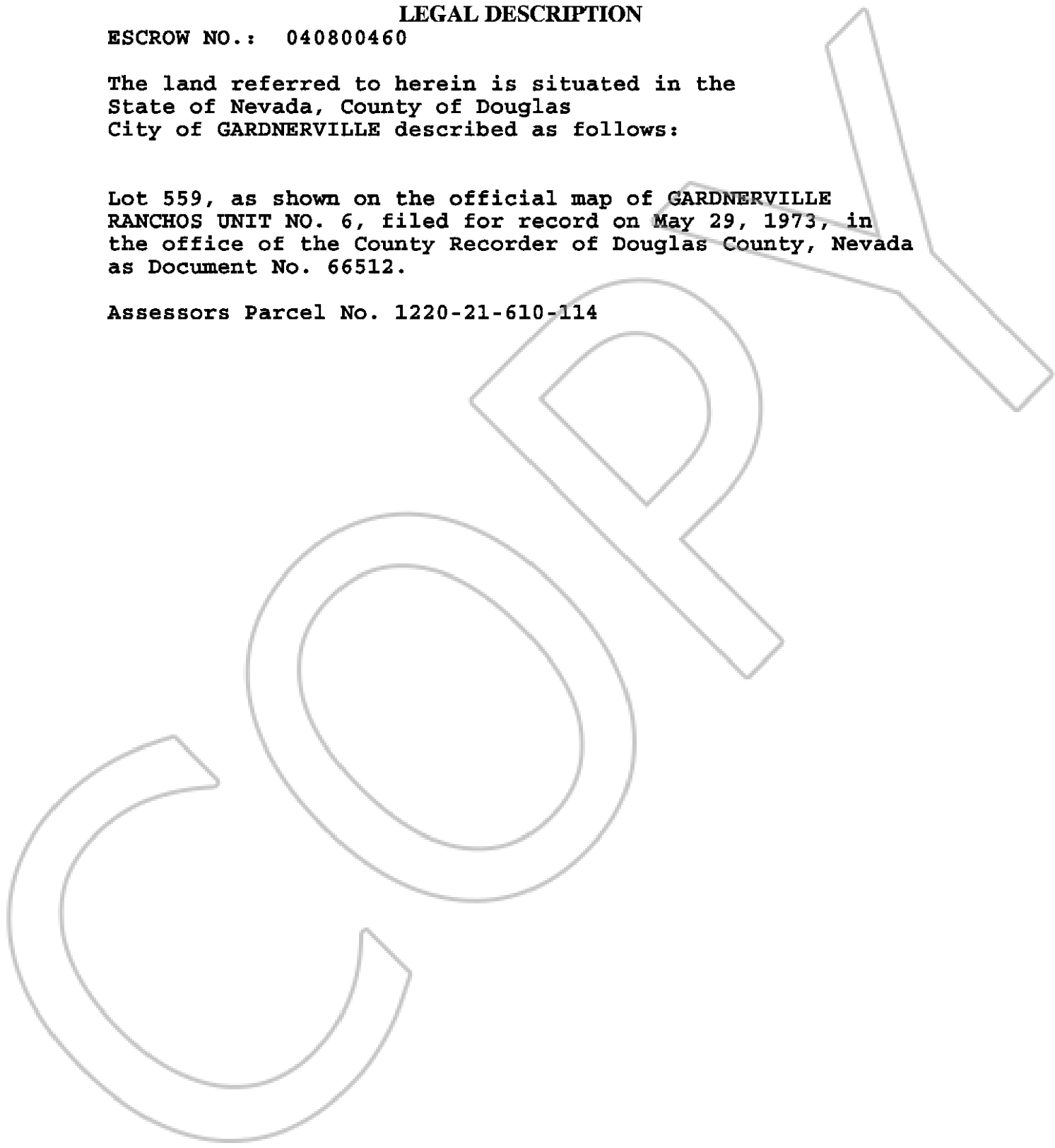

0609518

BK0404PG02724