

A.P.N. # 1320-29-117-030

R.P.T.T. \$ 1064.70

ESCROW NO. 040700712

RECORDING REQUESTED BY:  
**STEWART TITLE COMPANY**

MAIL TAX STATEMENTS TO:  
**SAME AS BELOW**

WHEN RECORDED MAIL TO:  
**GRANTEE**  
**443 BALLY WAY**  
**PACIFICA, CA 94044**

REQUESTED BY  
**Stewart Title of Douglas County**  
IN OFFICIAL RECORDS OF  
DOUGLAS CO., NEVADA

2004 APR -7 PM 4:01

WERNER CHRISTEN  
RECORDER

\$16<sup>50</sup> PAID Kg DEPUTY

(Space Above for Recorder's Use Only)

### GRANT, BARGAIN, SALE DEED

THIS INDENTURE WITNESSETH: That **WILLIAM C. OSBORNE**, as Trustee of  
the **WILLIAM C. OSBORNE TRUST**, dated December 2, 2003

in consideration of \$10.00, the receipt of which is hereby acknowledged, does hereby Grant, Bargain Sell  
and Convey to **IGOR KLEYNER and MARINA N. FASTOVSKAYA** HUSBAND AND  
**WIFE AS JOINT TENANTS**

and to the heirs and assigns of such Grantee forever, all that real property situated in the  
County of **Douglas** State of Nevada, bounded and described as:

**SEE EXHIBIT "A" ATTACHED HERETO AND MADE A PART HEREOF**

Together with all and singular the tenements, hereditaments and appurtenances thereunto belonging or in  
anywise appertaining, and any reversions, remainders, rents, issues or profits thereof.

DATE: **March 11, 2004**

**WILLIAM C. OSBORNE TRUST**  
**DATED DECEMBER 2, 2003**

BY:   
**WILLIAM C. OSBORNE**  
TRUSTEE

Witness #1

BY: 

Witness #2

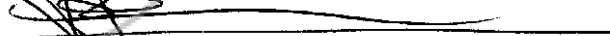
By: 

STATE OF California }  
  } ss.  
COUNTY OF Sacramento }

This instrument was acknowledged before me on \_\_\_\_\_  
by, **WILLIAM C. OSBORNE**

Signature See attached

Notary Public (One Inch Margin on all sides of Document for Recorders Use Only)

0609603

BK0404PG03183

# ALL-PURPOSE ACKNOWLEDGMENT

State of California }

County of Sacramento }

On March 20, 2004, before me, Julie S. McAndrew, Notary Public,  
(name, title of officer),  
personally appeared William C. Osborne

personally known to me - OR -  proved to me on the basis of satisfactory evidence to be the person(s) whose name(s) is/are subscribed to the within instrument and acknowledged to me that he/she/they executed the same in his/her/their authorized capacity(ies), and that by his/her/their signature(s) on the instrument the person(s), or the entity upon behalf of which the person(s) acted, executed the instrument.



WITNESS my hand and official seal.

Julie S. McAndrew  
Signature

**EXHIBIT "A"**

**LEGAL DESCRIPTION**

ESCROW NO.: 040700712

The land referred to herein is situated in the State of Nevada, County of Douglas City of MINDEN described as follows:

Unit 183, as shown on the official plat of WINHAVEN, UNIT NO. 5, filed for record in the office of the County Recorder of Douglas County, Nevada on February 10, 1994 in Book 294 of Official Records at page 1845, as Document No. 329790.

Assessor's Parcel No. 1320-29-117-030

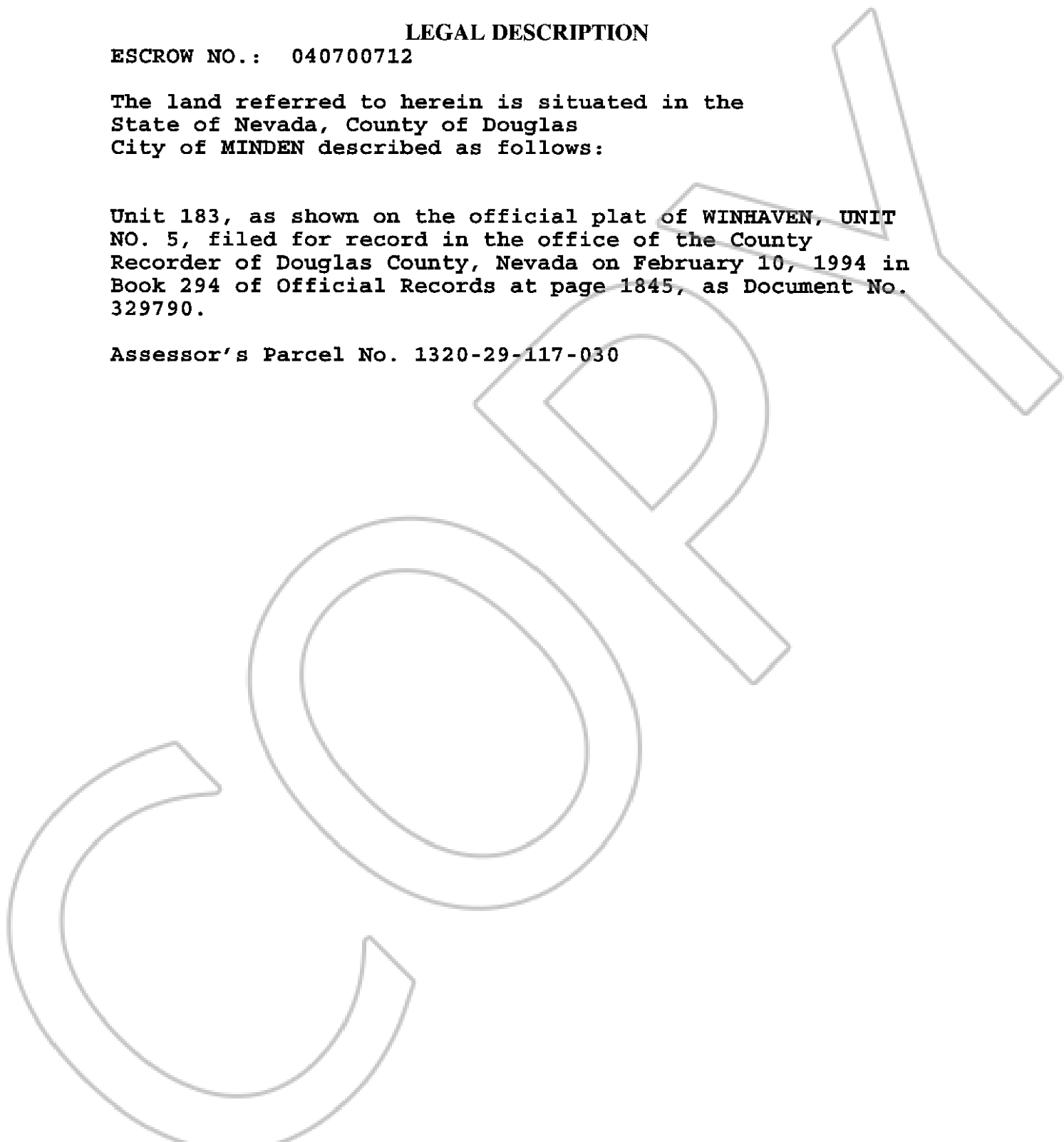

0609603

BK0404PG03185