



**EXHIBIT "A"**

**LEGAL DESCRIPTION**

**ESCROW NO.: 040101256**

The land referred to herein is situated in the  
State of Nevada, County of Douglas  
City of WELLINGTON described as follows:

Lot 31, as shown on the map of TOPAZ RANCH ESTATES UNIT NO.  
2, filed in the Office of the County Recorder of Douglas  
County, Nevada, on February 20, 1967, as Document No. 35464.

Assessor's Parcel No. 1022-10-001-065.

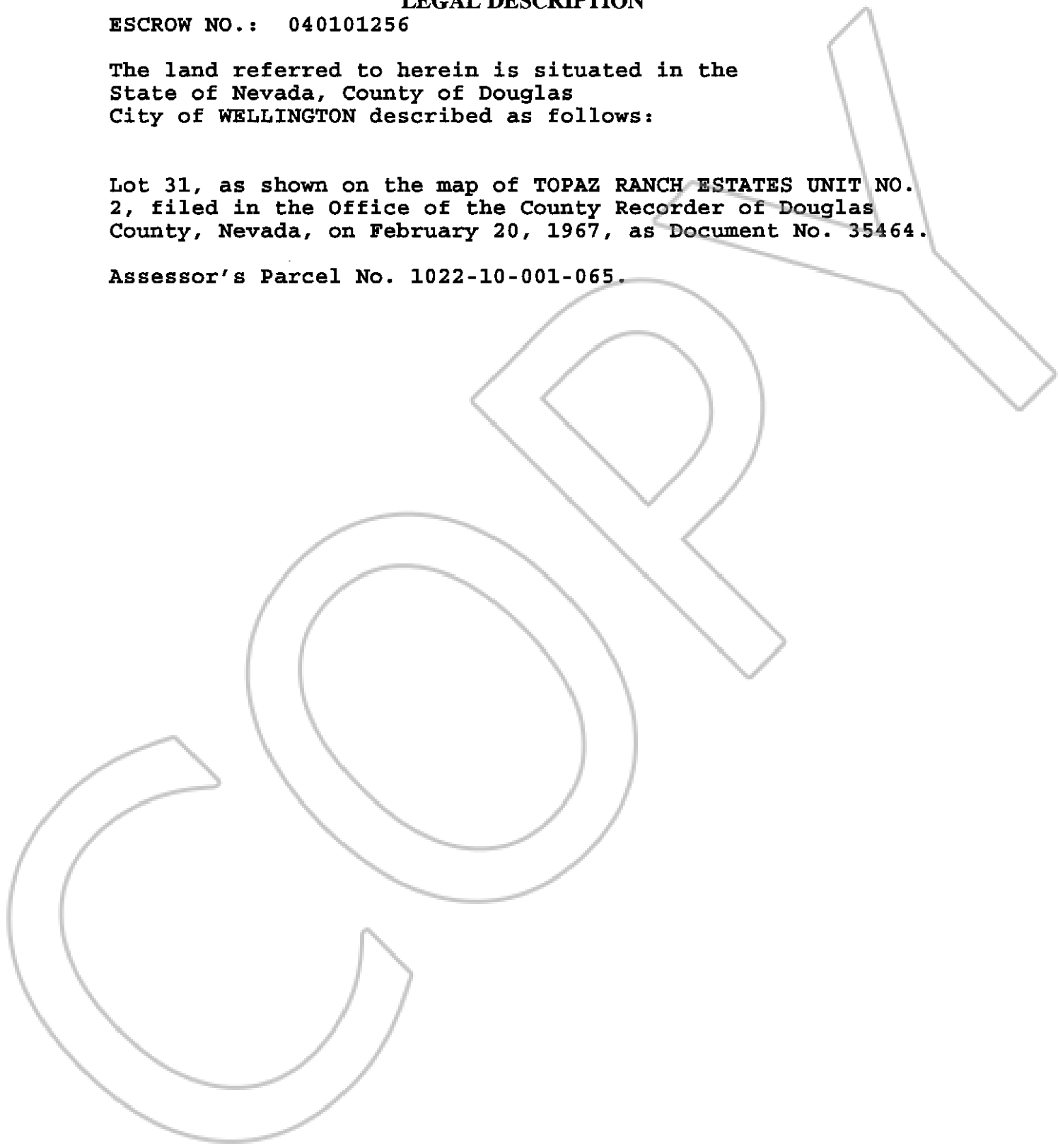

0610639

BK0404PG09000