

A.P.N. # 1219-15-002-056

R.P.T.T. \$ ⁶⁰795.00

ESCROW NO. 040101019

RECORDING REQUESTED BY:

STEWART TITLE COMPANY

MAIL TAX STATEMENTS TO:

SAME AS BELOW

WHEN RECORDED MAIL TO:

GRANTEE

401 MOTTSMVILLE LANE

GARDNERVILLE, NV 89460

REQUESTED BY
Stewart Title of Douglas County

IN OFFICIAL RECORDS OF
DOUGLAS CO., NEV. 017

2004 APR 19 PM 4:04

WERNER CHRISTEN
RECORDER

\$ ^{15.00} PAID Bl DEPUTY

(Space Above for Recorder's Use Only)

GRANT, BARGAIN, SALE DEED

THIS INDENTURE WITNESSETH: That **LISBETH T. SMITH**, a married woman
as her sole and separate property

in consideration of \$10.00, the receipt of which is hereby acknowledged, does hereby Grant, Bargain Sell
and Convey to **MIKE HICKEY CONSTRUCTION, INC., A NEVADA CORPORATION**

and to the heirs and assigns of such Grantee forever, all that real property situated in the
County of **Douglas** State of Nevada, bounded and described as:

SEE EXHIBIT "A" ATTACHED HERETO AND MADE A PART HEREOF

Together with all and singular the tenements, hereditaments and appurtenances thereunto belonging or in
anywise appertaining, and any reversions, remainders, rents, issues or profits thereof.

DATE: **April 01, 2004**

Lisbeth T. Smith
LISBETH T. SMITH

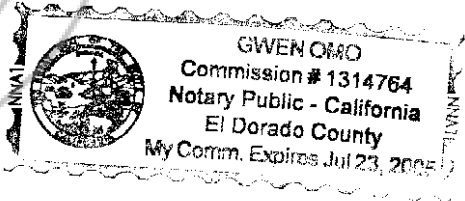

STATE OF CA }

COUNTY OF El Dorado } ss.

This instrument was acknowledged before me on 4/16/04
by LISBETH T. SMITH

Signature Gwen Omo
Notary Public (One inch margin on all sides of document for Recorder's Use Only)

0610640

BK 0404 PG 09001

EXHIBIT "A"

LEGAL DESCRIPTION

ESCROW NO.: 040101019

The land referred to herein is situated in the State of Nevada, County of Douglas City of GARDNERVILLE described as follows:

Parcel 4C as set forth on Parcel Map #1 LDA 01-013 for MIKIM DEVELOPMENT, filed in the office of the County Recorder of Douglas County, State of Nevada, on August 13, 2002 in Book 0802, at Page 3354, as Document No. 549321.

Assessor's Parcel No. 1219-15-002-056

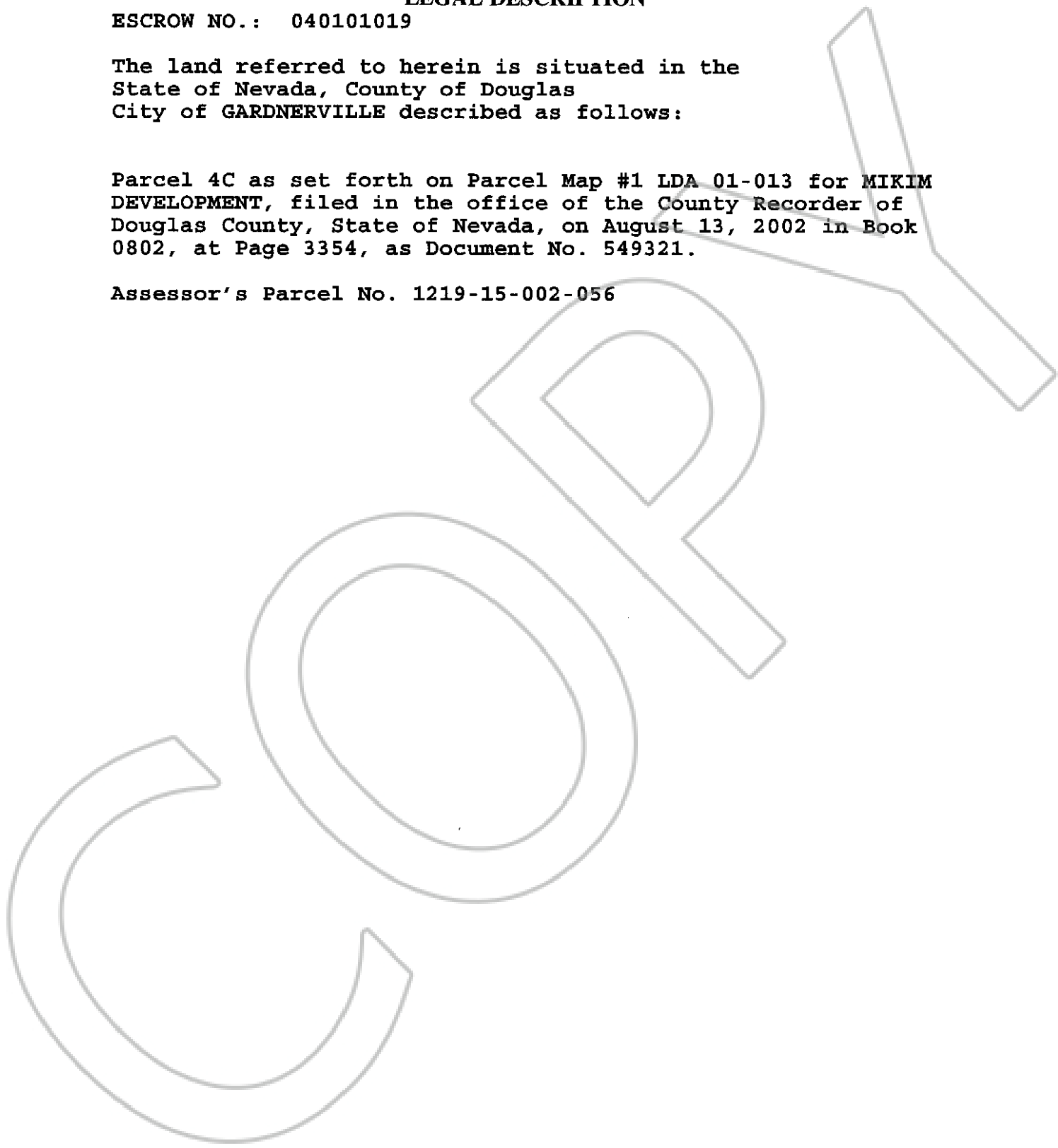

0610640

BK0404PG09002