

-15

REQUESTED BY  
Donna Shawhan  
IN OFFICIAL RECORDS OF  
DOUGLAS CO., NEVADA

APN: 1220-16-101-015

2004 APR 22 PM 1:54

WHEN RECORDED MAIL TO GRANTEE:  
MAIL TAX STATEMENTS TO:

WERNER CHRISTEN  
RECORDER

✓ SHARON ANN VARGAS  
966 CASEY LANE  
GARDNERVILLE, NEVADA 89460

\$ 15.00 PAID CF DEPUTY

RPTT,  
#6

**QUITCLAIM DEED**

For good and valuable consideration, the receipt of which is hereby acknowledged, SHARON ANN VARGAS, a married woman as her sole and separate property does hereby quitclaim to SHARON ANN VARGAS, as Trustee of the "SHARON ANN VARGAS REVOCABLE TRUST" dated NOV 18, 2003, all that real property situate in the County of Douglas, State of Nevada, described as follows:

SEE EXHIBIT "A," ATTACHED HERETO

TOGETHER with all and singular the tenements, hereditaments and appurtenances thereunto belonging or in anywise appertaining. Subject to all covenants, conditions, taxes, restrictions, reservations, rights, rights of way and easements now of record.

DATED this 22 day of April, 2004.

[Signature]  
SHARON ANN VARGAS

STATE OF NEVADA

COUNTY OF DOUGLAS

On this 22 day of April, 2004, before me, a notary public, personally appeared SHARON ANN VARGAS, personally known to me (or proved to me on the basis of satisfactory evidence), to be the person whose name is subscribed to the within instrument and acknowledged to me that she executed the same in his authorized capacity, and that by her signature on the instrument, the person or entity upon behalf of which person acted, executed the instrument.

[Signature]  
NOTARY PUBLIC

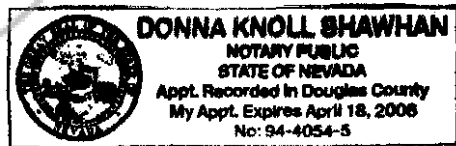

0610919

BK0404PG10688

EXHIBIT "A"

All that certain parcel of real property located in the county of Douglas, state of Nevada, and more particularly described as follows:

Being a portion of the Northwest  $\frac{1}{4}$  of Section 16, Township 12 North, Range 20 East, M.D.B.&M., more particularly described as follows:

Parcel 1-B of that certain Parcel Map for JAMES C. and CHRISTINA POWERS, recorded April 30, 1992, in Book 492 of Official Records, at Page 6355, Douglas County, Nevada, as Document No. 277597.

Being Assessor's Parcel Number 1220-16-101-015.

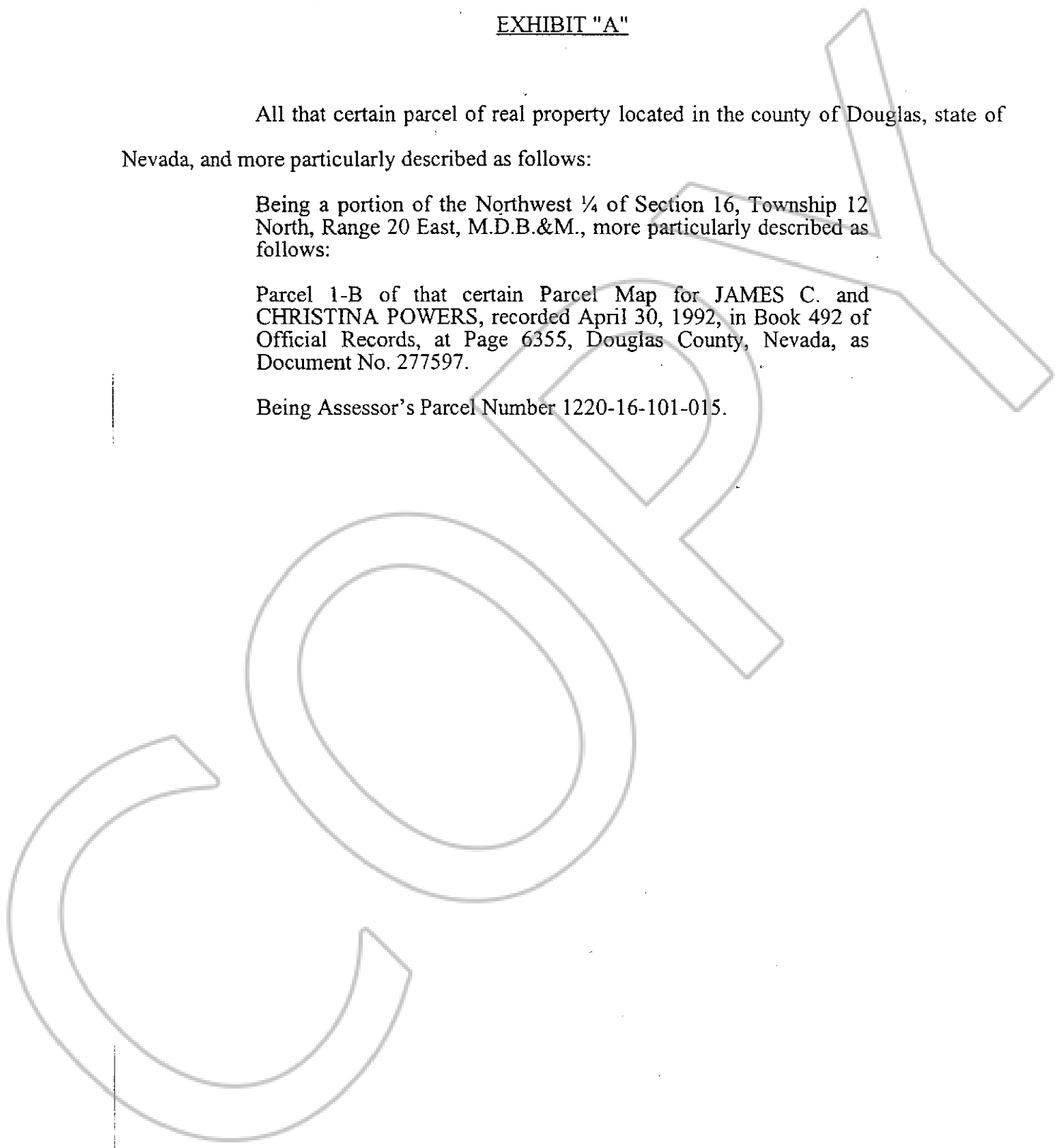

0610919

BK0404PG10689