

A.P.N. # 1320-29-114-006

R.P.T.T. \$ 1443.00

ESCROW NO. 040701069

RECORDING REQUESTED BY:  
**STEWART TITLE COMPANY**

MAIL TAX STATEMENTS TO:  
**SAME AS BELOW**

WHEN RECORDED MAIL TO:  
**GRANTEE**  
P.O. BOX 1191  
MINDEN, NV 89423

REQUESTED BY  
**Stewart Title of Douglas County**  
IN OFFICIAL RECORDS OF  
DOUGLAS COUNTY, NEVADA

2004 APR 23 AM 11:43

WERNER CHRISTEN  
RECORDER

\$ 15.00 PAID KJ DEPUTY

(Space Above for Recorder's Use Only)

### GRANT, BARGAIN, SALE DEED

THIS INDENTURE WITNESSETH: That **DON M. CIVIS and MARIE E. CIVIS,**  
husband and wife

in consideration of \$10.00, the <sup>M.</sup>receipt of which is hereby acknowledged, does hereby Grant, Bargain Sell  
and Convey to **ARNALDO PHELAN and DAYNA L. PHELAN,** husband and  
wife as Joint Tenants

and to the heirs and assigns of such Grantee forever, all that real property situated in the  
County of **Douglas** State of Nevada, bounded and described as:

**SEE EXHIBIT "A" ATTACHED HERETO AND MADE A PART HEREOF**

Together with all and singular the tenements, hereditaments and appurtenances thereunto belonging or in  
anywise appertaining, and any reversions, remainders, rents, issues or profits thereof.

DATE: **April 05, 2004**

*Don M. Civis*

**DON M. CIVIS**

*Marie E. Civis*

**MARIE E. CIVIS**

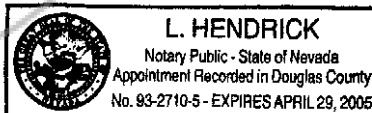

STATE OF Nevada }  
COUNTY OF Douglas } ss.

This instrument was acknowledged before me on 4-13-04  
by **DON M. CIVIS and MARIE E. CIVIS**

Signature L. Hendrick

Notary Public (One inch margin on all sides of document for Recorder's Use Only)

0611073

BK0404PG11429

**EXHIBIT "A"**

**LEGAL DESCRIPTION**

ESCROW NO.: 040701069

The land referred to herein is situated in the  
State of Nevada, County of Douglas  
City of MINDEN described as follows:

Lot 280, as set forth on the Official Plat of WINHAVEN, UNIT NO.  
3, a Planned Unit Development filed for record in the office of  
the County Recorder of Douglas County, State of Nevada, on  
December 18, 1992 as Document No. 295672.

Assessors Parcel No. 1320-29-114-006

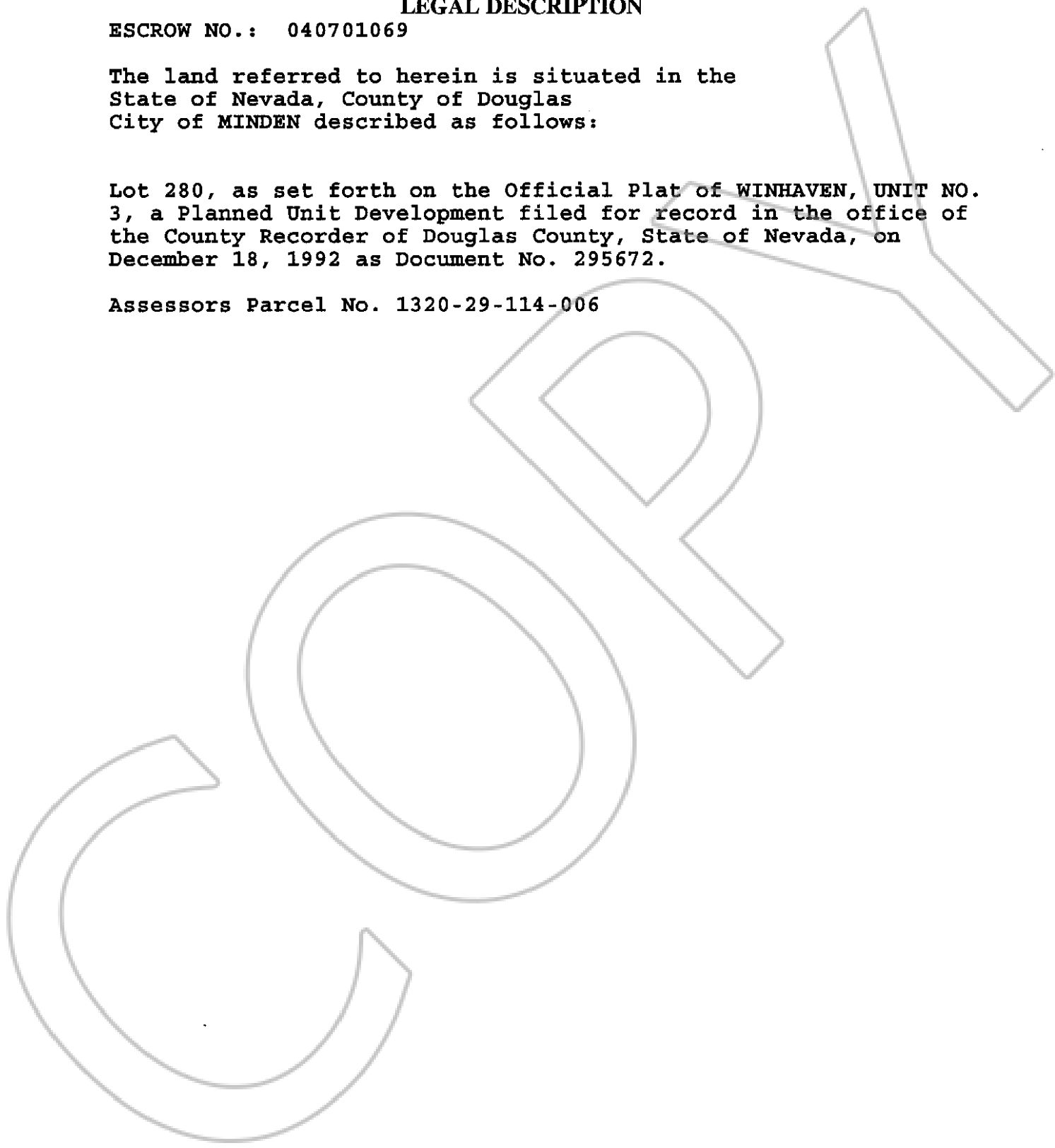

0611073

BK0404PG11430