

A.P.N. # 1319-18-214-006

R.P.T.T. \$ # 5
ESCROW NO. 040200189

RECORDING REQUESTED BY:
STEWART TITLE COMPANY

MAIL TAX STATEMENTS TO:
BRIAN KNOWLES
37997 Millwood DR
WOODLAKE CA 93286

WHEN RECORDED MAIL TO:
BRIAN KNOWLES
37997 Millwood DR
WOODLAKE CA 93286

REQUESTED BY
Stewart Title of Douglas County

IN OFFICIAL RECORDS OF
DOUGLAS CO., NEVADA

2004 APR 26 PM 3:54

WERNER CHRISTEN
RECORDER

\$15⁰⁰ PAID KJ DEPUTY

(Space Above for Recorder's Use Only)

GRANT, BARGAIN, SALE DEED

THIS INDENTURE WITNESSETH: That **DAWN KNOWLES**

in consideration of \$10.00, the receipt of which is hereby acknowledged, does hereby Grant, Bargain Sell and Convey to **BRIAN KNOWLES, A MARRIED MAN AS HIS SOLE AND SEPARATE PROPERTY**

and to the heirs and assigns of such Grantee forever, all that real property situated in the **unincorporated area** County of **DOUGLAS** State of Nevada, bounded and described as :

SEE EXHIBIT "A" ATTACHED HERETO AND MADE A PART HEREOF

IT IS THE EXPRESS INTENT OF THE GRANTOR, BEING THE SPOUSE OF THE GRANTEE, TO CONVEY ALL RIGHT, TITLE AND INTEREST OF THE GRANTOR, COMMUNITY OR OTHERWISE, IN AND TO THE HEREIN DESCRIBED PROPERTY TO THE GRANTEE AS GRANTEE'S SOLE AND SEPARATE PROPERTY.

Together with all and singular the tenements, hereditaments and appurtenances thereunto belonging or in anywise appertaining, and any reversions, remainders, rents, issues or profits thereof.

DATE: **April 22, 2004**

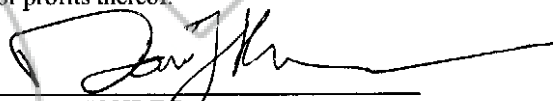

DAWN KNOWLES

STATE OF California }
COUNTY OF Tulare } ss.

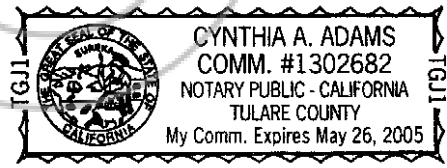

This instrument was acknowledged before me on April 22, 2004
by DAWN KNOWLES

Signature Cynthia A. Adams
Notary Public (One Inch Margin on all sides of Document for Recorder's Use Only)

0611275
BK0404PG12671

EXHIBIT "A"

LEGAL DESCRIPTION

ESCROW NO.: 040200189

The land referred to herein is situated in the State of Nevada, County of DOUGLAS City of STATELINE described as follows:

Lot 6, as shown on the map of CHALET VILLAGE, filed in the office of the County Recorder of Douglas County, State of Nevada, on October 25, 1977, as Document No. 14332, Official Records of Douglas County, State of Nevada.

Assessors Parcel No. 1319-18-214-006

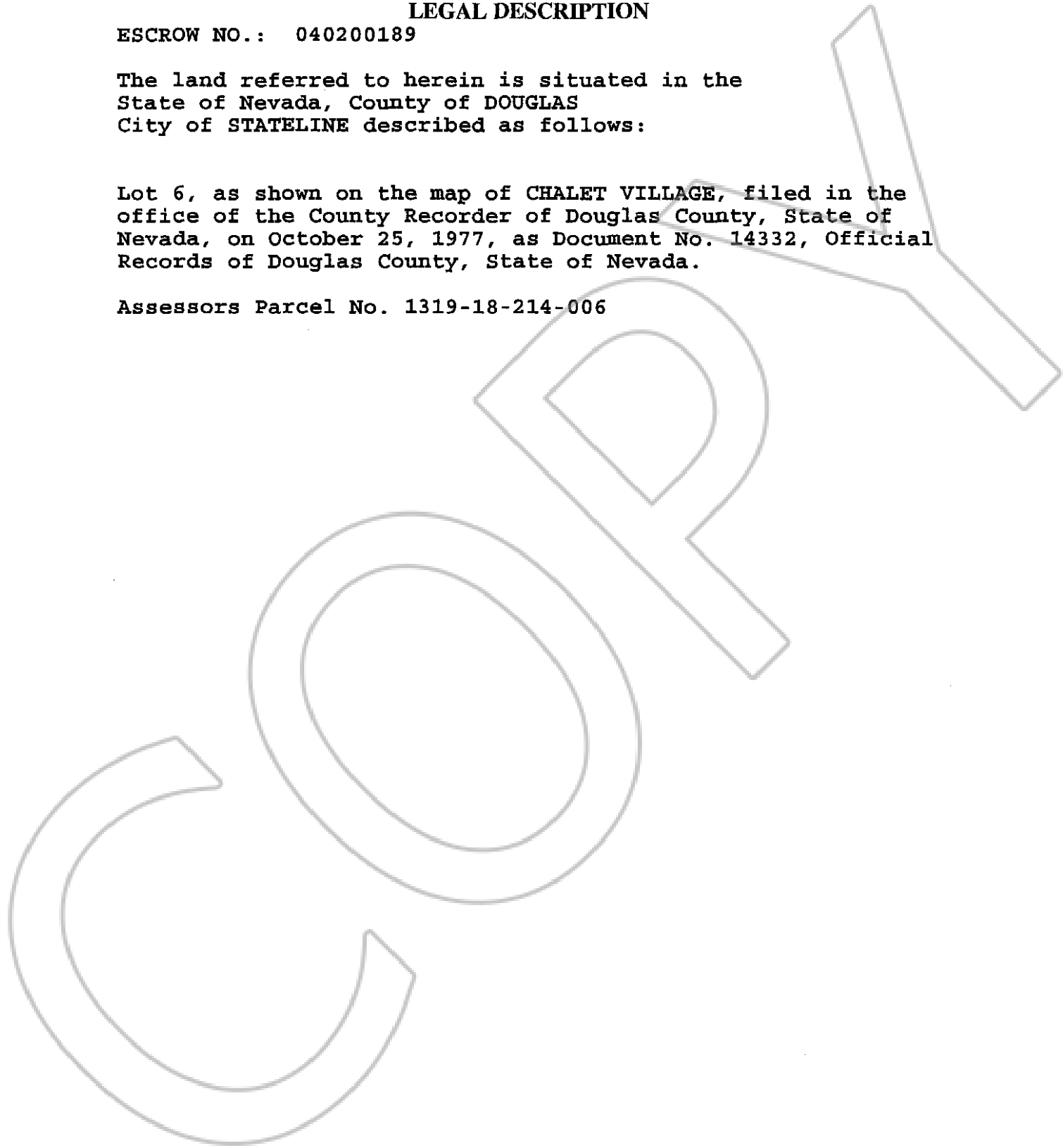

0611275
BK0404 PG12672