

A.P.N. # 1220-21-510-046

R.P.T.T. \$ 986.70

ESCROW NO. 040100696

RECORDING REQUESTED BY:

STEWART TITLE COMPANY

MAIL TAX STATEMENTS TO:

SAME AS BELOW

WHEN RECORDED MAIL TO:

GRANTEE

3552 PLEASANT ECHO DRIVE

SAN JOSE, CA 95148

REQUESTED BY
Stewart Title of Douglas County

IN OFFICIAL RECORDS OF
DOUGLAS CO., NEVADA

2004 APR 28 AM 10:45

WERNER CHRISTEN
RECORDER

\$ 15⁰⁰ PAID KJ DEPUTY

(Space Above for Recorder's Use Only)

GRANT, BARGAIN, SALE DEED

THIS INDENTURE WITNESSETH: That **JOANN B. NUNES, an unmarried woman**
and **GLADYS MATHERS, a single woman**

in consideration of \$10.00, the receipt of which is hereby acknowledged, does hereby Grant, Bargain Sell
and Convey to **FRANK A. YARWASKY and CAROLYN J. YARWASKY, husband**
and wife AS JOINT TENANTS WITH RIGHTS OF SURVIVORSHIP

and to the heirs and assigns of such Grantee forever, all that real property situated in the
County of **Douglas** State of Nevada, bounded and described as:

SEE EXHIBIT "A" ATTACHED HERETO AND MADE A PART HEREOF

Together with all and singular the tenements, hereditaments and appurtenances thereunto belonging or in
anywise appertaining, and any reversions, remainders, rents, issues or profits thereof.

DATE: **March 24, 2004**

Joann B. Nunes
JOANN B. NUNES

Gladys Mathers
GLADYS MATHERS

 **SUZANNE CHEECHOV**
NOTARY PUBLIC
STATE OF NEVADA
Appt. Recorded in Douglas County
My Appt. Expires June 25, 2007
No: 99-36456-5

STATE OF *NV* }
COUNTY OF *Douglas* } ss.

This instrument was acknowledged before me on *4/23/04*
by **JOANN B. NUNES and GLADYS MATHERS**

Signature *Suzanne Cheechov*
Notary Public (One inch margin on all sides of document for Recorder's Use Only)

0611556
BK0404PG13867

EXHIBIT "A"

LEGAL DESCRIPTION

ESCROW NO.: 040100696

**The land referred to herein is situated in the
State of Nevada, County of Douglas
City of GARDNERVILLE described as follows:**

**Lot 106, as shown on the official map of GARDNERVILLE
RANCHOS UNIT NO. 6, filed for record on May 29, 1973, in
the office of the County Recorder of Douglas County, Nevada
as Document No. 66512.**

Assessors Parcel No. 1220-21-510-046

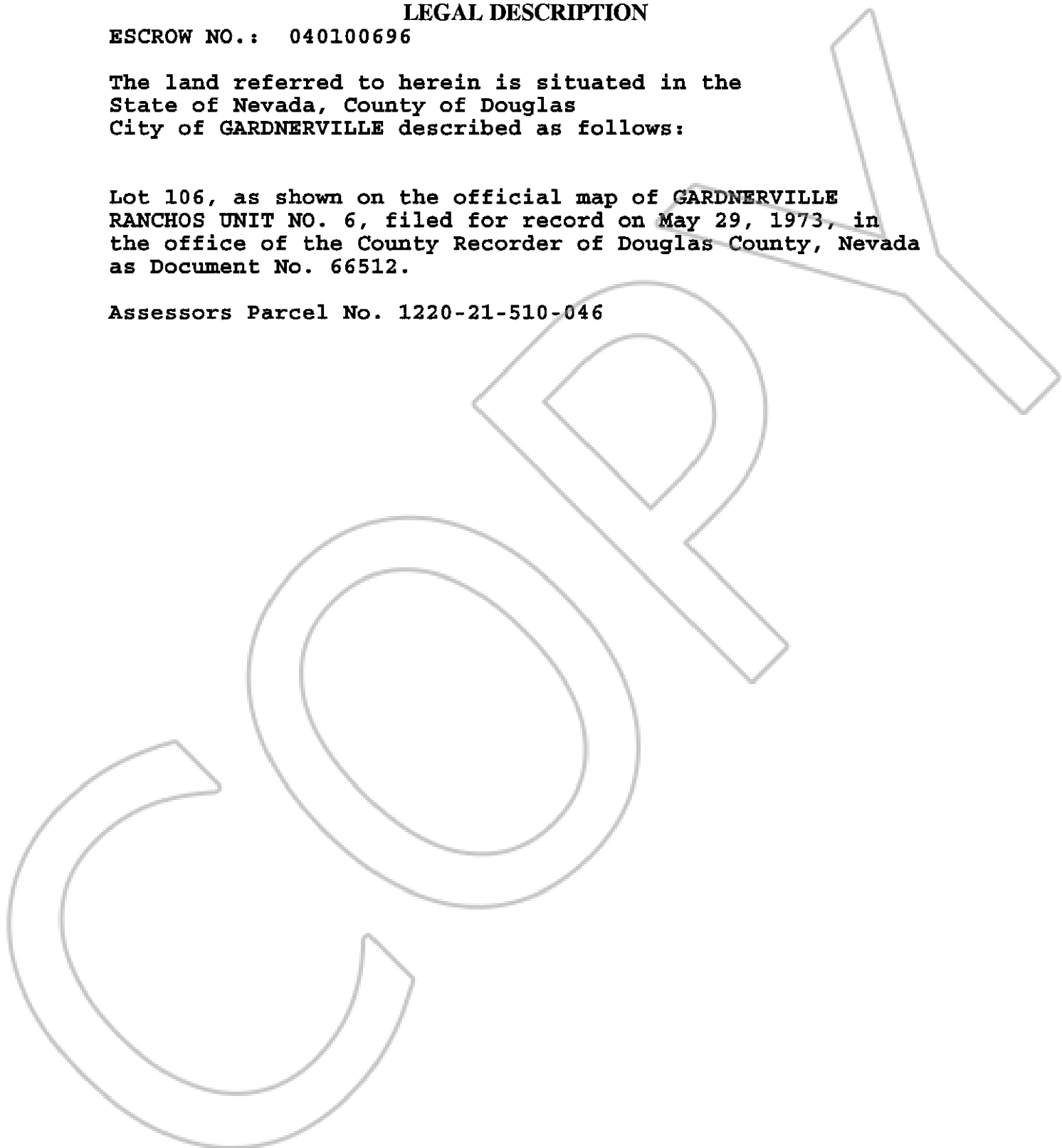

0611556

BK0404PG13868