

EXHIBIT "A"

LEGAL DESCRIPTION

ESCROW NO.: 040200906

The land referred to herein is situated in the State of Nevada, County of Douglas City of STATELINE described as follows:

Lot 441, as shown on the Amended Map of SUMMIT VILLAGE recorded in the Office of the County Recorder of Douglas County, Nevada, on September 17, 1968, as Document No. 42231, and on SECOND AMENDED MAP recorded on January 13, 1969, as Document No. 43419, Official Records of Douglas County, Nevada.

Assessor's Parcel No. 1319-19-710-027

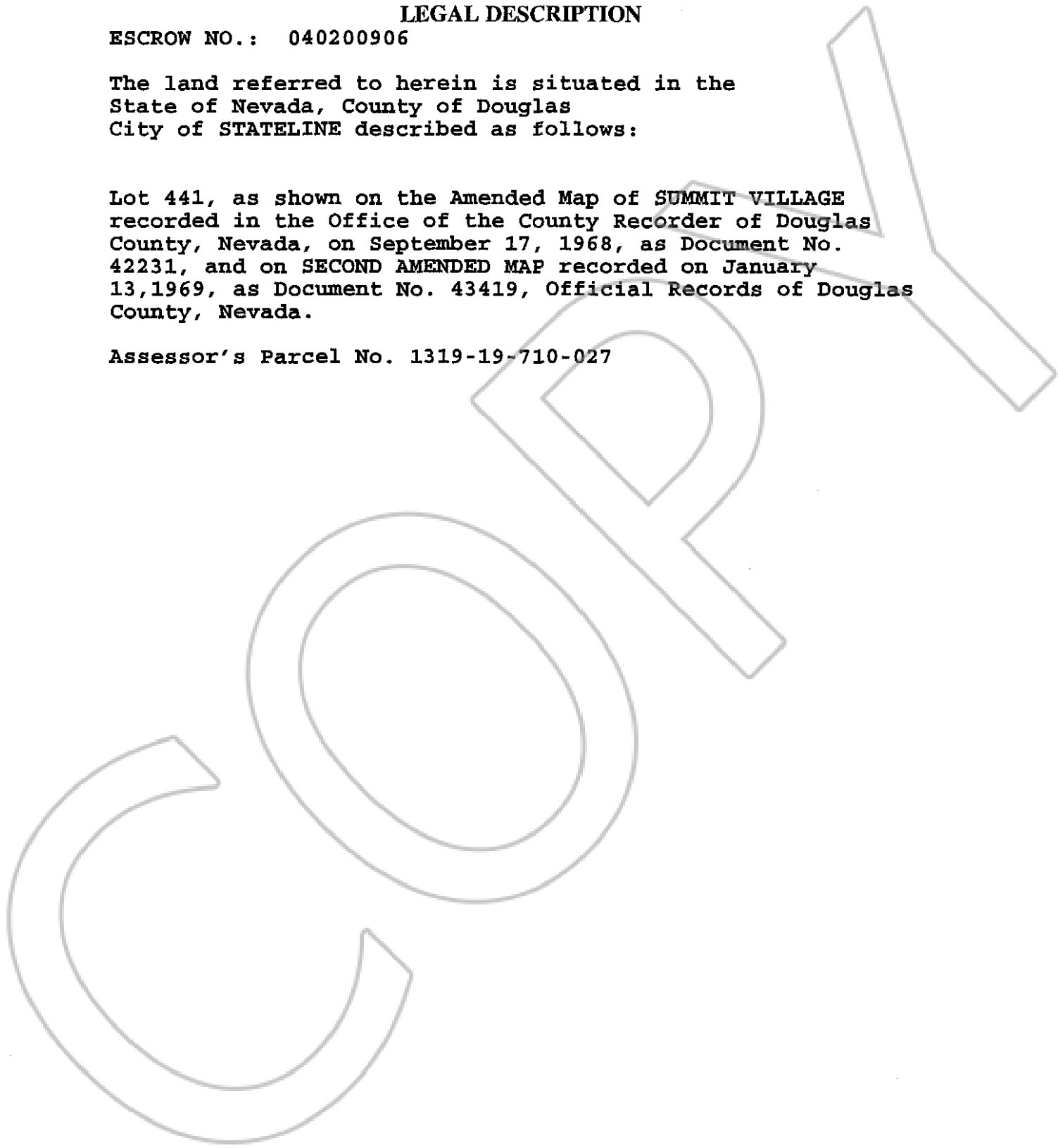

0611785
BK0404PG14906