

A.P.N. # 1320-31-516-008

R.P.T.T.S. 0 HS  
ESCROW NO. 040300414

RECORDING REQUESTED BY:  
**STEWART TITLE COMPANY**  
MAIL TAX STATEMENTS TO:  
**SAME AS BELOW**

WHEN RECORDED MAIL TO:  
**CURTIS W. FRANK**  
**P.O. BOX 214**  
**MINDEN, NV 89423**

REQUESTED BY  
**Stewart Title of Douglas County**

IN OFFICIAL RECORDS OF  
DOUGLAS CO., NEVADA

2004 APR 29 PM 3:40

WERNER CHRISTEN  
RECORDER

\$ 150 PAID re DEPUTY

(Space Above for Recorder's Use Only)

**GRANT, BARGAIN, SALE DEED**

THIS INDENTURE WITNESSETH: That **BEVERLY E. JOHNSON-FRANK**, a  
**married woman and spouse of Grantee herein**

in consideration of \$10.00, the receipt of which is hereby acknowledged, does hereby Grant, Bargain Sell  
and Convey to **CURTIS W. FRANK**, a **married man as his sole and**  
**separate property**

and to the heirs and assigns of such Grantee forever, all that real property situated in the  
County of **DOUGLAS** State of Nevada, bounded and described as :

**SEE EXHIBIT "A" ATTACHED HERETO AND MADE A PART HEREOF**

IT IS THE EXPRESS INTENT OF THE GRANTOR, BEING THE SPOUSE OF THE GRANTEE, TO  
CONVEY ALL RIGHT, TITLE AND INTEREST OF THE GRANTOR, COMMUNITY OR OTHERWISE,  
IN AND TO THE HEREIN DESCRIBED PROPERTY TO THE GRANTEE AS GRANTEE'S SOLE AND  
SEPARATE PROPERTY.

Together with all and singular the tenements, hereditaments and appurtenances thereunto belonging or in  
anywise appertaining, and any reversions, remainders, rents, issues or profits thereof.

DATE: **April 26, 2004**

*Beverly E. Johnson-Frank*  
**BEVERLY E. JOHNSON-FRANK**

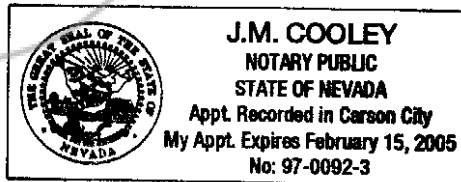

STATE OF Nevada }  
COUNTY OF DOUGLAS } ss.

This instrument was acknowledged before me on 4-26-04  
by, **BEVERLY E. JOHNSON-FRANK**

Signature J.M. Cooley  
Notary Public (One Inch Margin on all sides of Document for Recorder's Use Only)

0611790

BK0404PG14954

**EXHIBIT "A"**

**LEGAL DESCRIPTION**

ESCROW NO.: 040300414

The land referred to herein is situated in the State of Nevada, County of DOUGLAS described as follows:

Lot 1, in Block D, as set forth on the final map of MACKLAND UNIT NO. 2 "PHASE B" filed for record in the office of the County Recorder of Douglas County, State of Nevada, on September 25, 1989 in Book 989 at page 3256, Douglas County, Nevada as Document No. 211622.

ASSESSOR'S PARCEL NO. 1320-31-516-008

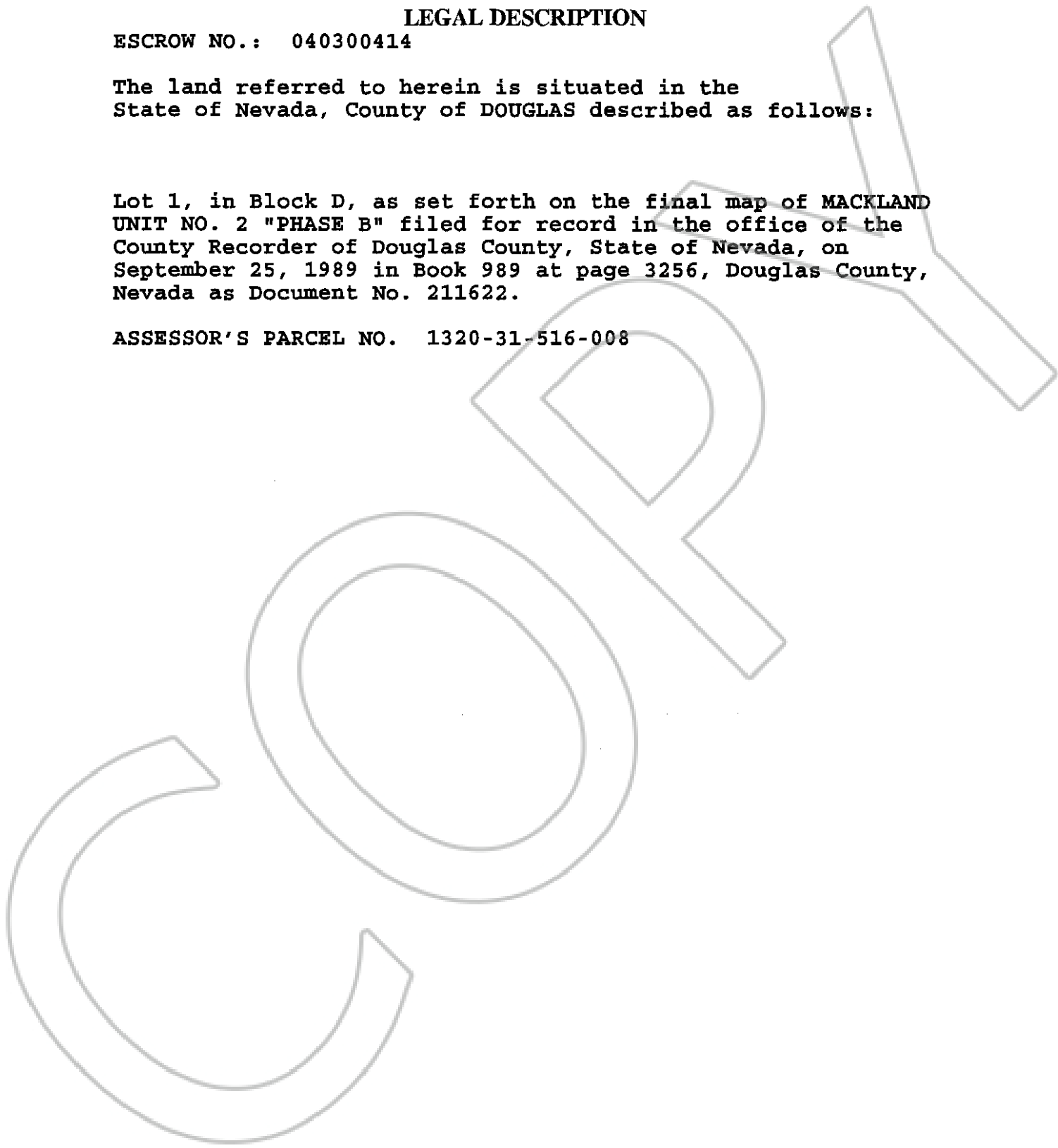

0611790  
BK0404PG14955