

A.P.N. # 1320-31-516-008

R.P.T.T. \$ 1,636.05

ESCROW NO. 040300404

RECORDING REQUESTED BY:  
**STEWART TITLE COMPANY**

MAIL TAX STATEMENTS TO:  
**SAME AS BELOW**

WHEN RECORDED MAIL TO:  
**MR. & MRS. LEYVA**  
**1397 TENTH STREET**  
**MINDEN, NV 89423**

REQUESTED BY  
**Stewart Title of Douglas County**  
IN OFFICIAL RECORDS OF  
DOUGLAS CO. NEVADA

2004 APR 29 PM 3:44

WERNER CHRISTEN  
RECORDER

\$150 PAID B DEPUTY

(Space Above for Recorder's Use Only)

### GRANT, BARGAIN, SALE DEED

THIS INDENTURE WITNESSETH: That **CURTIS W. FRANK**, a married man as  
his sole and separate property

in consideration of \$10.00, the receipt of which is hereby acknowledged, does hereby Grant, Bargain Sell  
and Convey to **FRANK D. LEYVA and ALICE LEYVA**, husband and wife as  
joint tenants

and to the heirs and assigns of such Grantee forever, all that real property situated in the  
County of **DOUGLAS** State of Nevada, bounded and described as:

**SEE EXHIBIT "A" ATTACHED HERETO AND MADE A PART HEREOF**

Together with all and singular the tenements, hereditaments and appurtenances thereunto belonging or in  
anywise appertaining, and any reversions, remainders, rents, issues or profits thereof.

DATE: **April 22, 2004**

  
CURTIS W. FRANK

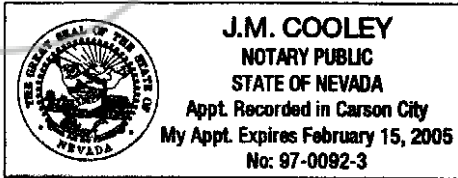

STATE OF NEVADA }  
  } ss.  
COUNTY OF DOUGLAS }

This instrument was acknowledged before me on 4-26-04  
by CURTIS W. FRANK

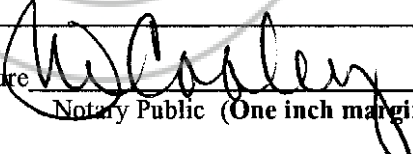
Signature   
Notary Public (One inch margin on all sides of document for Recorder's Use Only)

0611791  
BK 0404 PG 14956

**EXHIBIT "A"**

**LEGAL DESCRIPTION**

**ESCROW NO.:** 040300404

The land referred to herein is situated in the  
State of Nevada, County of DOUGLAS  
City of MINDEN described as follows:

Lot 1, in Block D, as set forth on the final map of MACKLAND  
UNIT NO. 2 "PHASE B" filed for record in the office of the  
County Recorder of Douglas County, State of Nevada, on  
September 25, 1989 in Book 989 at page 3256, Douglas County,  
Nevada as Document No. 211622.

**ASSESSOR'S PARCEL NO.** 1320-31-516-008

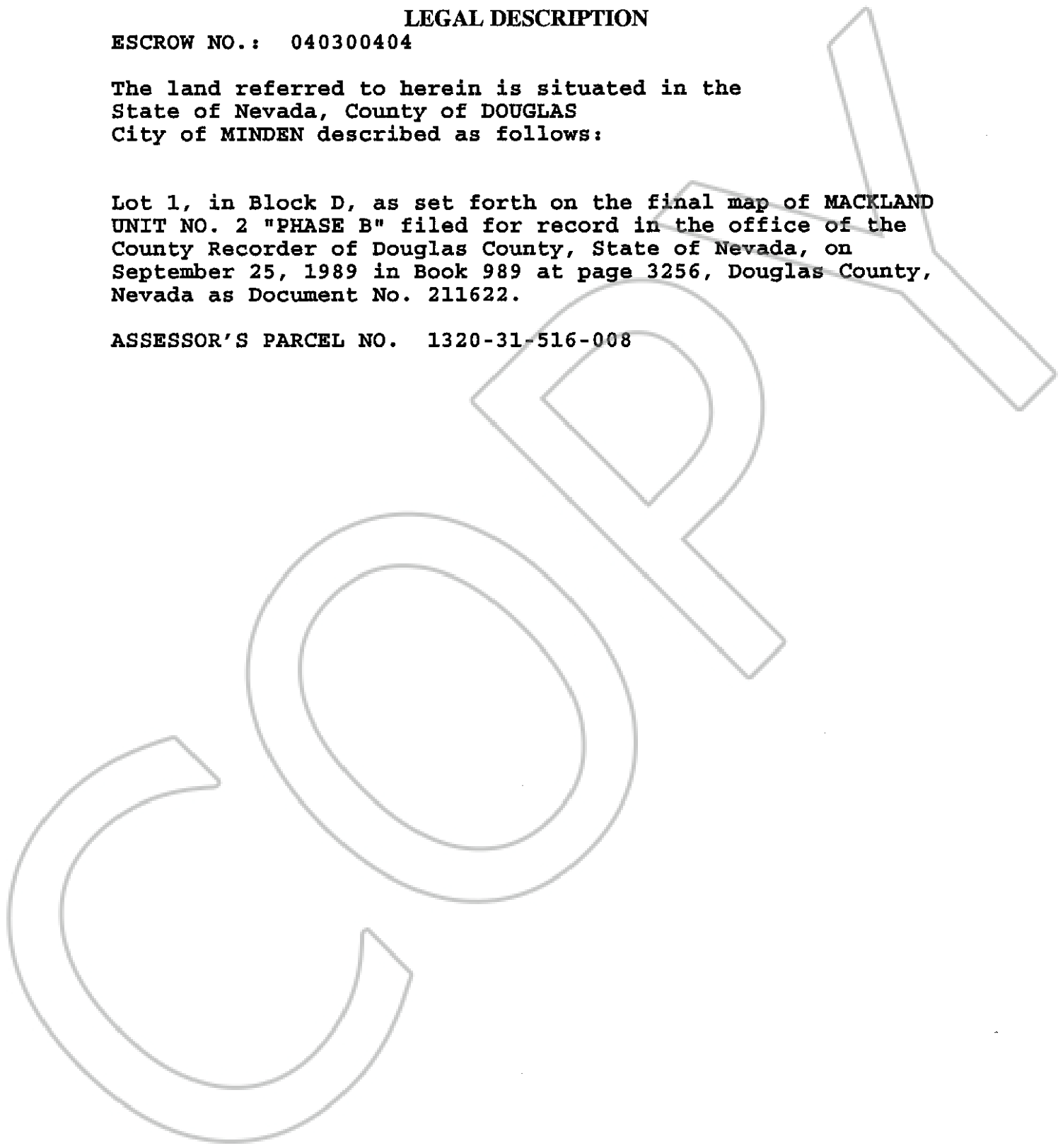

0611791

BK0404PG14957