

A.P.N. # 1321-32-002-012

R.P.T.T. \$ 0 5

ESCROW NO. 040100700

RECORDING REQUESTED BY:
STEWART TITLE COMPANY
MAIL TAX STATEMENTS TO:
SAME AS BELOW

WHEN RECORDED MAIL TO:
GRANTEE
P.O. BOX 612427
SO. LAKE TAHOE, CA 96152

REQUESTED BY
Stewart Title of Douglas County
IN OFFICIAL RECORDS OF
DOUGLAS CO., NEVADA

2004 MAY -3 PM 3:44

WERNER CHRISTEN
RECORDER

\$15⁰⁰ PAID *kg* DEPUTY

(Space Above for Recorder's Use Only)

GRANT, BARGAIN, SALE DEED

THIS INDENTURE WITNESSETH: That **GUY D. DODD, A MARRIED MAN**

in consideration of \$10.00, the receipt of which is hereby acknowledged, does hereby Grant, Bargain Sell and Convey to **MARTHA P. DODD, A MARRIED WOMAN AS HER SOLE & SEPARATE PROPERTY**

and to the heirs and assigns of such Grantee forever, all that real property situated in the County of **Douglas** State of Nevada, bounded and described as :

SEE EXHIBIT "A" ATTACHED HERETO AND MADE A PART HEREOF

IT IS THE EXPRESS INTENT OF THE GRANTOR, BEING THE SPOUSE OF THE GRANTEE, TO CONVEY ALL RIGHT, TITLE AND INTEREST OF THE GRANTOR, COMMUNITY OR OTHERWISE, IN AND TO THE HEREIN DESCRIBED PROPERTY TO THE GRANTEE AS GRANTEE'S SOLE AND SEPARATE PROPERTY.

Together with all and singular the tenements, hereditaments and appurtenances thereunto belonging or in anywise appertaining, and any reversions, remainders, rents, issues or profits thereof.

DATE: **April 14, 2005**

Guy D. Dodd

GUY D. DODD

STATE OF South Carolina
COUNTY OF Bekeley } SS.

This instrument was acknowledged before me on 4-16-04
by, **GUY D. DODD**

SEAL

Signature *Valerie A. Rawes* My Commission Expires **December 1, 2005**
Notary Public (One Inch Margin on all sides of Document for Recorder's Use Only)

0612130
BK0504PG00557

EXHIBIT "A"

LEGAL DESCRIPTION

ESCROW NO.: 040100700

**The land referred to herein is situated in the
State of Nevada, County of Douglas
City of GARDNERVILLE described as follows:**

**Lot C-4, as shown on the map of QUERIDO SUBDIVISION #1,
filed for record in the office of the County Recorder of
Douglas County, State of Nevada, on March 3, 1982, in Book
382, Page 149, as Document No. 65459.**

ASSESSOR'S PARCEL NO. 1321-32-002-012

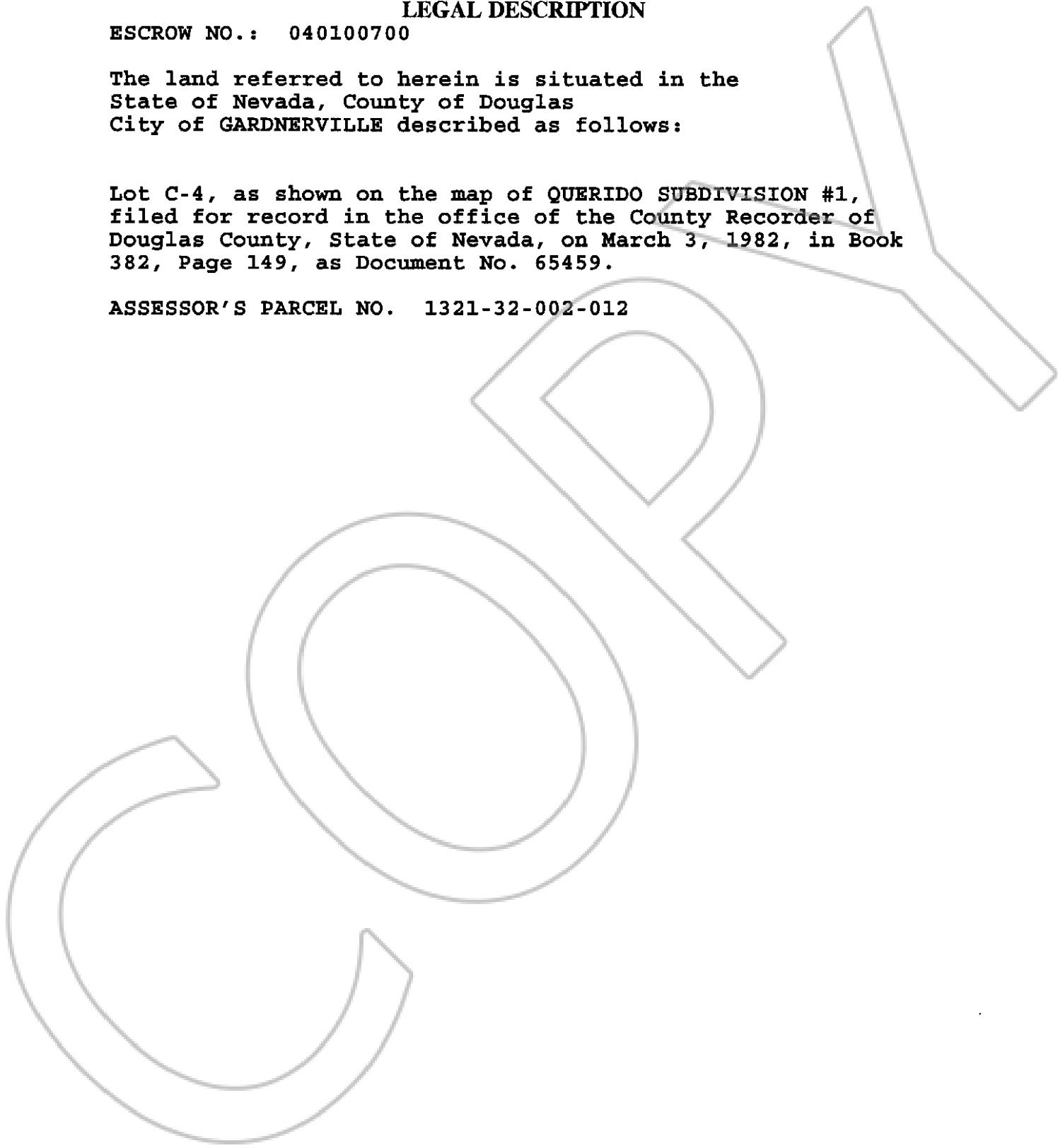

0612130

BK0504PG00558