

A.P.N. # 1220-16-116-008

R.P.T.T. \$ 1127.10

ESCROW NO. 040700703

RECORDING REQUESTED BY:  
**STEWART TITLE COMPANY**

MAIL TAX STATEMENTS TO:  
**SAME AS BELOW**

WHEN RECORDED MAIL TO:  
**GRANTEE**  
**1226 SPRINGTIME DRIVE**  
**GARDNERVILLE, NV 89460**

REQUESTED BY  
**Stewart Title of Douglas County**  
IN OFFICIAL RECORDS OF  
DOUGLAS CO. NEVADA

2004 MAY -7 PM 3: 38

WERHER CHRISTEN  
RECORDER

\$15<sup>00</sup> PAID PR DEPUTY

(Space Above for Recorder's Use Only)

**GRANT, BARGAIN, SALE DEED**

THIS INDENTURE WITNESSETH: That **GUIDO G. LANDOLT and CAROLYN M. LANDOLT, husband and wife**



in consideration of \$10.00, the receipt of which is hereby acknowledged, does hereby Grant, Bargain Sell and Convey to **KATHLEEN FERREIRA**, Trustee of THE KATHLEEN FERREIRA REVOCABLE TRUST dated November 18, 2003

and to the heirs and assigns of such Grantee forever, all that real property situated in the County of **Douglas** State of Nevada, bounded and described as:

**SEE EXHIBIT "A" ATTACHED HERETO AND MADE A PART HEREOF**

Together with all and singular the tenements, hereditaments and appurtenances thereunto belonging or in anywise appertaining, and any reversions, remainders, rents, issues or profits thereof.

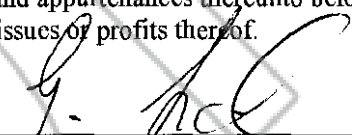
DATE: **February 23, 2004**

  
\_\_\_\_\_  
GUIDO G. LANDOLT  
  
\_\_\_\_\_  
CAROLYN M. LANDOLT

STATE OF Nevada }  
COUNTY OF Douglas } ss.

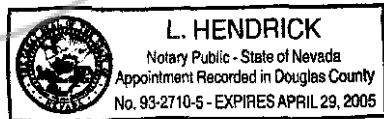

This instrument was acknowledged before me on 5-6-04  
by **GUIDO G. LANDOLT and CAROLYN M. LANDOLT**

Signature L. Hendrick  
\_\_\_\_\_  
Notary Public (One inch margin on all sides of document for Recorder's Use Only)

0612563

BK0504 PG02930

**EXHIBIT "A"**

**LEGAL DESCRIPTION**

**ESCROW NO.: 040700703**

**The land referred to herein is situated in the  
State of Nevada, County of Douglas  
City of GARDNERVILLE described as follows:**

**Lot 8, as shown on the final map for HIDDEN CREEK, filed for  
record in the Office of the County Recorder of Douglas County,  
State of Nevada, on April 11, 1995, in Book 495, at  
page 1452, as Document No. 359824.**

**Assessors Parcel No. 1220-16-116-008**

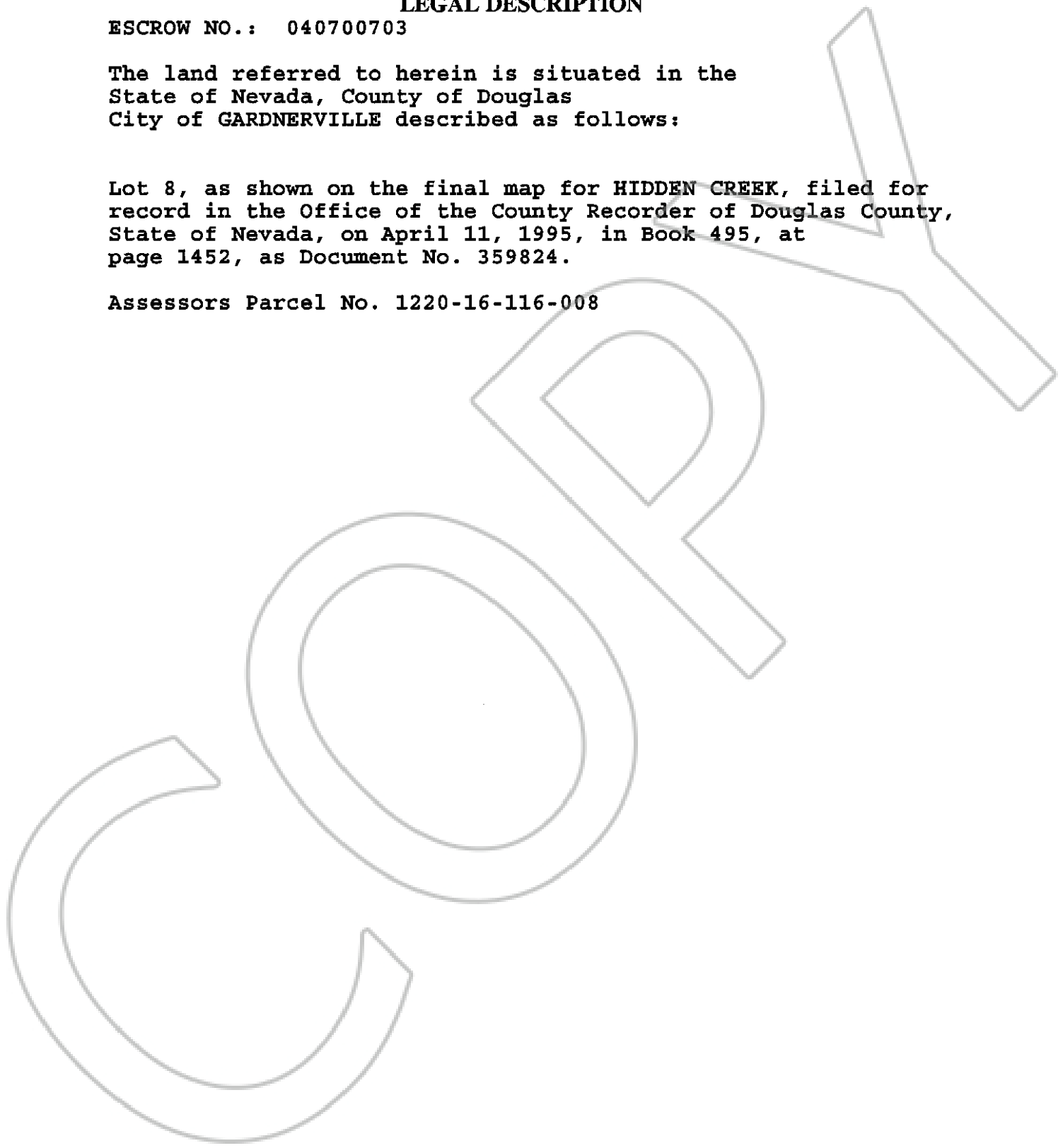

**0612563**

**BK 0504 PG 02931**