

A.P.N. # 1320-33-716-013

R.P.T.T. \$ 1287.00

ESCROW NO. 040101049

RECORDING REQUESTED BY:  
**STEWART TITLE COMPANY**

MAIL TAX STATEMENTS TO:  
**SAME AS BELOW**

WHEN RECORDED MAIL TO:

**GRANTEE**  
1370 PETAH LANE  
GARDNERVILLE, NV 89410

REQUESTED BY

**Stewart Title of Douglas County**  
IN OFFICIAL RECORDS OF  
DOUGLAS CO., NEVADA

2004 MAY -7 PM 3:44

WERNER CHRISTEN  
RECORDER

\$ 15.00 PAID B DEPUTY

(Space Above for Recorder's Use Only)

### GRANT, BARGAIN, SALE DEED

THIS INDENTURE WITNESSETH: That **LISA N. SIMMONS, an unmarried woman**

in consideration of \$10.00, the receipt of which is hereby acknowledged, does hereby Grant, Bargain Sell and Convey to **ERIN E. GATLIN, an unmarried woman**

and to the heirs and assigns of such Grantee forever, all that real property situated in the  
County of **DOUGLAS** State of Nevada, bounded and described as:

**SEE EXHIBIT "A" ATTACHED HERETO AND MADE A PART HEREOF**

Together with all and singular the tenements, hereditaments and appurtenances therunto belonging or in anywise appertaining, and any reversions, remainders, rents, issues or profits thereof.

DATE: **April 30, 2004**

*Lisa N. Simmons*  
**LISA N. SIMMONS**



**SUZANNE CHEECHOV**  
NOTARY PUBLIC  
STATE OF NEVADA  
Appt. Recorded in Douglas County  
My Appt. Expires June 25, 2007  
No: 99-36456-5



**SUZANNE CHEECHOV**  
NOTARY PUBLIC  
STATE OF NEVADA  
Appt. Recorded in Douglas County  
My Appt. Expires June 25, 2007  
No: 99-36456-5

STATE OF *NV*  
COUNTY OF *Douglas* } ss.

This instrument was acknowledged before me on *5/3/04*  
by **LISA N. SIMMONS**

Signature *Suzanne Cheechov*  
Notary Public (One inch margin on all sides of document for Recorder's Use Only)

0612566  
BK0504 PG02963

**EXHIBIT "A"**

**LEGAL DESCRIPTION**

**ESCROW NO.: 040101049**

**The land referred to herein is situated in the  
State of Nevada, County of DOUGLAS  
City of GARDNERVILLE described as follows:**

**Lot 13, Block A, as set forth on FINAL SUBDIVISION MAP No.  
1006-8 for CHICHESTER ESTATES, PHASE 8, filed in the office  
of the County Recorder of Douglas County, Nevada and  
recorded June 12, 2001 in Book 0601, Page 2589, as Document  
No. 516199.**

**Assessors Parcel Number 1320-33-716-013**

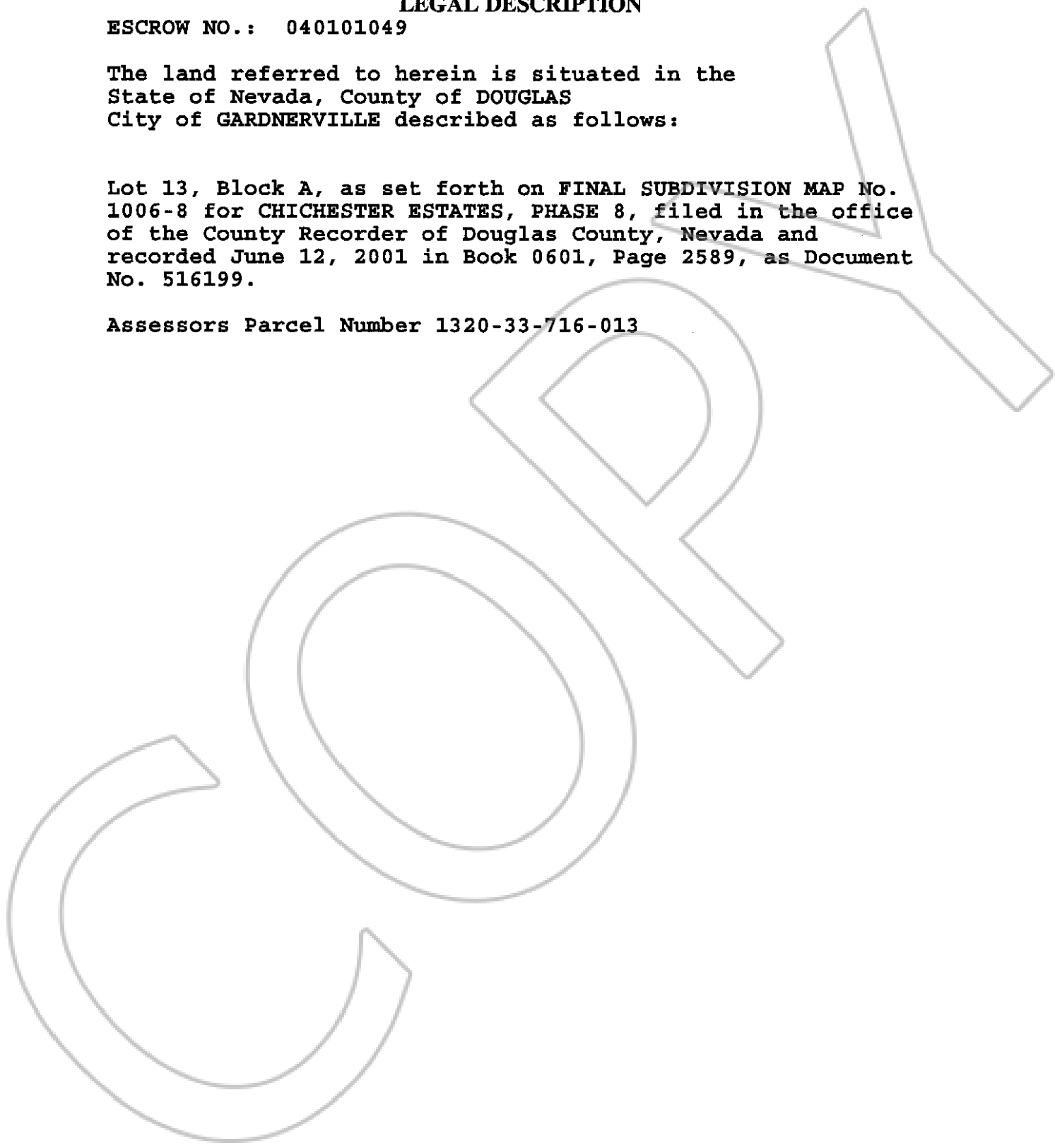

**0612566  
BK0504PG02964**