



**EXHIBIT "A"**

**PARCEL 1:**

Lot 99, in Block E, as shown on the AMENDED MAP OF GLENBROOK SUBDIVISION UNIT 2 (2-A), filed in the Office of the County Recorder on October 13, 1978 in Book 1078, at Page 999, as Document No. 26250, of Official Records of Douglas County, Nevada and on the SECOND AMENDED MAP OF GLENBROOK SUBDIVISION UNIT 2 (2-A), filed in the Office of the County Recorder on January 30, 1980 in Book 180, at Page 1512, as Document No. 41035, of Official Records of Douglas County, Nevada.

**PARCEL 2:**

The exclusive right to use for garage purposes that parcel designated as "garage easement" that is appurtenant to Parcel 1 above.

Douglas County A. P. No. 1418-11-412-021

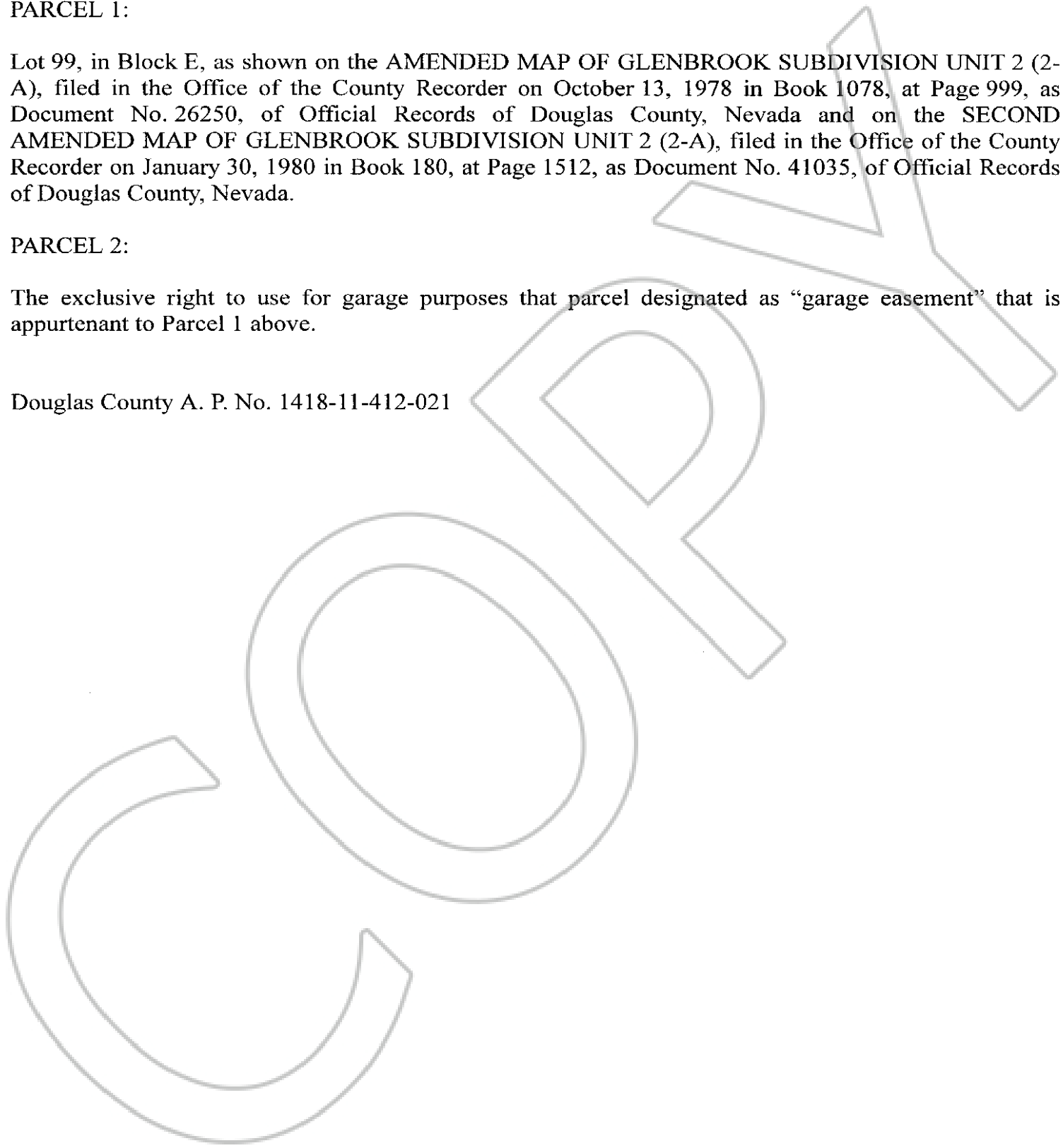

0613148

BK0504PG06402