

A.P.N. # 1420-35-201-021

R.P.T.T. \$ 2457.00

ESCROW NO. 040801103

RECORDING REQUESTED BY:

STEWART TITLE COMPANY

MAIL TAX STATEMENTS TO:

SAME AS BELOW

WHEN RECORDED MAIL TO:

GRANTEE

2718 NYE DRIVE

MINDEN, NEVADA

REQUESTED BY
Stewart Title of Douglas County

IN OFFICIAL RECORDS OF
DOUGLAS COUNTY, NEVADA

2004 MAY 14 PM 3:48

WERNER CHRISTEN
RECORDER

\$ 15.00 PAID KJ DEPUTY

(Space Above for Recorder's Use Only)

GRANT, BARGAIN, SALE DEED

THIS INDENTURE WITNESSETH: That **JOHN R. STEPHENSON AND JUDY A. STEPHENSON, HUSBAND AND WIFE AS JOINT TENANTS**

in consideration of \$10.00, the receipt of which is hereby acknowledged, does hereby Grant, Bargain Sell and Convey to **EDWARD ALEXANDER AND ASHLI ALEXANDER, HUSBAND AND WIFE AS JOINT TENANTS**

and to the heirs and assigns of such Grantee forever, all that real property situated in the County of **Douglas** State of Nevada, bounded and described as:

SEE EXHIBIT "A" ATTACHED HERETO AND MADE A PART HEREOF

Together with all and singular the tenements, hereditaments and appurtenances thereunto belonging or in anywise appertaining, and any reversions, remainders, rents, issues or profits thereof.

DATE: **April 14, 2004**

John R. Stephenson
JOHN R. STEPHENSON

Judy A. Stephenson
JUDY A. STEPHENSON

STATE OF Nevada }
COUNTY OF Carson } ss.

This instrument was acknowledged before me on April 21, 2004
by JOHN R. STEPHENSON and JUDY A. STEPHENSON

Signature Denise A. Watson
Notary Public (One inch margin on all sides of document for Recorder's Use Only)

0613218

BK0504PG06830

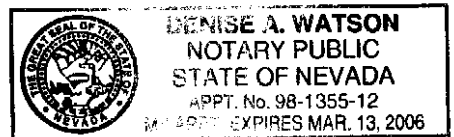

EXHIBIT "A"

LEGAL DESCRIPTION

ESCROW NO.: 040801103

The land referred to herein is situated in the State of Nevada, County of Douglas City of MINDEN described as follows:

Parcel 4 as shown on that certain Parcel Map for Darrell W. Bronsema and Ingrid M. Bronsema, filed for record in the office of the Douglas County Recorder on September 12, 1990, in Book 990, Page 1247, as Document No. 234341, Official Records.

Assessors Parcel No. 1420-35-201-021

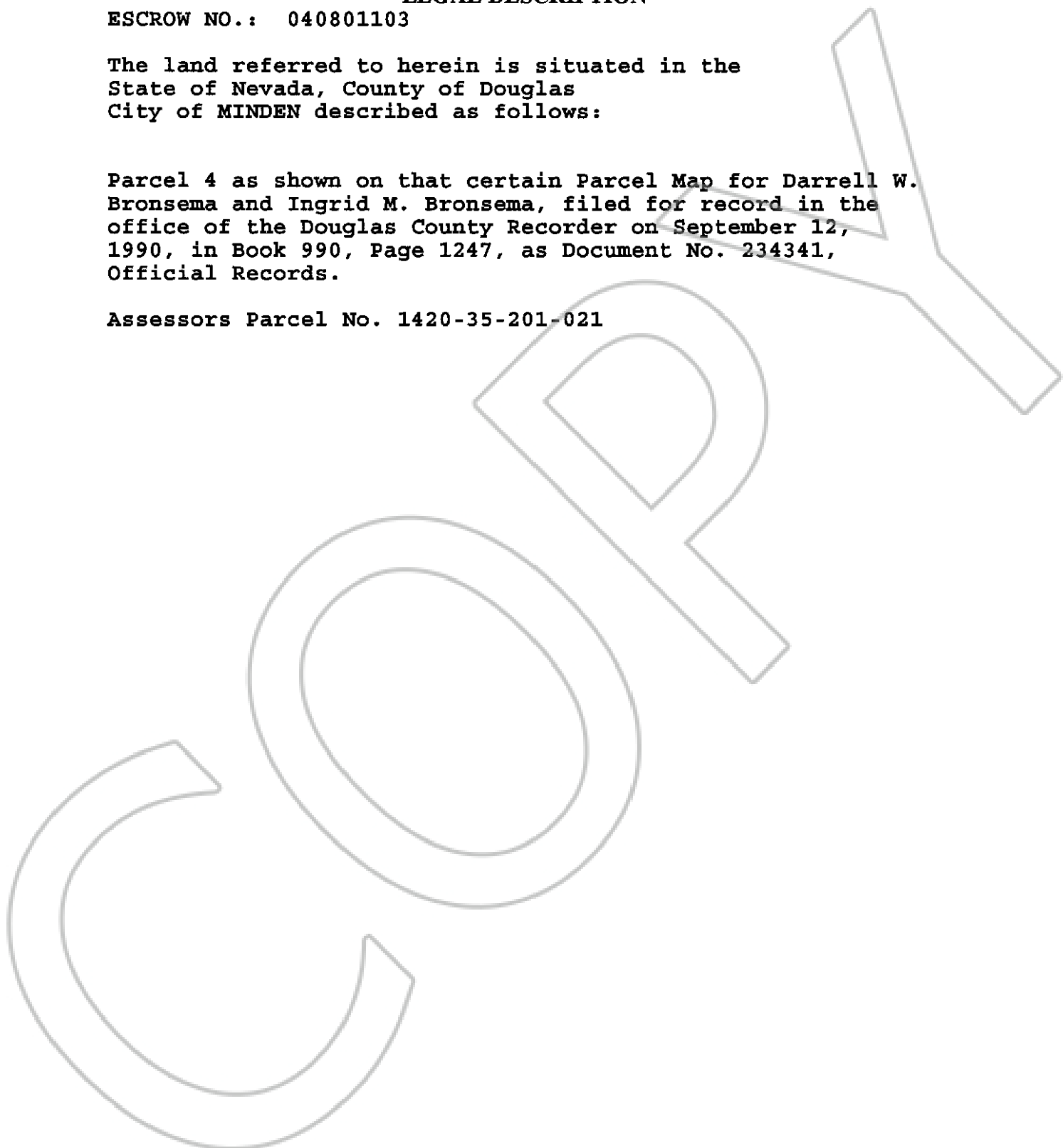

0613218

BK0504PG06831