

EXHIBIT "A"

LEGAL DESCRIPTION

ESCROW NO.: 040801105

The land referred to herein is situated in the
State of Nevada, County of Douglas
City of GARDNERVILLE described as follows:

Parcel V4-A, as set forth on ABC Investment Company Parcel
Map #3, filed in the office of the County Recorder of
Douglas County, Nevada on April 6, 1993, in Book 493, at
Page 816 as Document No. 303845, Official Records.

Assessors Parcel No. 1022-07-002-007

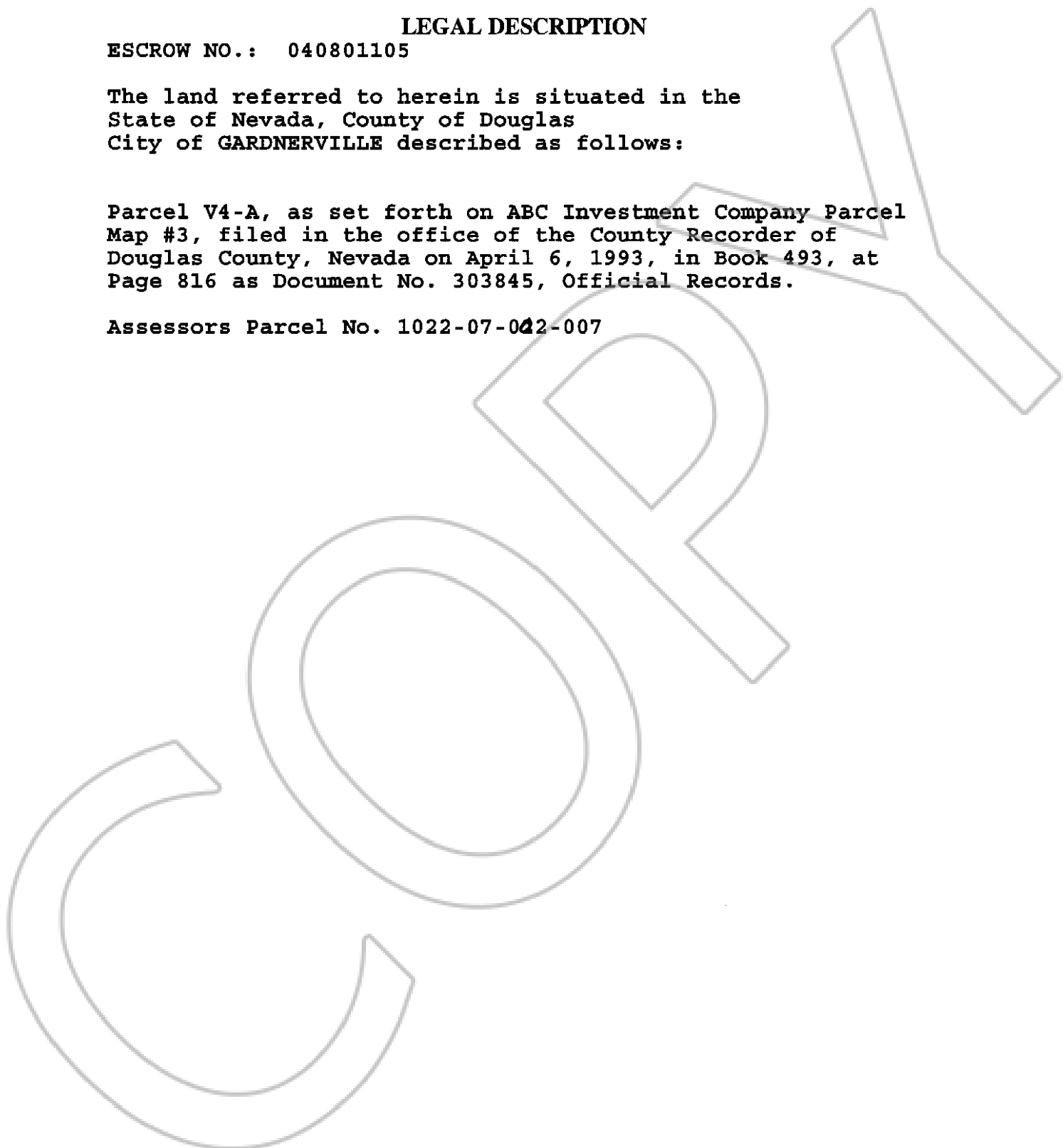

0613323

BK0504PG07588