

EXHIBIT "A"

LEGAL DESCRIPTION

ESCROW NO.: 040801451

The land referred to herein is situated in the
State of Nevada, County of DOUGLAS
City of GARDNERVILLE described as follows:

Lot 51, Block A, as shown on the Map of HOLBROOK HIGHLANDS,
filed in the Office of the County Recorder of Douglas
County, Nevada, on March 22, 1978, as Document No. 18825.

Assessors Parcel No. 1022-18-002-020

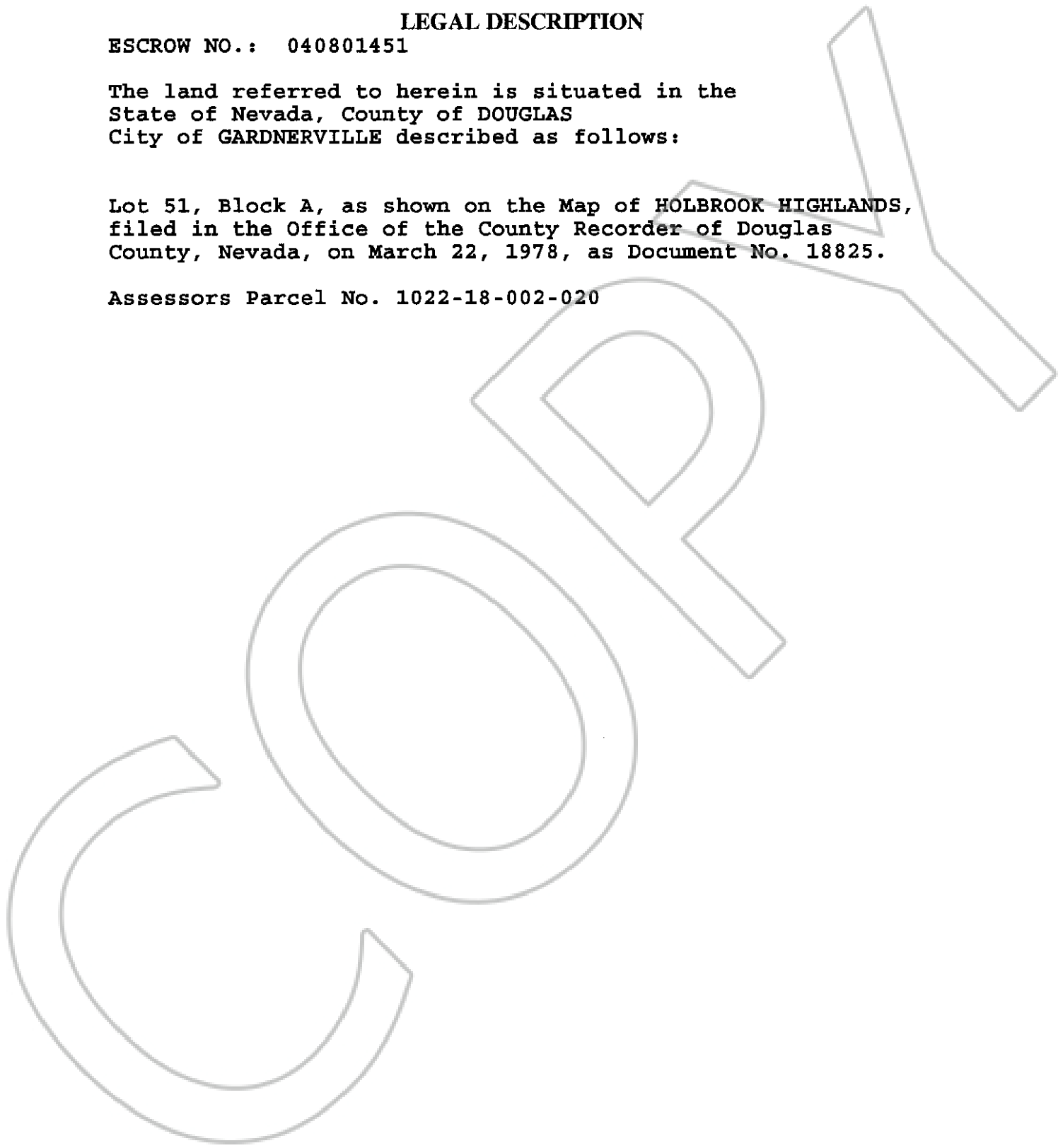

0613538

BK0504PG08850