

EXHIBIT "A"

LEGAL DESCRIPTION

The land referred to herein is situated in the
State of Nevada, County of DOUGLAS
City of GARDNERVILLE described as follows:

Lot 32, Block B, as set forth on FINAL SUBDIVISION MAP No.
1006-11 for CHICHESTER ESTATES, PHASE 11, filed in the
office of the County Recorder of Douglas County, Nevada and
recorded December 27, 2002 in Book 1202, Page 12732, as
Document No. 562225, and by Certificate of Amendment
recorded March 27, 2003 in Book 0303, Page 13037, as
Document No. 0571430.

Assessors Parcel Number 1320-33-816-051

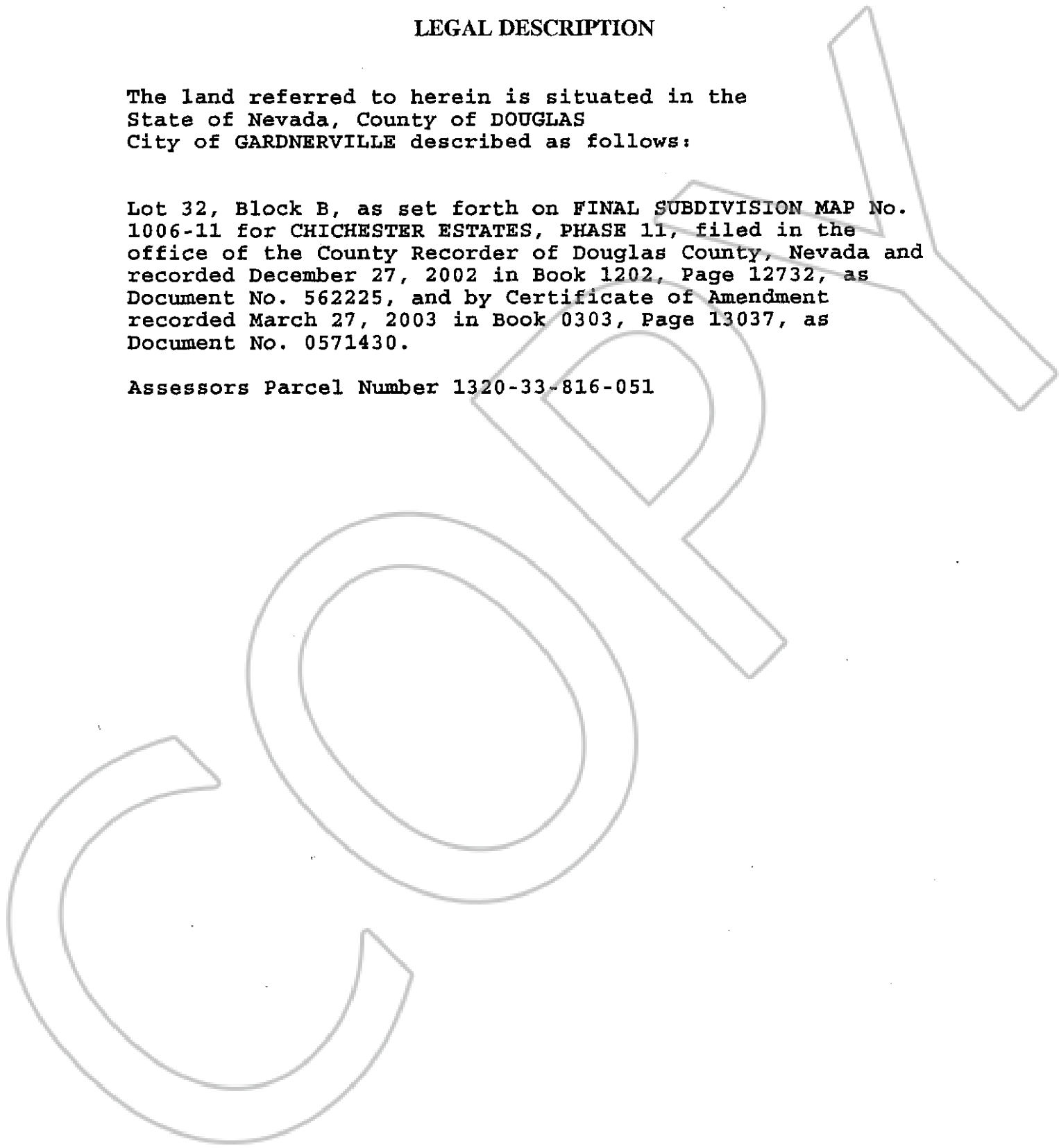

0614042

BK0504PG11705