

A.P.N. # 1221-06-001-039

R.P.T.T. \$ 702.00

ESCROW NO. 040701248

RECORDING REQUESTED BY:
STEWART TITLE COMPANY

MAIL TAX STATEMENTS TO:
SAME AS BELOW

WHEN RECORDED MAIL TO:
GRANTEE
P.O. BOX 615
MARTINEZ, CA 94553

REQUESTED BY
Stewart Title of Douglas County

IN OFFICIAL RECORDS OF
DOUGLAS CO., NEVADA

2004 MAY 25 PM 3:29

WEAVER CHRISTEN
RECORDER

\$ 15.00 PAID KJ DEPUTY

(Space Above for Recorder's Use Only)

GRANT, BARGAIN, SALE DEED

THIS INDENTURE WITNESSETH: That **K.D. THOMAS AND JUDY JOHNSON,**
HUSBAND AND WIFE

in consideration of \$10.00, the receipt of which is hereby acknowledged, does hereby Grant, Bargain Sell
and Convey to **GEOFFREY GRIFFIN, AN UNMARRIED MAN**

and to the heirs and assigns of such Grantee forever, all that real property situated in the
County of **Douglas** State of Nevada, bounded and described as:

SEE EXHIBIT "A" ATTACHED HERETO AND MADE A PART HEREOF

Together with all and singular the tenements, hereditaments and appurtenances thereunto belonging or in
anywise appertaining, and any reversions, remainders, rents, issues or profits thereof.

DATE: **May 20, 2004**

K.D. Thomas

K.D. THOMAS

Judy Johnson

JUDY JOHNSON

STATE OF Nevada }
} ss.

COUNTY OF Douglas }

This instrument was acknowledged before me on 5-24-04
by **K.D. THOMAS and JUDY JOHNSON**

Signature

L. Hendrick
Notary Public (One inch margin on all sides of document for Recorder's Use Only)



0614214

BK0504PG12520

EXHIBIT "A"

LEGAL DESCRIPTION

ESCROW NO.: 040701248

The land referred to herein is situated in the
State of Nevada, County of Douglas
City of GARDNERVILLE described as follows:

Lot 93, of FISH SPRINGS ESTATES, according to the map
thereof, filed for record in the Office of the County
Recorder of Douglas County, Nevada, on August 30, 1973, as
Document No. 68451.

Assessors Parcel No. 1221-06-001-039

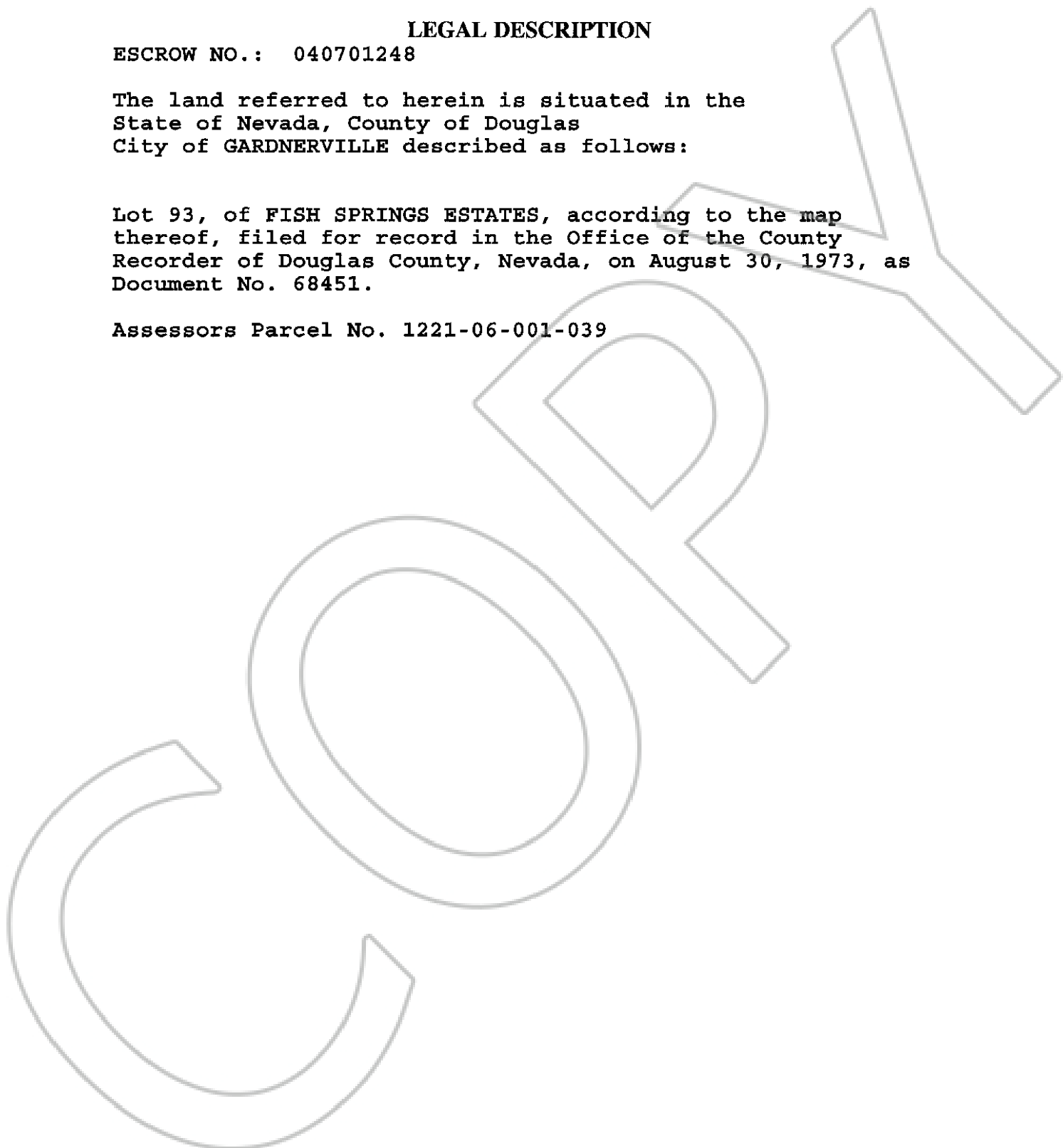

0614214

BK0504PG12521