

REQUESTED BY  
**FIRST AMERICAN TITLE CO.**

IN OFFICIAL RECORDS OF  
DOUGLAS COUNTY, NEVADA

2004 MAY 27 PM 12: 54

WERNER CHRISTEN  
RECORDER

\$16<sup>00</sup> PAID *KJ* DEPUTY

A.P.N.: 1318-03-111-052  
File No: 141-2135896 (CD)  
R.P.T.T.: \$2,983.50

When Recorded, Mail Tax Statements To:  
Liangdong Lily Yue  
P.O. Box 1502  
Zephyr Cove, NV 89448

***GRANT, BARGAIN and SALE DEED***

*FOR A VALUABLE CONSIDERATION*, receipt of which is hereby acknowledged,

Robert E. McDonald, Trustee of the Rem Family Trust dated September 17, 1992

do(es) hereby *GRANT, BARGAIN and SELL* to

Liangdong Lily Yue, a married woman as her sole and separate property

the real property situate in the County of Douglas, State of Nevada, described as follows:

**PARCEL 1:**

**LOT 121, AS SHOWN ON THE MAP OF SKYLAND SUBDIVISION NO. 2, FILED IN THE COUNTY RECORDER OF DOUGLAS COUNTY, NEVADA, ON JULY 22, 1959, AS FILE NO. 14668, EXCEPTING THEREFROM THAT PORTION DESCRIBED AS FOLLOWS:**

**BEGINNING AT THE SOUTHWEST CORNER OF LOT 121, THENCE NORTHWESTERLY ALONG THE WESTERLY LINE OF SAID LOT 121 ALONG A CURVE CONCAVE TO THE WEST WITH A RADIUS OF 125 FEET, A CENTRAL ANGLE OF 01°08'45", AN ARC LENGTH OF 2.50 FEET; THENCE SOUTH 88°04'23" EAST, 46.69 FEET TO A POINT ON THE SOUTH LINE OF SAID LOT 121; THENCE ALONG SAID SOUTH LINE SOUTH 88°51'35" WEST, 46.71 FEET TO THE POINT OF BEGINNING.**

**PARCEL 2:**

**ALL THAT PORTION OF LOT 120, SKYLAND SUBDIVISION NO. 2, RECORDED JULY 22, 1959, FILE NO. 14668, MORE PARTICULARLY DESCRIBED AS FOLLOWS:**

**BEGINNING AT THE NORTHEAST CORNER OF LOT 120; THENCE ALONG THE EASTERLY LINE OF SAID LOT 120, SOUTH 08°28'32" WEST, 2.50 FEET; THENCE NORTH 88°04'23" WEST, 46.07 FEET TO A POINT ON THE NORTH LINE OF LOT 120; THENCE ALONG SAID NORTH LINE NORTH 88°51'35" EAST, 46.42 FEET TO THE POINT OF BEGINNING.**

0614463

BK0504PG13843

**PARCEL 3:**

**THE RIGHT OF ACCESS OVER LOTS 32 AND 33; AS SHOWN ON THE FILED MAP REFERRED TO HEREIN AS RESERVED IN THE DEED FROM STOCKTON GARDEN HOMES, INC., A CALIFORNIA CORPORATION TO SKYLAND WATER CO., A NEVADA CORPORATION TO SKYLAND WATER CO., A NEVADA CORPORATION RECORDED FEBRUARY 5, 1960 IN BOOK 1 OF OFFICIAL RECORDS, AT PAGE 268, DOUGLAS COUNTY, NEVADA.**

**NOTE: THE ABOVE METES AND BOUND DESCRIPTION APPEARED PREVIOUSLY IN THAT CERTAIN DOCUMENT RECORDED AUGUST 15, 1994, IN BOOK 0894, PAGE 2598, AS INSTRUMENT NO. 344028.**

*TOGETHER* with all tenements, hereditaments and appurtenances, including easements and water rights, if any, thereto belonging or appertaining, and any reversions, remainders, rents, issues or profits thereof.

Date: 05/24/2004

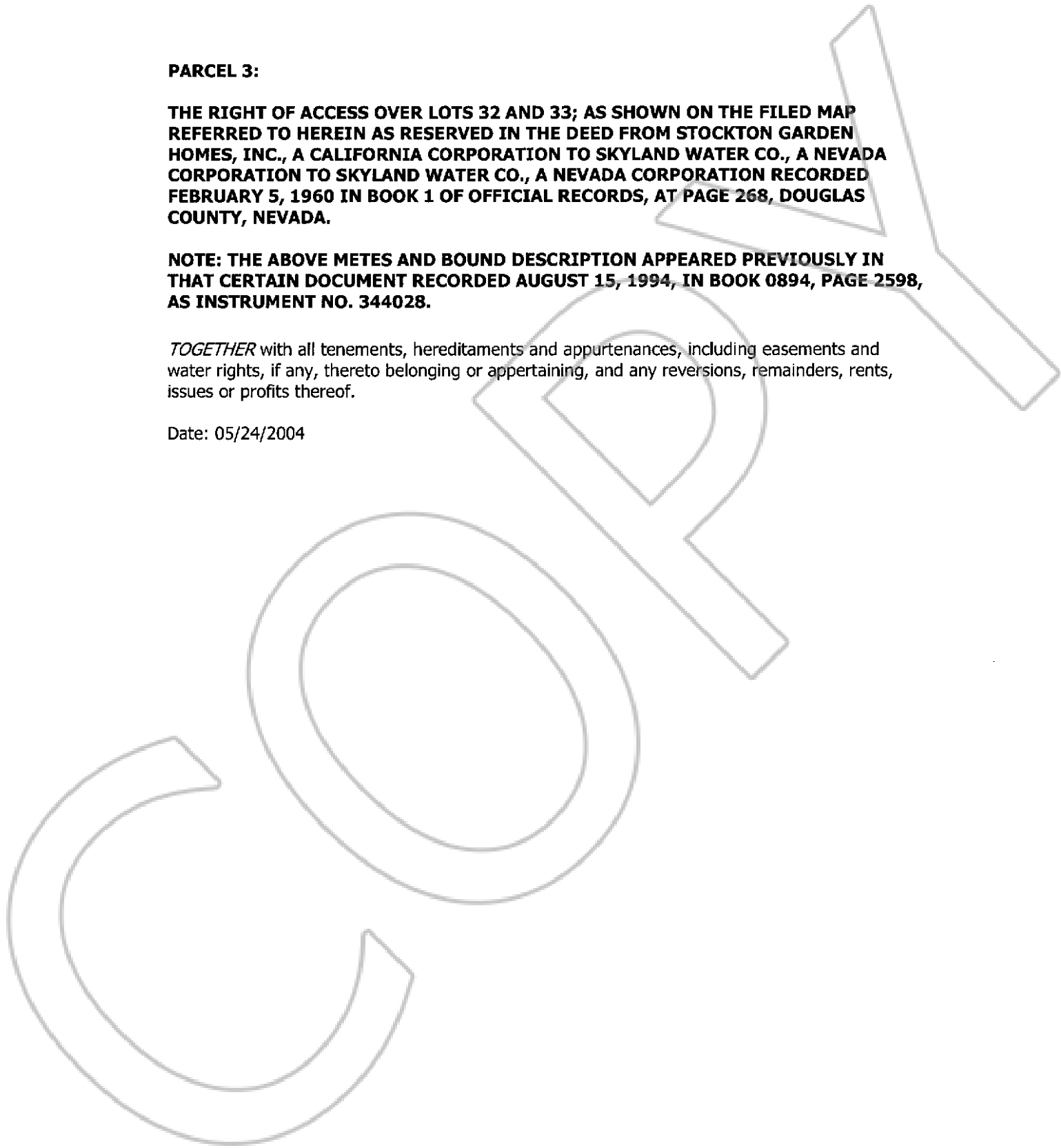

0614463

BK0504PG13844

Robert E. McDonald, Trustee of the Rem  
Family Trust, dated September 17, 1992

*[Handwritten Signature]*  
Robert E. McDonald, Trustee \*\*\*\*

STATE OF *California* )  
**NEVADA** )  
COUNTY OF *San Luis Obispo* : ss.  
**DOUGLAS** )

This instrument was acknowledged before me on *May 25, 2004* by  
**Robert E. McDonald.**

*Anne P Buckley*  
Notary Public  
(My commission expires: *4-1-06* )

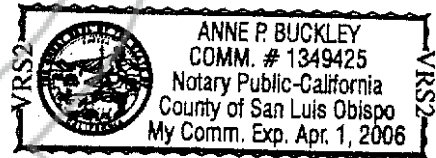

This Notary Acknowledgement is attached to that certain Grant, Bargain Sale Deed dated **May 24, 2004** under Escrow No. **141-2135896**.

\*\*\*\*personally known to me (or proved to me on the basis of satisfactory evidence) to be the person whose name is subscribed to the within instrument and acknowledged to me that he executed the same in his authorized capacity and that by his signature on the instrument the person or the entity upon behalf of which the person acted, executed the instrument.

0614463

BK0504PG13845