

A.P.N. # 1320-33-811-045

R.P.T.T. \$ 1131.00

ESCROW NO. 040101276

RECORDING REQUESTED BY:
STEWART TITLE COMPANY
MAIL TAX STATEMENTS TO:
SAME AS BELOW

WHEN RECORDED MAIL TO:
GRANTEE
1338 WINDSOR DRIVE
GARDNERVILLE, NV 89410

REQUESTED BY
Stewart Title of Douglas County

IN OFFICIAL RECORDS OF
DOUGLAS CO., NEVADA

2004 MAY 27 PM 3:43

WERNER CHRISTEN
RECORDER

\$15⁰⁰ PAID Kj DEPUTY

(Space Above for Recorder's Use Only)

GRANT, BARGAIN, SALE DEED

THIS INDENTURE WITNESSETH: That **JOHN C. KEITHLEY AND RENEE' L. KEITHLEY, HUSBAND AND WIFE**

in consideration of \$10.00, the receipt of which is hereby acknowledged, does hereby Grant, Bargain Sell and Convey to **JACQUELINE C. SPIEGLER, AND PHILLIP SPIEGLER AND HEIDI SPIEGLER, HUSBAND AND WIFE AN UNMARRIED WOMAN, ALL AS JOINT TENANTS**

and to the heirs and assigns of such Grantee forever, all that real property situated in the County of **Douglas** State of Nevada, bounded and described as:

SEE EXHIBIT "A" ATTACHED HERETO AND MADE A PART HEREOF

Together with all and singular the tenements, hereditaments and appurtenances thereunto belonging or in anywise appertaining, and any reversions, remainders, rents, issues or profits thereof.

DATE: **May 12, 2004**

John C Keithley

JOHN C. KEITHLEY

Renee L Keithley

RENEE' L. KEITHLEY

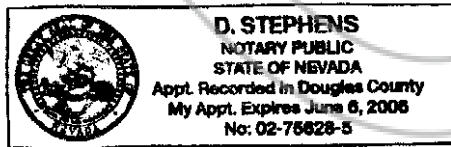

STATE OF NV }
 } ss.
COUNTY OF DOUGLAS }

This instrument was acknowledged before me on 5.21.04,
by **JOHN C. KEITHLEY and RENEE' L. KEITHLEY**

Signature *D. Stephens*

Notary Public (One inch margin on all sides of document for Recorder's Use Only)

0614489
BK0504PG14045

EXHIBIT "A"

LEGAL DESCRIPTION

ESCROW NO.: 040101276

The land referred to herein is situated in the
State of Nevada, County of Douglas
City of GARDNERVILLE described as follows:

Lot 5, Block A, as set forth on FINAL SUBDIVISION MAP No.
1006-4 for CHICHESTER ESTATES, PHASE 4, filed in the office
of the County Recorder of Douglas County, Nevada and
recorded December 11, 1997 in Book 1297, Page 2264, as
Document No. 428220.

ASSESSOR'S PARCEL NO. 1320-33-811-045

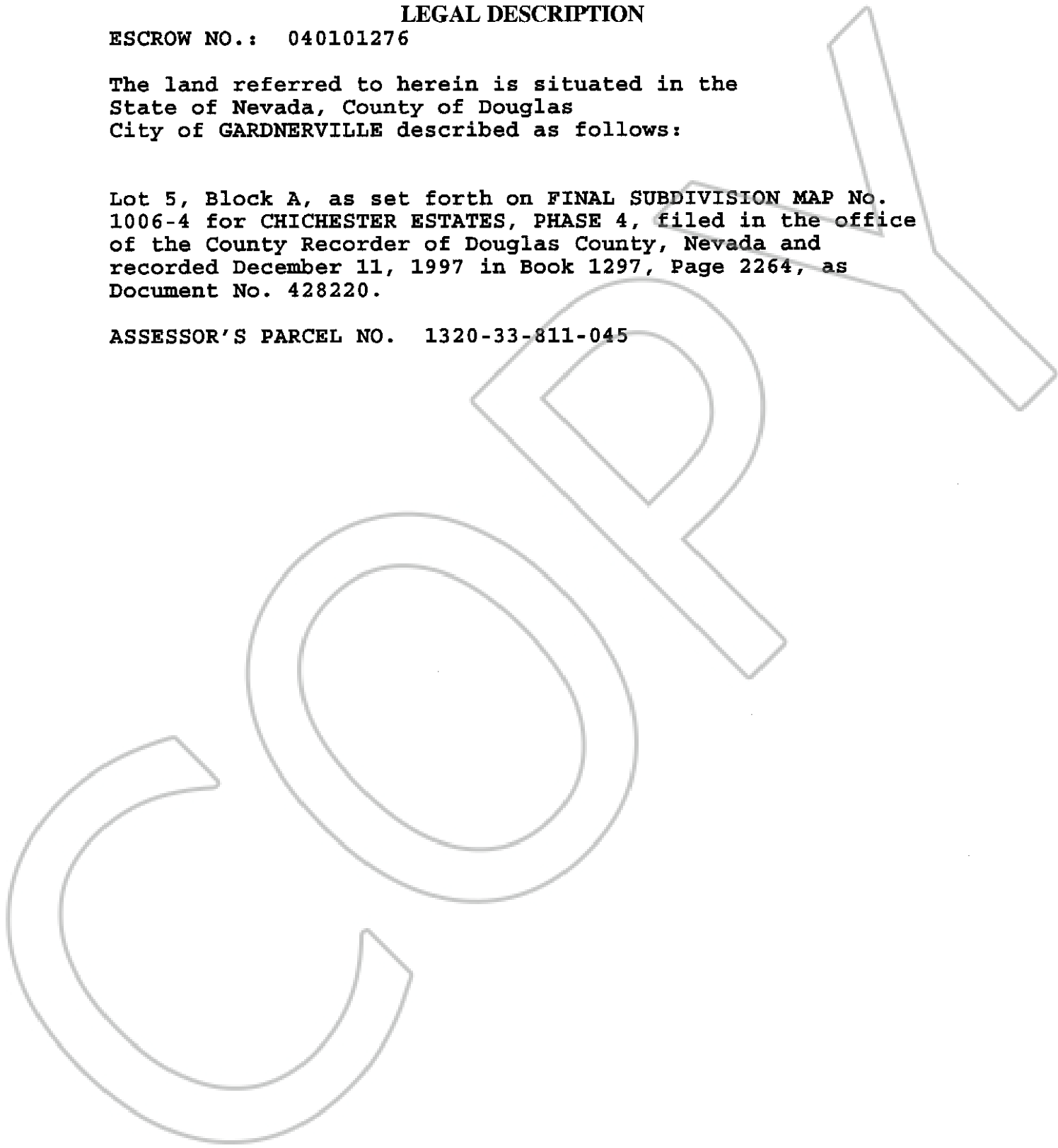

0614489

BK0504PG14046