

A.P.N. # 1420-28-311-053

R.P.T.T. \$ 1,501.50

ESCROW NO. 040300896

RECORDING REQUESTED BY:
STEWART TITLE COMPANY

MAIL TAX STATEMENTS TO:
SAME AS BELOW

WHEN RECORDED MAIL TO:
**MR. & MRS. KEITHLEY
2847 LA CRESTA CIRCLE
MINDEN, NV 89423**

REQUESTED BY
Stewart Title of Douglas County
IN OFFICIAL RECORDS OF
DOUGLAS CO., NEVADA

2004 MAY 27 PM 3:47

WERNER CHRISTEN
RECORDER

\$15.00 PAID KJ DEPUTY

(Space Above for Recorder's Use Only)

GRANT, BARGAIN, SALE DEED

THIS INDENTURE WITNESSETH: That **THOMAS S. KELLY, an unmarried man**

in consideration of \$10.00, the receipt of which is hereby acknowledged, does hereby Grant, Bargain Sell and Convey to **JOHN C. KEITHLEY and RENEE L. KEITHLEY, husband and wife** AS JOINT TENANTS WITH RIGHT OF SURVIVORSHIP

and to the heirs and assigns of such Grantee forever, all that real property situated in the County of **DOUGLAS** State of Nevada, bounded and described as:

SEE EXHIBIT "A" ATTACHED HERETO AND MADE A PART HEREOF

Together with all and singular the tenements, hereditaments and appurtenances thereunto belonging or in anywise appertaining, and any reversions, remainders, rents, issues or profits thereof.

DATE: **May 17, 2004**

Thomas S. Kelly

THOMAS S. KELLY

STATE OF NEVADA }
 } ss.
COUNTY OF DOUGLAS }

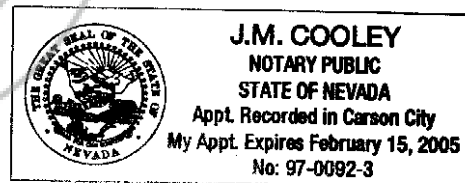

This instrument was acknowledged before me on 5-19-04
by THOMAS S. KELLY

J.M. Cooley

Signature Notary Public (One inch margin on all sides of document for Recorder's Use Only)

0614491

BK0504PG14066

EXHIBIT "A"

LEGAL DESCRIPTION

ESCROW NO.: 040300896

The land referred to herein is situated in the State of Nevada, County of DOUGLAS described as follows:

Lot 121, Block G, as shown on the Final Map #PD99-02-05 for SARATOGA SPRINGS ESTATES UNIT 5, A PLANNED DEVELOPMENT, recorded in the Office of the County Recorder of Douglas County, Nevada, on May 4, 2001, in Book 0501, at Page 1402, as Document No. 513570, and further Certificate of Amendment recorded July 17, 2001 as Document No. 518483.

ASSESSOR'S PARCEL NUMBER: 1420-28-311-053

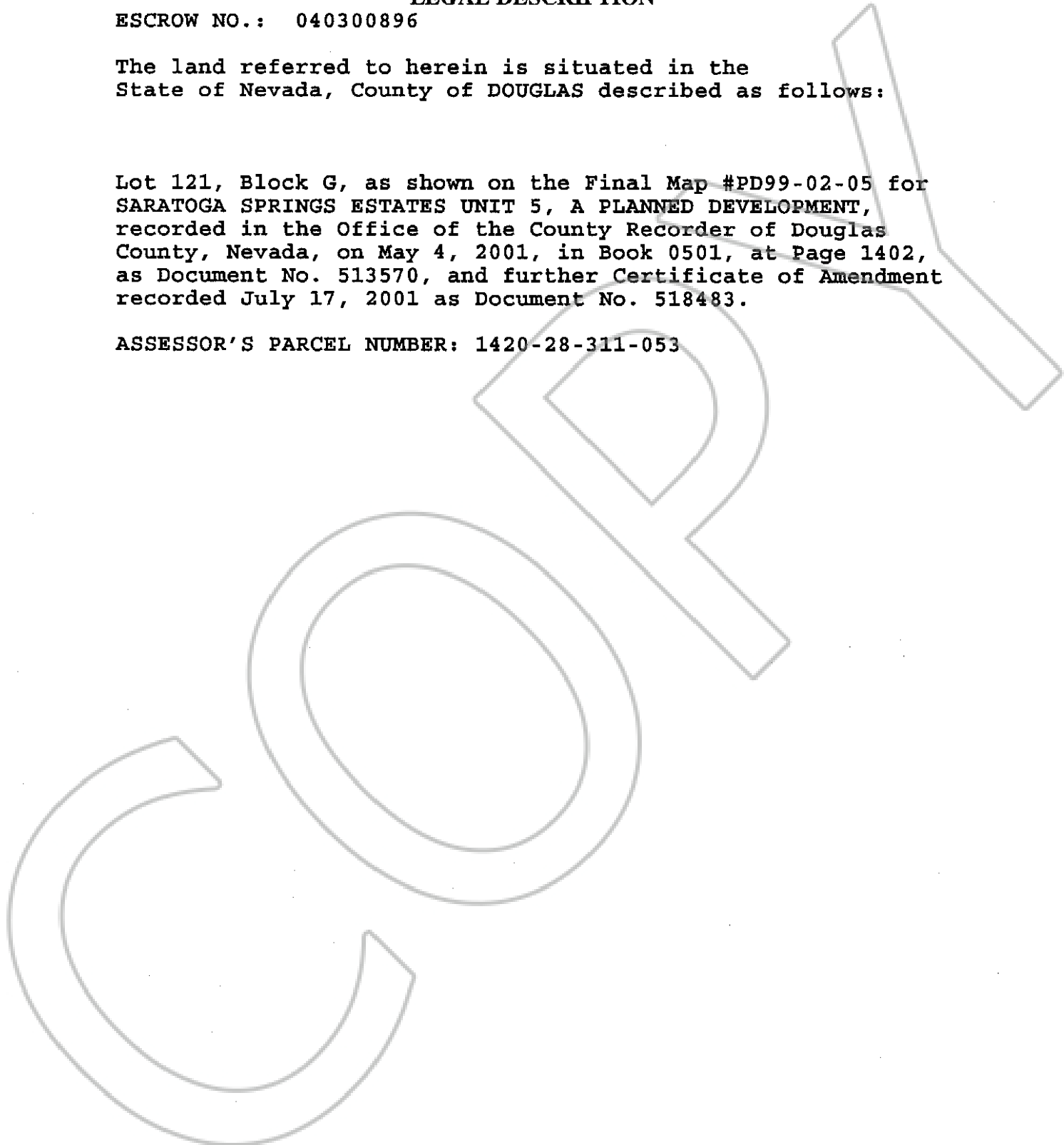

0614491

BK0504PG14067