

A.P.N. # 1220-21-810-077

R.P.T.T. \$ 994.50

ESCROW NO. 040101461

RECORDING REQUESTED BY:  
**STEWART TITLE COMPANY**

MAIL TAX STATEMENTS TO:  
**SAME AS BELOW**

WHEN RECORDED MAIL TO:  
**GRANTEE**  
**661 BLUEROCK ROAD**  
**GARDNERVILLE, NV 89460**

REQUESTED BY  
**Stewart Title of Douglas County**

IN OFFICIAL RECORDS OF  
DOUGLAS CO., NEVADA

2004 MAY 28 AM 11:21

WERNER CHRISTEN  
RECORDER

\$15<sup>00</sup> PAID K2 DEPUTY

(Space Above for Recorder's Use Only)

### GRANT, BARGAIN, SALE DEED

THIS INDENTURE WITNESSETH: That **WAYNE HENNEFER AND PAULA HENNEFER,**  
**HUSBAND AND WIFE**

in consideration of \$10.00, the receipt of which is hereby acknowledged, does hereby Grant, Bargain Sell  
and Convey to **DOROTHY C. SMITH**, an unmarried woman

and to the heirs and assigns of such Grantee forever, all that real property situated in the  
County of **Douglas** State of Nevada, bounded and described as:

**SEE EXHIBIT "A" ATTACHED HERETO AND MADE A PART HEREOF**

Together with all and singular the tenements, hereditaments and appurtenances thereunto belonging or in  
anywise appertaining, and any reversions, remainders, rents, issues or profits thereof.

DATE: **May 13, 2004**

Wayne Hennefer  
**WAYNE HENNEFER**

Paula Hennefer  
**PAULA HENNEFER**

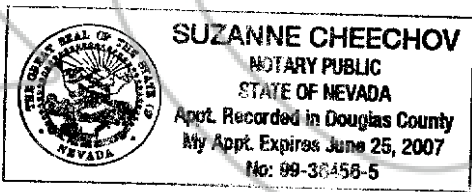

STATE OF NV }  
COUNTY OF Douglas } ss.

This instrument was acknowledged before me on 5/26/04  
by WAYNE HENNEFER and PAULA HENNEFER

Signature [Signature]  
Notary Public (One inch margin on all sides of document for Recorder's Use Only)

0614581

BK0504PG14634

**EXHIBIT "A"**

**LEGAL DESCRIPTION**

ESCROW NO.: 040101461

The land referred to herein is situated in the  
State of Nevada, County of Douglas  
City of GARDNERVILLE described as follows:

Lot 195, as shown on the map of GARDNERVILLE RANCHOS UNIT  
NO. 7, filed for record in the office of the County  
Recorder of Douglas County, Nevada, on March 27, 1974, as  
Document No. 72456.

Assessors Parcel No. 1220-21-810-077

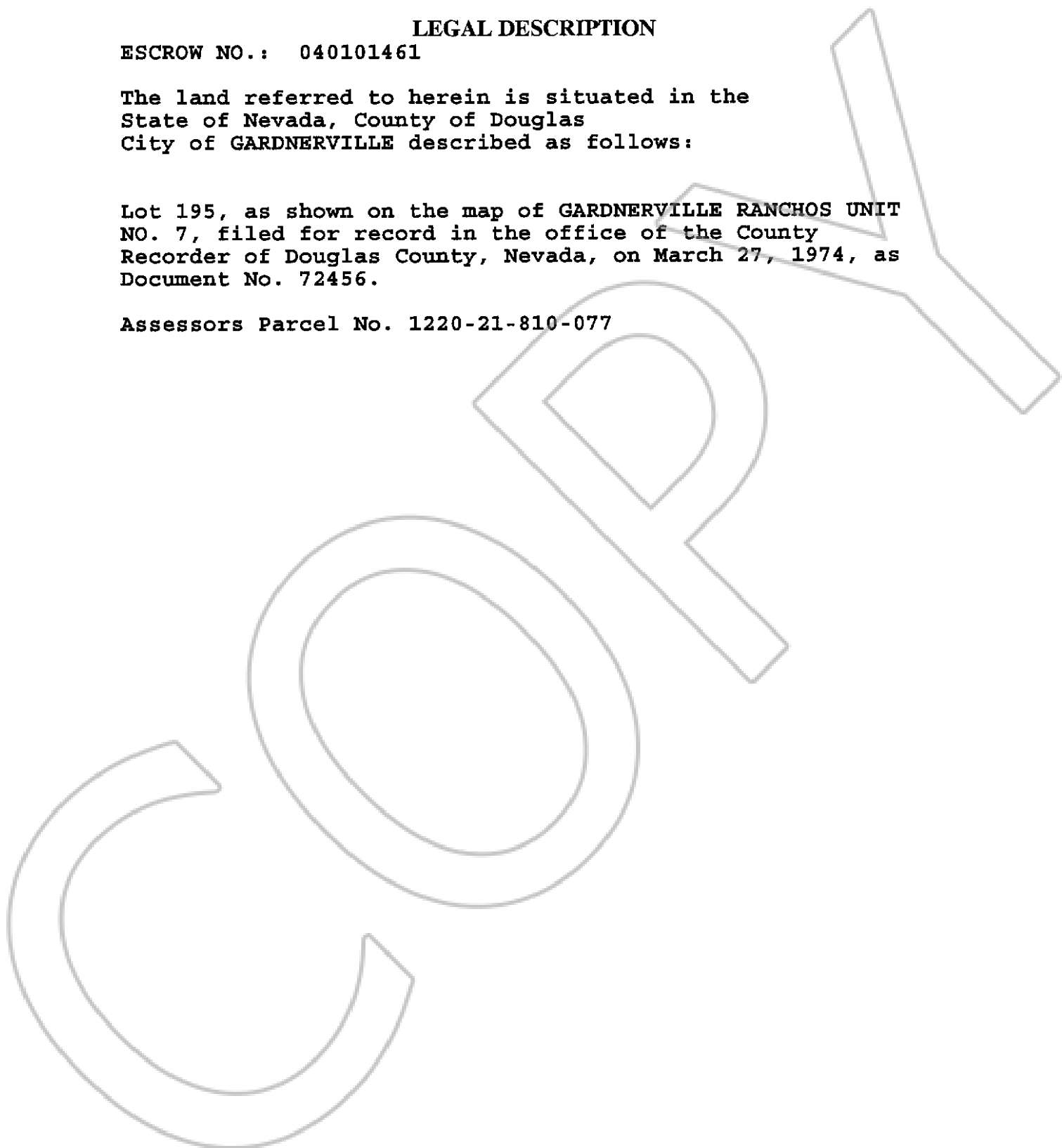

0614581

BK0504PG14635