

A.P.N. # 1220-16-610-058

R.P.T.T. \$ 936.00

ESCROW NO. 040101266

RECORDING REQUESTED BY:  
**STEWART TITLE COMPANY**

MAIL TAX STATEMENTS TO:  
**SAME AS BELOW**

WHEN RECORDED MAIL TO:  
**GRANTEE**  
**1307 JOBS PEAK DRIVE**  
**GARDNERVILLE, NV 89400**

REQUESTED BY  
**Stewart Title of Douglas County**  
IN OFFICIAL RECORDS OF  
DOUGLAS CO., NEVADA

2004 MAY 28 PM 2:49

WERNER CHRISTEN  
RECORDER

\$15.00 PAID *Kj* DEPUTY

(Space Above for Recorder's Use Only)

### GRANT, BARGAIN, SALE DEED

THIS INDENTURE WITNESSETH: That **SARA A. CINCIALA, A SINGLE WOMAN**

in consideration of \$10.00, the receipt of which is hereby acknowledged, does hereby Grant, Bargain Sell and Convey to **SUSAN CUNNINGHAM, AN UNMARRIED WOMAN**

and to the heirs and assigns of such Grantee forever, all that real property situated in the County of **Douglas** State of Nevada, bounded and described as:

**SEE EXHIBIT "A" ATTACHED HERETO AND MADE A PART HEREOF**

Together with all and singular the tenements, hereditaments and appurtenances thereunto belonging or in anywise appertaining, and any reversions, remainders, rents, issues or profits thereof.

DATE: **May 05, 2004**

*Sara A. Cinciala*  
**SARA A. CINCIALA**

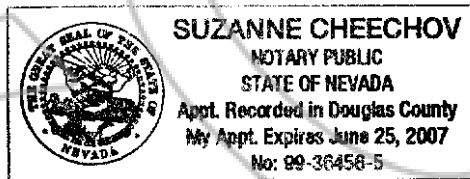

STATE OF W }  
COUNTY OF Douglas } ss.

This instrument was acknowledged before me on 5/24/04  
by SARA A. CINCIALA

Signature *Suzanne Cheechov*  
Notary Public (One inch margin on all sides of document for Recorder's Use Only)

0614659  
BK0504PG15216

**EXHIBIT "A"**

**LEGAL DESCRIPTION**

ESCROW NO.: 040101266

The land referred to herein is situated in the  
State of Nevada, County of Douglas  
City of GARDNERVILLE described as follows:

Lot 187, as said lot is shown on the Official Plat of  
GARDNERVILLE RANCHOS UNIT NO. 2, filed in the office of the  
County Recorder of Douglas County, Nevada, on June 1, 1965,  
in Book 1 of Maps, filed as No. 28309, and Title Sheet  
amended on June 4, 1965, as Filing No. 28377.

Assessor's Parcel No. 1220-16-610-058

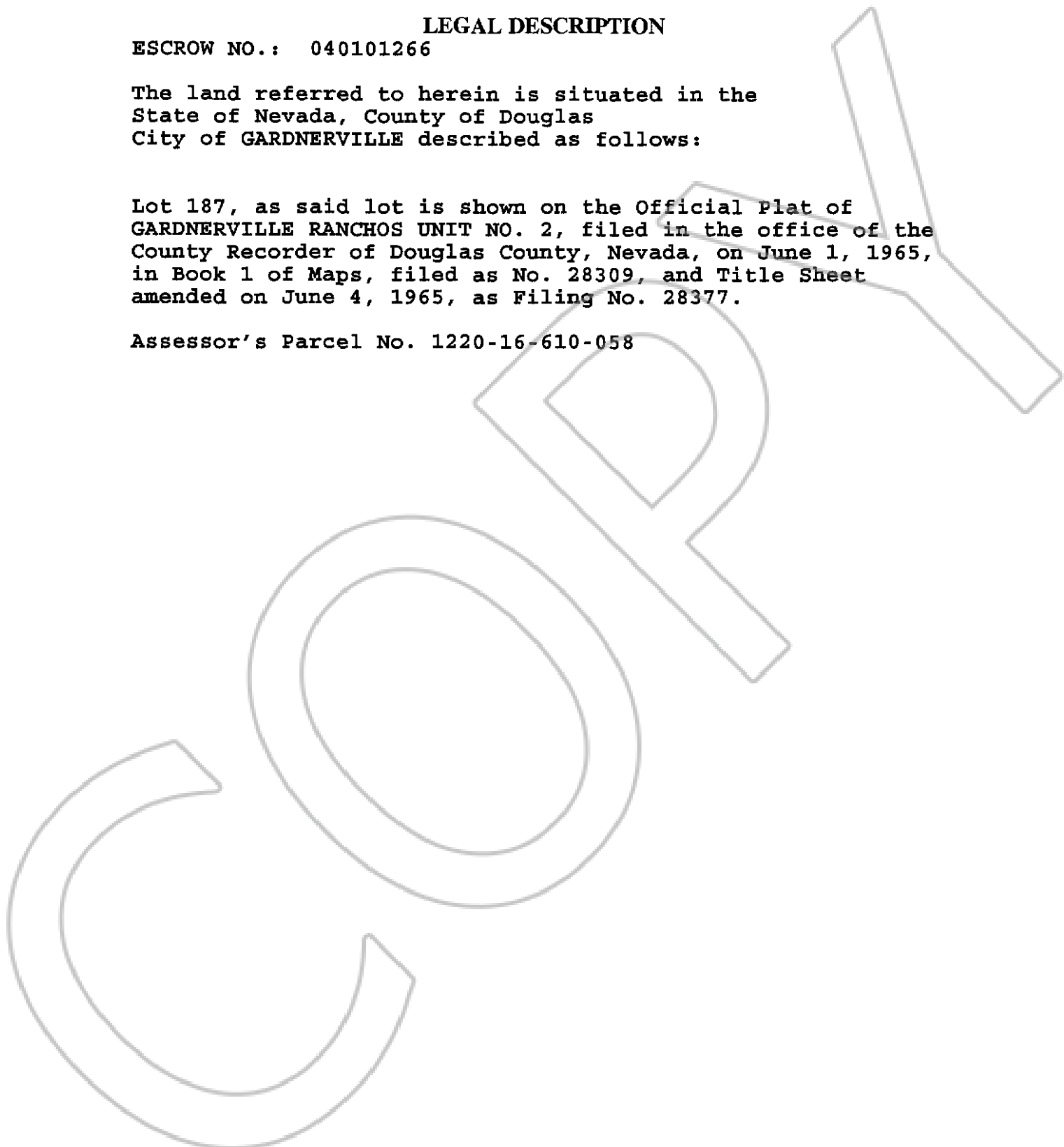

0614659  
BK0504PG15217