

REQUESTED BY
Stewart Title of Douglas County
IN OFFICIAL RECORDS OF
DOUGLAS CO., NEVADA

2004 JUN -3 AM 10:42

WERNER CHRISTEN
RECORDER

\$ 16.00 PAID *Kj* DEPUTY

Recording Requested By:

PCB Service Corporation
Attn: Loan Services c/o Marilyn Best
PO Box 60654
Santa Barbara, CA 93160-0654

When Recorded Mail Document To:

Syncon Homes, a Nevada Corp.
2221 Meridian Blvd., Suite A
Minden, NV 89423-0000

Escrow/Title No: 030304058
Loan No: 00000246210000026181

APN:

- SPACE ABOVE THIS LINE FOR RECORDER'S USE -

Partial Reconveyance

PCB Service Corporation, formerly known as Pacific Capital Commercial Mortgage, Inc., Trustee under Deed of Trust, executed on the 1st day of July, 2001, by See Attached Exhibit "B" as Trustor(s); and recorded on the 2nd day of August, 2001 as Instrument/Document No. 0519849 in Book/Reel 0801 at Page/Image 0612-0623, Official Records in the office of the County Recorder of Douglas County, Nevada, together with all subsequent Renewals, Modifications, Extensions and Addendums;

having been requested in writing, by the holder of the obligation secured by said deed of trust, to reconvey the estate granted to Trustee under said Deed of Trust, in and to herein described property, hereby reconveys, without warranty, to the person or persons legally entitled thereof, all estate now held by it thereunder in and to that property situated in Douglas County, State of Nevada described as follows:

2679 Skyline Dr

Date of this Instrument: May 18, 2004

PCB Service Corporation, formerly known as Pacific Capital Commercial Mortgage, Inc.

State of California)
County of Santa Barbara)



Robin Whatley, Loan Servicing Manager

On this ¹⁹18th day of May 2004, before me, Tueying Lo, Notary Public, personally appeared Robin Whatley personally known to me (or proved to me on the basis of satisfactory evidence) to be the person(s) whose name(s) is/are subscribed to the within instrument and acknowledged to me that he/she/they executed the same in his/her/their authorized capacity(ies), and that by his/her/their signature(s) on the instrument the person(s), or the entity upon behalf of which the person(s) acted, executed the instrument.

WITNESS my hand and official seal.

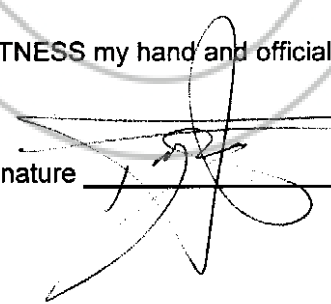
Signature _____

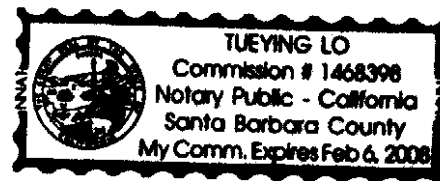



(Seal)

0615039

BK0604PG01333

ATTACHED TO PARTIAL RECONVEYANCE
Syncon Homes, a Nevada Corporation
Loan No. 24621-26181

EXHIBIT "A"

The land referred to herein is situated in the State of Nevada, County of Douglas, City of Minden described as follows:

Lot 62 in Block E as set forth on the Final Subdivision Map FSM #94-04-01 for SKYLINE RANCH PHASE I filed for record with the Douglas County Recorder on May 11, 2001 in Book 0501, of Official Records, Page 3298 as Document No. 514006.

A.P.N. 1420-35-310-031

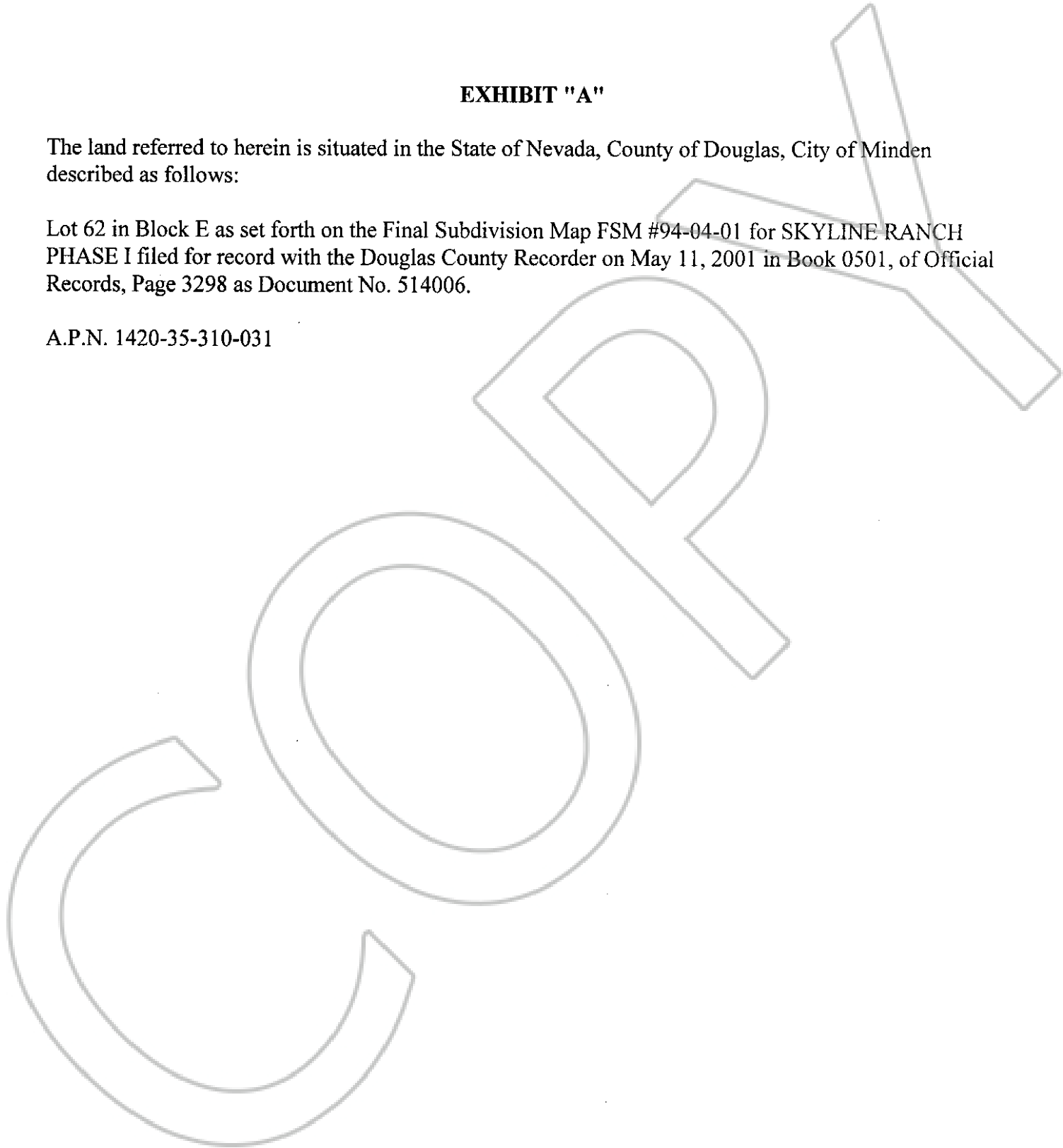

0615039

BK0604PG01334

Attached to Partial Reconveyance
For Romulus Development & Syncon Homes
Loan No. 2462100026181

EXHIBIT 'B'

Romulus Development, LLC, a Nevada Corporation Limited Liability Company, as to Lots 1-12, inclusive, Block A; Lots 13-24, inclusive, in Block B; and Lots 56-65, inclusive, in Block E and Syncon Homes, a Nevada Corporation, as to Lots 19 and 20, in Block B; Lots 25-35, inclusive, in Block C; Lots 36-52, inclusive in Block D; and Lots 53-56, inclusive, in Block E , Trustor,

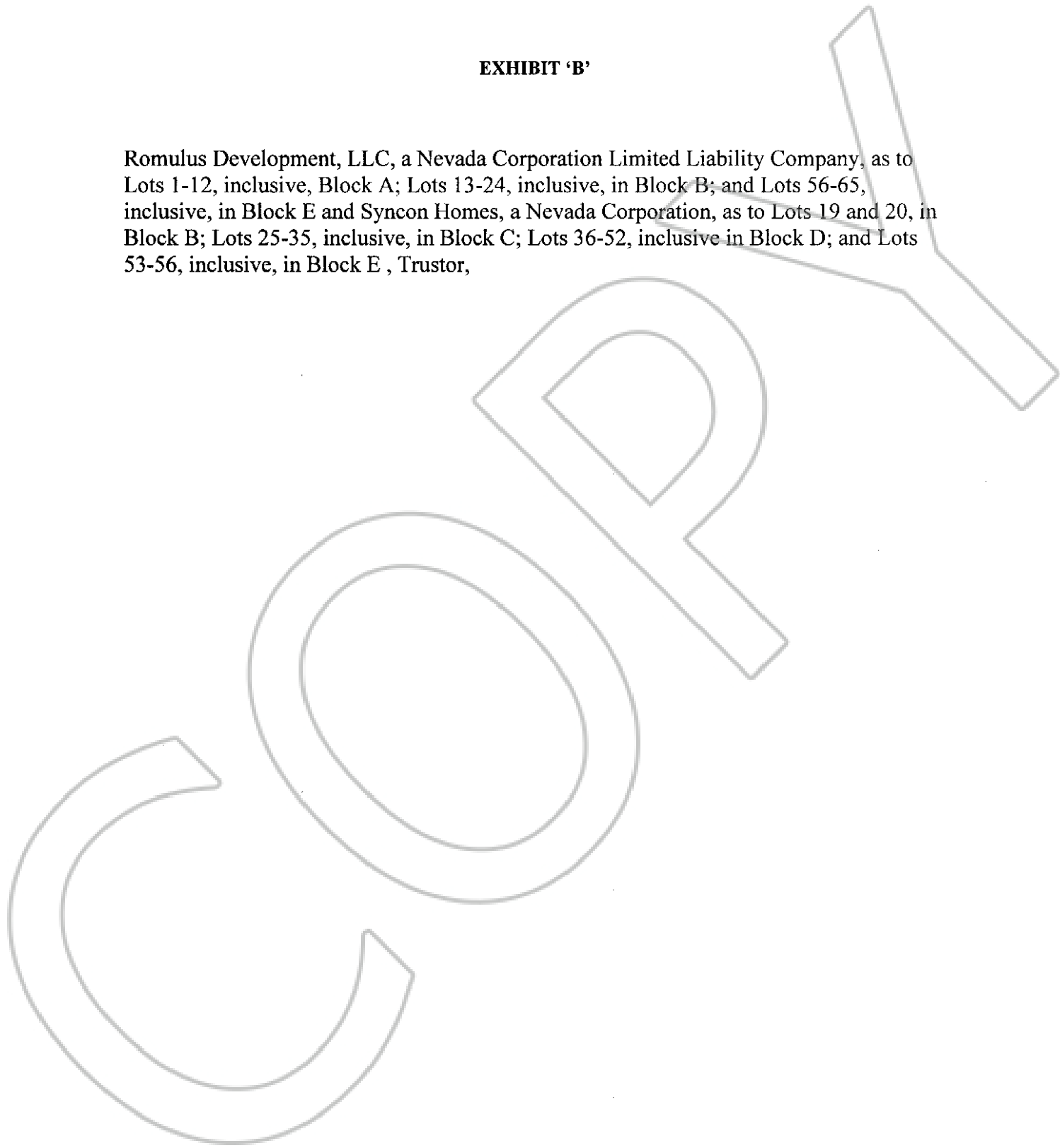

0615039

BK0604PG01335