

RECORDING REQUESTED BY

AND WHEN RECORDED MAIL THIS DEED AND, UNLESS OTHERWISE SHOWN BELOS, MAIL TAX STATEMENTS TO:

REQUESTED BY
WESTERN TITLE COMPANY, INC.
IN OFFICIAL RECORDS OF
DOUGLAS CO., NEVADA

Name THOMAS GILLENWATER
Street Address 735 INDIAN TRAIL ROAD
City & State GARDNERVILLE, NEVADA
Zip _____
Title Order No. 89939-99 Escrow No. _____

2004 JUN -4 AM 11:31

WERNER CHRISTEN
RECORDER

\$15.00 PAID KJ DEPUTY

A.P. NO. 1219-23-001-027

Grant Deed

SPACE ABOVE THIS LINE FOR RECORDER'S USE

This form furnished by United Title Company

The undersigned grantor(s) declare(s):

Documentary transfer tax is \$ 0 #5

- computed on full value of property conveyed, or
- computed on full value of liens and encumbrances remaining at time of sale.
- Unincorporated area: city of _____, and _____

FOR A VALUABLE CONSIDERATION, receipt of which is hereby acknowledged,

THOMAS H. GILLENWATER AND LINDA P. THURRELL, HUSBAND AND WIFE

herby GRANT(S) to

THOMAS GILLENWATER, A MARRIED MAN, AS HIS SOLE AND SEPARATE PROPERTY

The following described real property in the County of **DOUGLAS**, State of Nevada:

Dated May 27, 2004
STATE OF CALIFORNIA }
COUNTY OF ORANGE } SS.

On May 27, 2004 Before me, the undersigned,
a Notary Public in and for said State, personally appeared
Thomas H. Gillenwater and Linda P. Thurrell

THOMAS H. GILLENWATER

LINDA P. THURRELL

Personally known to me (or proved to me on the basis of satisfactory evidence) to be the person(s) whose name(s) is/are subscribed to the within instrument and acknowledged to me that he/she/they executed the same in his/her/their authorized capacity(ies), and that they by his/hers/their signature(s) on the instrument the person(s), or the entity upon behalf of which the person(s) acted, executed the instrument.

WITNESS my hand and official seal.
Signature ANA LUCIA LOVECKY



MAIL TAX STATEMENTS TO PARTY SHOWN ON FOLLOWING LINE: IF NO PARTY SO SHOWN, MAIL AS DIRECTED ABOVE.

Name	Street Address	City and State

0615199

BK0604PG02210

Legal Description

All that real property situate in the County of Douglas, State of Nevada, described as follows:

Lot 7, in Block A, as shown on Amended Map of Lots 4 through 13 of INDIAN ROAD RANCH ESTATES, according to the map thereof, filed in the office of the County Recorder of Douglas County, State of Nevada, on January 27, 1978, in Book 178, Page 1660, as Document No. 17107.

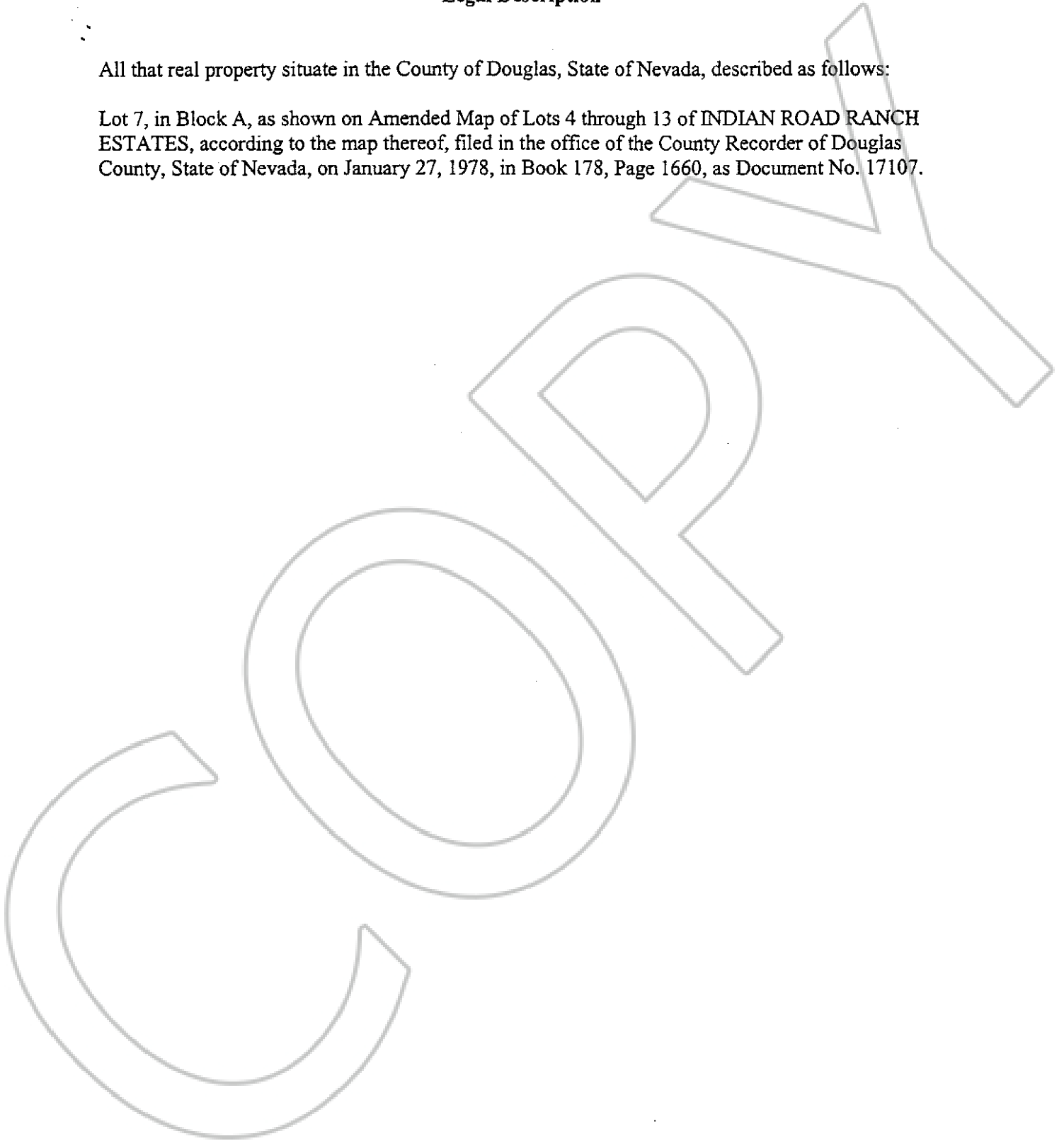

0615199

BK 0604 PG 02211