

EXHIBIT "A"

LEGAL DESCRIPTION

ESCROW NO.: 040801118

**The land referred to herein is situated in the
State of Nevada, County of Douglas
City of MINDEN described as follows:**

**Lot 3, Block 1, as shown on the Map of the ARTEMISIA
RE-SUBDIVISION, filed in the office of the County Recorder
April 23, 1962, as Document No. 19909, Official Records of
Douglas County, State of Nevada.**

Assessor's Parcel No. 1420-34-310-003.

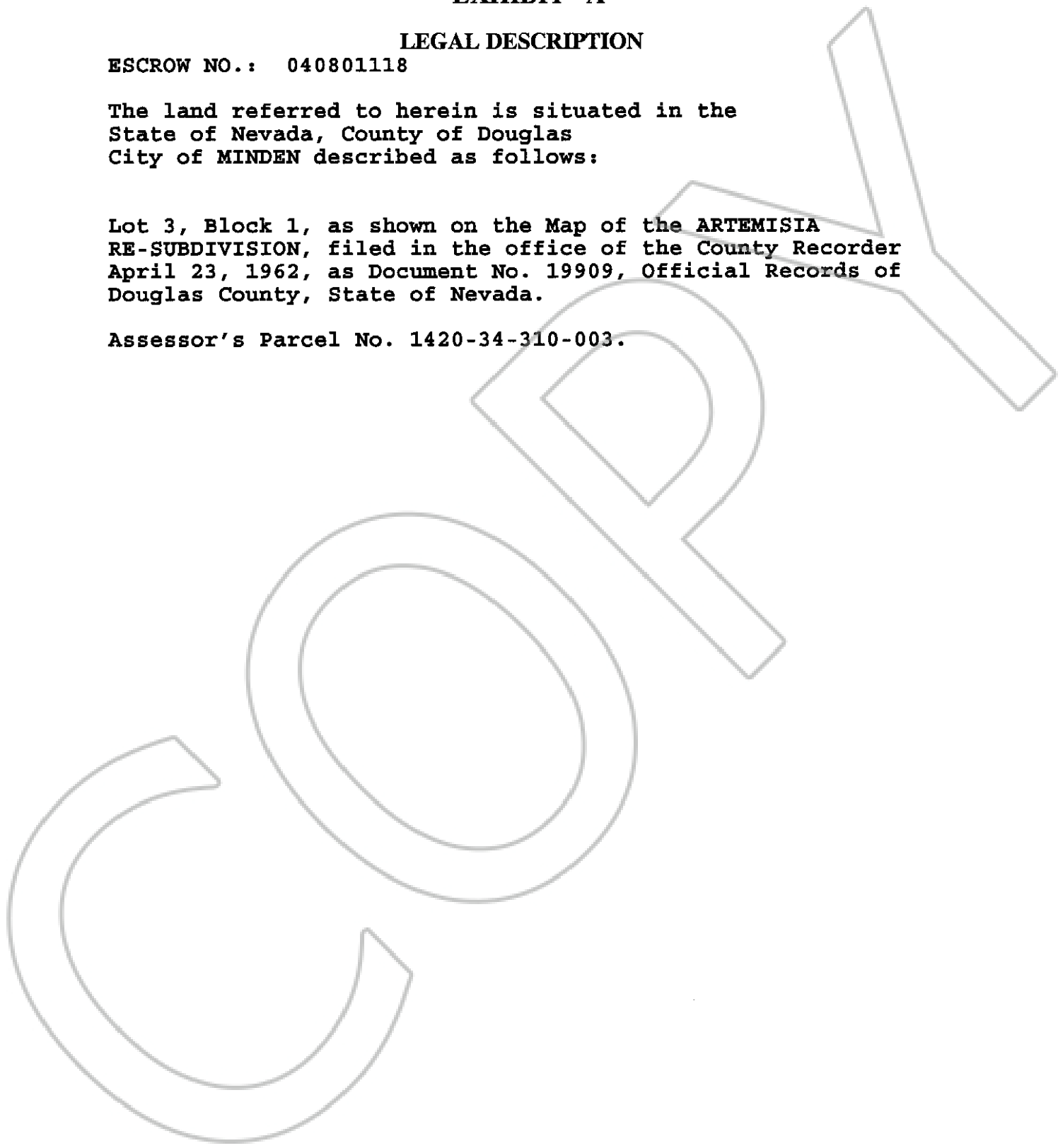

0615611

BK0604PG04697