

18-

Parcel Number: 37-471-16  
LOAN NO.: 0000995795  
Return to: Household Mortgage Services  
577 Lamont Road, Elmhurst, IL 60126  
Prepared by: Latonya Kelly

REQUESTED BY  
*Household Bank*  
IN OFFICIAL RECORDS OF  
DOUGLAS CO., NEVADA

2004 JUN 11 AM 9:51

WERNER CHRISTEN  
RECORDER

\$18<sup>00</sup> PAID *KJ* DEPUTY

STATE OF NEVADA  
SUBSTITUTION OF TRUSTEE  
AND FULL RECONVEYANCE

WHEREAS,  
Original Trustor is:  
JENNIFER FRENCH  
Original Trustee is:  
BENEFICIAL MANAGEMENT CORPORATION OF AMERICA  
Recorded in DOUGLAS County, Nevada as  
Document No. 0427285, in Volume N/A, Page N/A, Deed of Trust Date 11/25/1997

LEGAL DESCRIPTION - SEE ATTACHED

WHEREAS, the undersigned Beneficiary desires to substitute a new Trustee under said Deed of Trust in place and stead of BENEFICIAL MORTGAGE CO OF NEVADA.

Now, therefore, the undersigned hereby substitutes itself as Trustee under said Deed of Trust and does hereby reconvey, without warranty, to the person or persons legally entitled thereto, the Estate now held by it thereunder.

Dated: June 3, 2004

MORTGAGE ELECTRONIC REGISTRATION SYSTEMS, INC. a United States Corporation

*[Signature]*  
\_\_\_\_\_  
Latonya Kelly, Vice President

MERS#: 100046000009957956  
PH#: 1-888-679-6377

State of Illinois  
County of Dupage

SEAL

On June 3, 2004 before me, the undersigned, a Notary Public in and for said State, personally appeared Latonya Kelly, personally known to me or proven to me on the basis of satisfactory evidence to be the Vice President of MORTGAGE ELECTRONIC REGISTRATION SYSTEMS, INC., a United States Corporation, executed the within instrument pursuant to its bylaws or a resolution of its Board of Directors.

In witness whereof, I have hereunto set my hand and affixed my notarial seal this

*[Signature]*  
\_\_\_\_\_  
Notary Public/Commission Expires:

Please mail tax statement to:

JENNIFER FRENCH  
3904 WALKERVIEW  
WELLINGTON, NV 89444

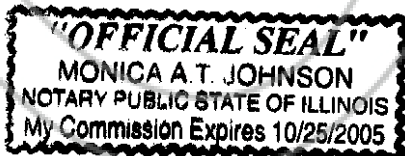

0615829

BK0604PG05547

and described as: ALL THAT CERTAIN LOT, PIECE OR PARCEL OF LAND SITUATE IN THE COUNTY OF DOUGLAS, STATE OF NEVADA, DESCRIBED AS FOLLOWS: LOT 17, IN BLOCK B, AS SHOWN ON THE MAP OF TOPAZ RANCH ESTATES UNIT NO. 4, FILED IN THE OFFICE OF THE COUNTY RECORDER OF DOUGLAS COUNTY, NEVADA, ON NOVEMBER 26, 1970, IN BOOK 81, AT PAGE 214, AS DOCUMENT NO. 50212.

AP #: 37-471-16

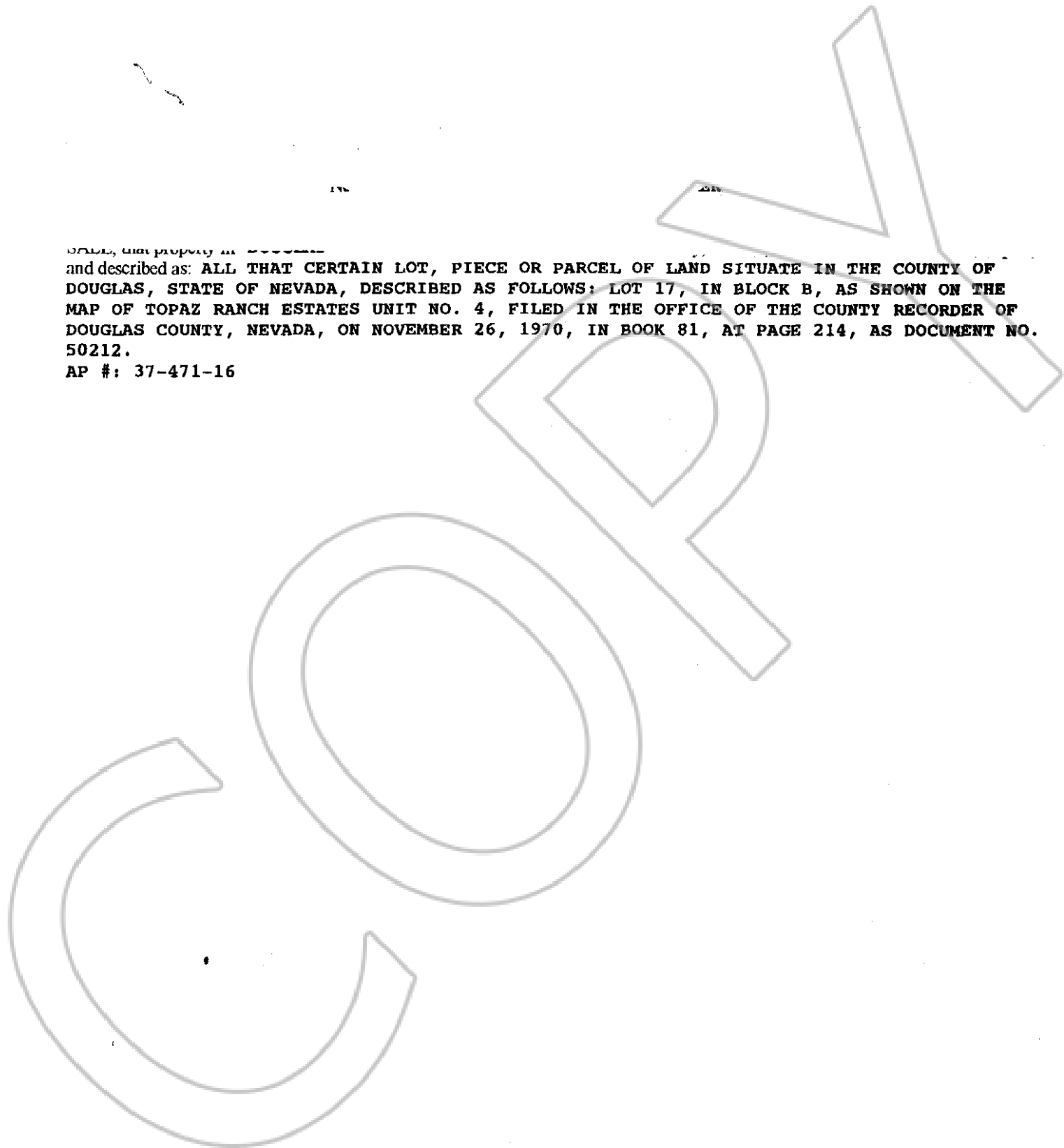

0615829  
BK0604PG05548